

Aluminum Extrusions with Built-in Joints

Feature: Screw joint installable without alterations. (Wrench holes are necessary on the mating extrusion.)

Screw Joint Type

RoHS 10



JFSC - - - - L
(Left End Face Screw Joint Pre-Inserted Type)

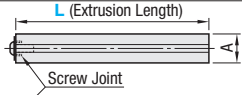

JFSC - - - - W
(Double End Face Screw Joints Pre-Inserted Type)

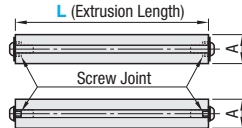

Part Name		Material	Surface Treatment
Nuts are pre-inserted in the aluminum extrusion.		AGN01SS-T5	Anodize
Screw Joints	Screw	SCM435	Trivalent Chromate
	Joint Plate	SPCC	

Wrench holes are necessary on the mating extrusion.
JFSC6-3030L

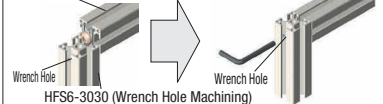

Example
(Ex.) Blue = JFSC5-2020W-Length
Green = JFSC5-2020L-Length-RCH-RCV
Yellow = HFS5-2020L-Length-LCP-RCP
(Wrench Hole Machining P683)

Part Number	Joint Component	L 0.5mm Increment	Extrusion	Built-in Joint Component	Quantity	A	Wrench required when tightening.
JFSC	5-2020 (Left End Face only) W (Double End Faces)	100~4000	HFS5-2020 (P511)	HCJ5 (P662)	1	20	For M5
				2			
	6-3030 (Left End Face only) W (Double End Faces)		HFS6-3030 (P545)	HCJ6 (P662)	1	30	For M8
				2			
	8-4040 (Left End Face only) W (Double End Faces)		HFS8-4040 (P587)	HCJ8 (P662)	1	40	For M12
					2		
	8-4545 (Left End Face only) W (Double End Faces)		HFS8-4545 (P625)	HCJ8-45 (P662)	1	45	
					2		
	8-6060 (Left End Face only) W (Double End Faces)		HFS8-6060 (P633)	HCJ8-60 (P662)	1	60	
					2		



Ordering Example

Part Number - L
JFSC8-4040L - 1200

Feature: Center joint installable without alterations. (No holes are required on the mating extrusion.)

Center Joint

RoHS 10



JFSM - - - - L
(Left End Face Center Joint Pre-Inserted Type)

JFSM - - - - W
(Double End Face Center Joints Pre-Inserted Type)

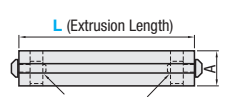
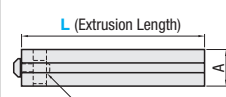

Part Name		Material	Surface Treatment
Nuts are pre-inserted in the aluminum extrusion.		AGN01SS-T5	Anodize
Center Joint	Center Post	SCS13	
	Joint Guide	SUS304	
	Set Screw	SCM435	Black Oxide Film

Joint components will be shipped loosely tightened.



Example

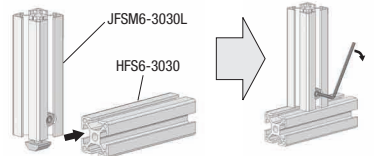

Part Number	Joint Component	L 0.5mm Increment	Extrusion	Built-in Joint Component	Quantity	A	Wrench required when tightening.
JFSM	5-2020 (Left End Face only) W (Double End Faces)	100~4000	HFS5-2020 (P511)	HMJ5 (P663)	1	20	For M4
				2			
	6-3030 (Left End Face only) W (Double End Faces)		HFS6-3030 (P545)	HMJ6 (P663)	1	30	For M6
				2			
	8-4040 (Left End Face only) W (Double End Faces)		HFS8-4040 (P587)	HMJ8 (P663)	1	40	
					2		
	8-4545 (Left End Face only) W (Double End Faces)		HFS8-4545 (P625)	HMJ8-45 (P663)	1	45	
					2		



Ordering Example

Part Number - L
JFSM8-4040L - 1200

Feature: Simple joint installable without alterations. (No holes are required on the mating extrusion.)

Simple Joint Type

RoHS 10

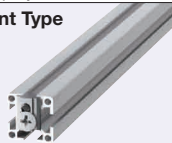

JFSU6-3030L
(Left End Face Simple Joint Pre-Inserted Type)

JFSU6-3030W
(Double End Face Simple Joints Pre-Inserted Type)

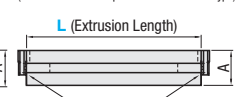
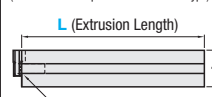

Part Name		Material	Surface Treatment
Nuts are pre-inserted in the aluminum extrusion.		AGN01SS-T5	Anodize
Simple Joint Joints	Main Body	S45C	Trivalent Chromate
	Dedicated Screws	SCM435	
	Set Screw		Black Oxide Film

Joint components will be shipped loosely tightened.



Example

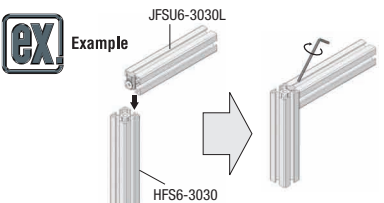

Part Number	Joint Component	L 0.5mm Increment	Extrusion	Built-in Joint Component	Quantity	A
JFSU	6-3030 (Left End Face only) W (Double End Faces)	100~4000	HFS6-3030 (P545)	HJJ6 (P667)	1	30
					2	



Ordering Example

Part Number - L
JFSU6-3030L - 1200