

Hex Socket Head Cap Screws with Captured Washer

Standard, Material: SUS316L



RoHS10

Reference Value Tensile Failure Load

M	(N)
3	3,400
4	6,900
5	12,100
6	15,500
8	32,200

⚠ The above data are not guaranteed.

MxPitch	A	E	B	C	D	t	(a) Max	Through Hole (d)
3x0.5	5.5	3	2.5	5.5	7	0.5	3	1.2
4x0.7	7	4	3	7	9	0.8	4.4	1.5
5x0.8	8.5	5	4	8.5	10	1.0	5.4	1.5
6x1.0	10	6	5	11.5	12.5	1.5	6.9	2.0
8x1.25	13	8	6	14.5	17	1.5	8.4	

SSCBS

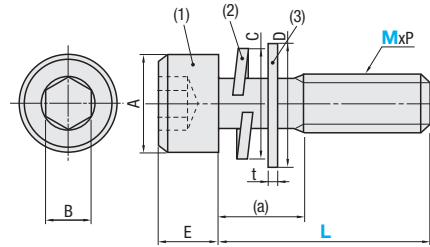

SSCBAS

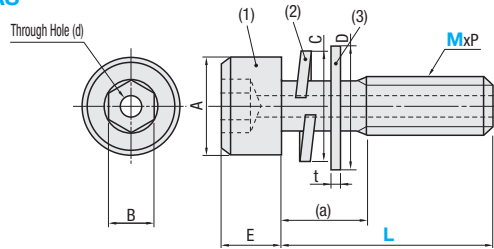

Component	Material	Base Material Strength Class
(1) Screw	SUS316L	A4-70
(2) Spring Washer	SUS316L	-
(3) Flat Washer	SUS316L	-

⚠ For M5, M6 or M8 Screw, "316L" is engraved on head.

⚠ For M3, M4 Screw, only "*" mark is engraved.

Part Number		SSCBS					SSCBAS				
		Unit Price	Volume Discount Rate				Unit Price	Volume Discount Rate			
Type	M-L	1 ~ 9 pc(s).	10 ~ 29 pcs.	30 ~ 49 pcs.	50 ~ 99 pcs.	100-1000 pcs.	1 ~ 9 pc(s).	10 ~ 29 pcs.	30 ~ 49 pcs.	50 ~ 99 pcs.	100-1000 pcs.
SSCBS Standard	3- 6										
	8										
	10										
	12										
	16										
SSCBAS With Through Hole	4- 8										
	10										
	12										
	16										
	20										
SSCBAS With Through Hole	5- 10										
	12										
	16										
	20										
	SSCBAS With Through Hole	6- 10									
12											
16											
20											
25											
SSCBAS With Through Hole	30										
	60										
	SSCBAS With Through Hole	8- 15									
20											
25											
SSCBAS With Through Hole	30										

Ordering Example	Part Number		
	Type	M	L
	SSCBS	4-	16
	SSCBAS	6-	60