

Hinge Bases

H Compact

■ **Features:** Compact in Height and Space-Saving Design.

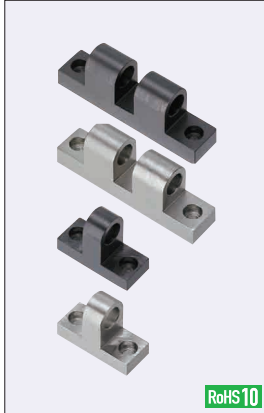

RoHS10

U-Shaped		T-Shaped		Material	Surface Treatment
W Fixed	W and H Configurable	W Fixed	W and H Configurable		
HKHJB	HGHJB	HKHJB	HGHJB	S45C	Black Oxide
HKHJM	HGHJM	HKHJM	HGHJM	Equivalent	Electroless Nickel Plating
HKHJS	-	HKHHS	-	SUS304	-

25 / (√6.3 / √1.6)

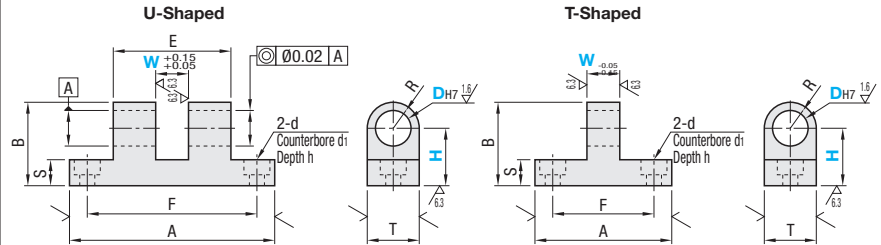

U-Shaped

Part Number	Type	DH7	W		H	A	F	B (H+R)	E	S	T	R (T/2)	d1	d	h	Unit Price				
			Standard	1mm Increment												1mm Increment	W Fixed		W and H Configurable	
																HKHJB	HKHJM	HKHJS	HGHJB	HGHJM
W Fixed HKHJB HKHJM HKHJS	3	6	3~8	12~20	32	24	H+4.5	14	5.5	9	4.5	6.5	3.5	3.5						
	4	8	4~12	16~25	38	30	H+6	20	7.5	12	6	8	4.5	4.5						
	5		5~15	20~30	50	40	H+8	25												
	6		6~14	20~35	75	62	H+9.5	43	9.5	19	9.5	9.5	5.5	5.5						
	8	10	8~24	21~35	65	52	H+12.5	38												
	10		10~23	26~40																
W and H Configurable HGHJB HGHJM	12	12	12~23	29~40																
	13		13~23	30~45																
	14		14~23																	
	15	16	15~23																	
	16		16~23																	
20	20	20~30			100	84	H+15	65	11.5	30	15	11	6.5	6.5						
25	30	25~35																		

T-Shaped

Part Number	Type	DH7	W		H	A	F	B (H+R)	S	T	R (T/2)	d1	d	h	Unit Price					
			Standard	1mm Increment											1mm Increment	W Fixed		W and H Configurable		
																HKHJB	HKHJM	HKHJS	HGHJB	HGHJM
W Fixed HKHJB HKHJM HKHJS	3	6	3~6	12~20	25	15	H+4.5	5.5	9	4.5	6.5	3.5	3.5							
	4	8	4~8	16~25	32	22	H+6	7.5	12	6	8	4.5	4.5							
	5		5~10	18~30	38	27	H+8	9.5	16	8	9.5	5.5	5.5							
	6		6~12	18~35	50	37	H+9.5	11.5	19	9.5	11.5	6.5	6.5							
	8	10	8~16	21~35																
	10		10~16	24~35																
W and H Configurable HGHJB HGHJM	12	12	12~16	26~40																
	13		13~24	29~40																
	14		14~24	30~45																
	15	16	15~24																	
	16		16~24																	
20	20	20~30			65	49	H+15	11.5	30	15	11	6.5	6.5							
25	30	25~35																		



Ordering Example

Part Number - W - H
 HGHJM16 - W20 - H27
 HKHJB10 - H18

• Comparison when connecting T-Shaped Type and U-Shaped Type

