

# Manual Switching Valves

## Lever Type / Miniature Lever Type

### Lever Type



RoHS10

### MHAN (No Lock Mechanism)

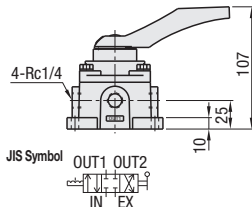
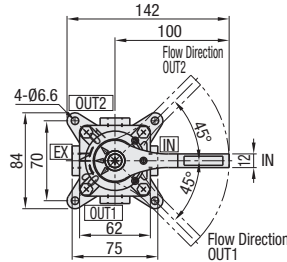

### MHANR (with Lock Mechanism)

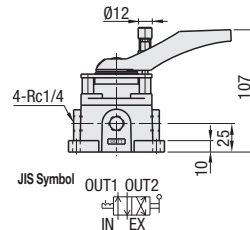
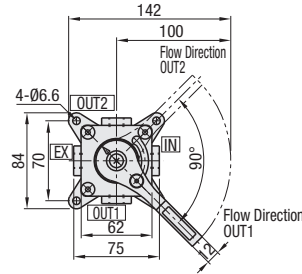

### Features

- MHAN : 3-position type of closed center.
- MHANR : 2 Position Type; Lever is locked at the OUT1 and OUT2 positions. Move the lever by pressing the knob for switching.

### Components

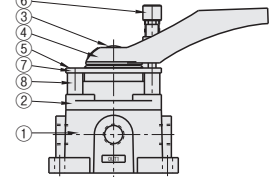

### Component List

Part Number	Name	Quantity	Material
①	Base	1	ADC
②	Cover	1	ADC
③	Small Flat Head Screw	1	SS400
④	Lever	1	ADC
⑤	Bolt	4	SS400
⑥	Hex Socket Flat Head Cap Screw	4	SCM435
⑦	Knob	1	SS400
⑧	Stopper Plate	1	SPC
⑧	Collar	4	C3604B

Part Number Type	Direction No.	Number of Ports	Pipe Connection Bore Dia.			Number of Positions		Effective Sectional Area (mm <sup>2</sup> )	Operating Pressure (MPa)	Operating Temp. Range (°C)	Applicable Fluid	Mass (g)		Unit Price	
			IN	OUT	EX	MHAN	MHANR					MHAN	MHANR	MHAN	MHANR
MHAN MHANR	4	4	Rc1/4	Rc1/4		3	2	20	0~0.7	5~60	Air	800	850		

### Miniature Lever Type



RoHS10

### MHAM

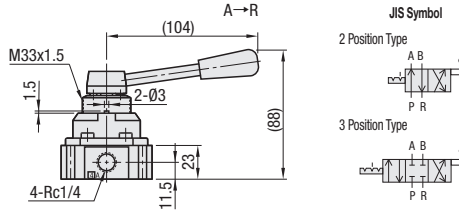
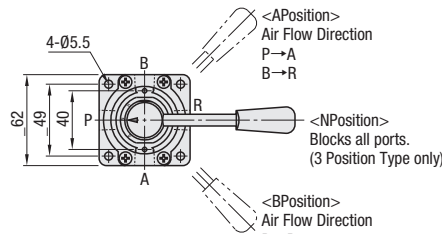

### Features

- Lever Type Switching Valves more space-saving than MHAN.
- 3 Position Type has N position, which blocks all ports and can be used for stopping cylinder (Cannot abruptly stop cylinder due to its residual pressure.).

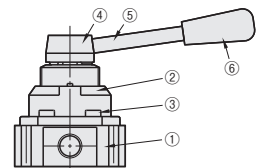

### Component List

Part Number	Name	Material
①	Main Body	ADC
②	Cover	ADC
③	Machine Screw	SS400
④	Handle	ZDC
⑤	Lever	SGD400
⑥	Lever Knob	POM

Part Number Type	P No.	Direction Number of Positions	Number of Ports	Pipe Connection Bore Dia.			Effective Sectional Area (mm <sup>2</sup> )	Operating Pressure (MPa)	Operating Temp. Range (°C)	Applicable Fluid	Mass (g)	Unit Price	
				IN	OUT	EX						MHAM	MHAM
MHAM	4	2 3	4	4	Rc1/4	Rc1/4	7.5	0~1.0MPa	5~60	Air	280		



Ordering Example

Part Number - Number of Positions  
**MHAN4**  
**MHAM4** - **3**