

Compact Parallel Grippers / Sensors

Compact Parallel Grippers



RoHS 10

Without Sensor Slot ACHE

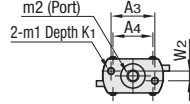

Sensor Mounting Type ACHK

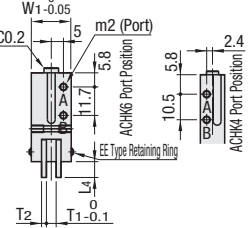
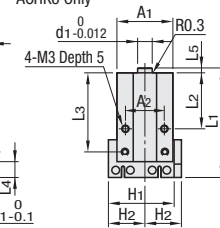
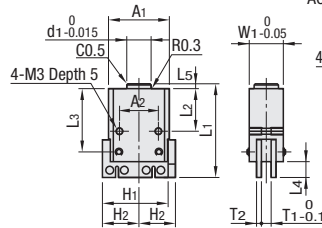
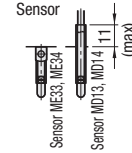
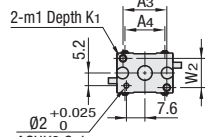

Common Fingers / Attachment Mounting Section

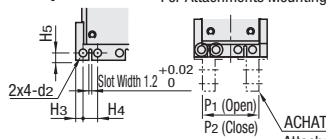

Common EE Type Retaining Ring



⚡ The drawing shows with no air supplied.

For Attachments Mounting

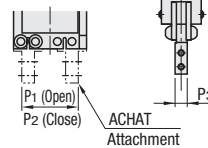

⚡ The drawing shows Single Acting: Without Air
Double Acting: With Air in Port B

Part Name	Material	Surface Treatment
Main Body	A5056	Clear Anodize
Finger / Attachment Mounting Part	S45C	Nitriding Treatment

⚡ For Finger (Attachment) details, see P1502.

Part Number	Stroke	Selection		A1	A2	A3	A4	L1	L2	L3	L4	L5	H1	H2	H3	H4	H5	W1	W2	T1	T2	d1	d2	m1	m2	K1	P1	P2	P3
		Single Acting	Double Acting																										
ACHE	4	N	-	22	12	13.6	14.4	33.5	16.5	22.5	5.5	1.5	24	13	2.5	5	2.5	10	4	3.1	1.5	6	2.2	3	3	6	20	16	4
	6	N	D	25	16	18	16.4	38.5	17.5	26	6.5	2	27	15	3	6	3	14	-	4.1	2	10	3.2	3	5	6	23.2	17.2	5
ACHK	4	N	D	20	12	10	14.4	40.5	23.5	29.5	5.5	1.5	24	13	2.5	5	2.5	10	6	3.1	1.5	5	2.2	2.6	3	4	20	16	4
	6	N	D	23	16	18	16.4	45	23	32.5	6.5	2	27	15	3	6	3	16.4	12	4.1	2	6	3.2	3	3	6	23.2	17.2	5

Part Number	Stroke	Selection		Cylinder I.D.	Effective Gripping Force (N)		Allowable Static Load (N)		Mass (g)	Sensor Slot	Unit Price
		Single Acting	Double Acting		Single Acting - Spring	Double Acting	F1	F2			
ACHE	4	N	-	8	4.2(1)	-	5	2.5	17	No	1 ~ 10 pc(s).
	6	N	D	10	7.2(1.3)	-	10	5	31		
ACHK	4	N	D	8	4.2(1)	4.9	5	2.5	19	Yes	
	6	N	D	12	10.4(1.9)	12.2	10	5	37		

⚡ For the Specifications and Gripping Point Data, see Overview Page P1500
 ⚡ Effective Gripping Force shown with Air Pressure: 0.4MPa and Holding Point: L=20mm.
 ⚡ The Allowable Static Load values are for reference only, not guaranteed.
 ⚡ The directions of the Allowable Static Load are shown in F1 and F2 on the right.

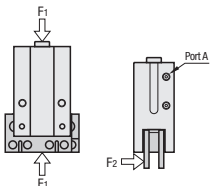

Ordering Example
 Part Number: ACHK4 - N
 Selection: Single / Double Acting

Sensors for Pneumatic Grippers



RoHS 10

MD 11
MD 13
MD 14

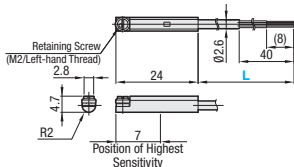

ME 33
ME 34

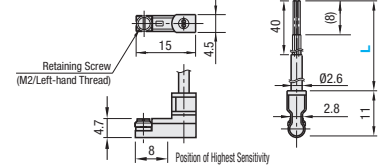

Part Number	Type	L Selection	Load Voltage	Load Current	Indicator Light	Sensor Type	Line	Wire Exit	Unit Price	
									L1 (1m)	L3 (3m)
MD11	L1 (1m)	L3 (3m)	24VDC	DC24V	LED (Lights when ON)	Contact	2-Line	Rear		
MD13			110VAC	AC110V						
MD14			28VDC or Less	0.1~40mA						
ME33			28VDC or Less	0.1~40mA						
ME34			10~28VDC	5~20mA		No Contact	2-Line	Top		

⚡ For detailed specifications of the Sensors, see P1484

⚡ Operating Temp. Range: 0 ~ 60°C

Ordering Example
 Part Number: MD14L1