

# Flat Air Nozzles

## Air-Amplified Standard Type

Air blow videos are now on the web! [MISUMI Nozzles Videos](#) [Search](#) <http://jp.misumi-ec.com/>



RoHS 10

Type	Material	Max. Operating Pressure	Thread Breakdown Torque	Heat Resistance Temp.
AFTAD	PPS Resin	0.7MPa	10N·m	200°C

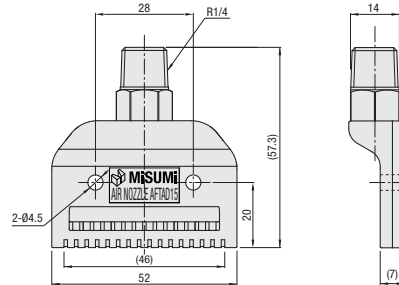

### Features

Air volume and speed out of the orifices are increased by taking surrounding air.  
 High colliding force with less air enables energy saving and air consumption reduction.  
 PPS Resin is used to improved oil and heat resistance.  
 Grooves are provided at the tip of the nozzle to protect the orifice.  
 ⚠ To prevent damage  
 • Avoid excessive tightening of screws.  
 • Avoid shocks to the screws.

Part Number		Orifice	Air Flow Rate NL/Min (for 0.3MPa)	Weight (g)	Unit Price 1 ~ 4 pc(s).	Volume Discount Rate		
Type	No.					5~39	40~99	100~200
AFTAD	15	16-Ø1	270	15				



Part Number  
AFTAD15

⚠ For orders larger than indicated quantity, please check with WOS.



RoHS 10

Type	Material	Max. Operating Pressure	Heat Resistance Temp.
AFTADA	A5052P	0.4MPa	200°C

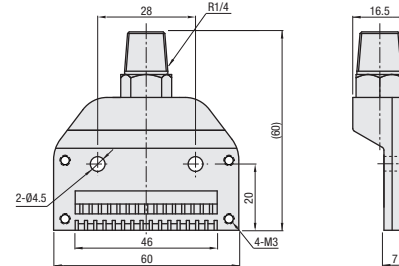

### Features

Air volume and speed out of the orifices are increased by taking surrounding air.  
 High colliding force with less air enables energy saving and air consumption reduction.  
 Grooves are provided at the tip of the nozzle to protect the orifice.  
 ⚠ Do not disassemble the main body.  
 ⚠ For AFTADA, MISUMI logo, Product Name or Part Number is not engraved.

Part Number		Orifice	Air Flow Rate NL/min (for 0.3MPa)	Weight (g)	Unit Price 1 ~ 4 pc(s).	Volume Discount Rate		
Type	No.					5~9	10~19	20~30
AFTADA	15	16-Ø1	270	60				



Part Number  
AFTADA15

⚠ For orders larger than indicated quantity, please check with WOS.

### Air Flow Rate Property Table

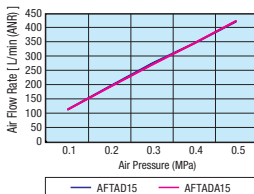

### Quietness Property Table

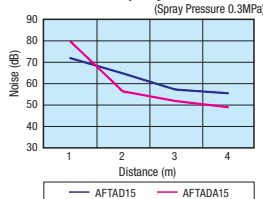

### Velocity Characteristic Table

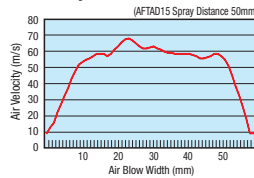

### Air Colliding Force Property Table

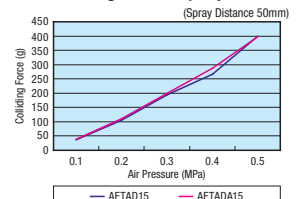

⚠ Listed Flow Rate is Supplied Flow Rate, not Discharged Flow Rate.  
 ⚠ Values on the graph are for reference, not guaranteed.

### Example

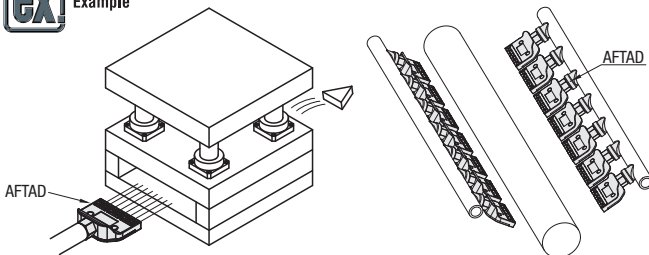

(Transfer of press stamped material)

• Suitable for conveying heavy load due to increased colliding force.

(Drying of Camshaft)

Since its high air efficiency, air volume savings is possible when blowing long objects side by side.

### Air Vector Diagram

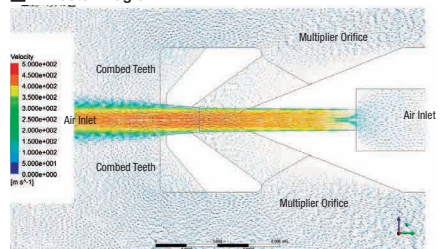

• Air flow volume and velocity are amplified by the air taken in from the combed teeth of the nozzle tip and multiplier orifice.  
 • According to our experimental measured value, Flow Velocity is approximately 1.5 times or more of Standard Type (AFTSP15).