

One-Touch Couplings

Male Connectors - Outlined with Hex

MSCNL



MJCMLS



MSCNL Thread: C3604 (Brass)
: Electroless Nickel Plating
MJCMLS Thread: SUS304

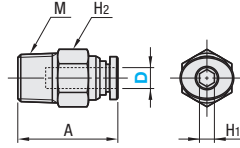

Material: Ring: PBT (Polybutylene Terephthalate)
The drawing is for MSCNL. See the CAD data for MJCMLS.

Male Connectors - Outlined with Circle



MSCNC Thread: C3604 (Brass)
: Electroless Nickel Plating

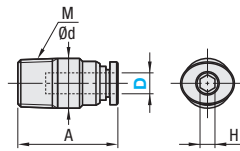

Material: Ring: PBT (Polybutylene Terephthalate)

Female Connectors



MSCNF Thread: C3604 (Brass)
: Electroless Nickel Plating

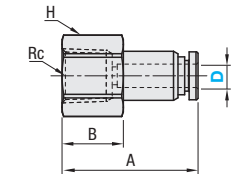

Material: Ring: PBT (Polybutylene Terephthalate)

Female Threaded Bulkhead Unions



MSSB Thread: C3604 (Brass)
: Electroless Nickel Plating

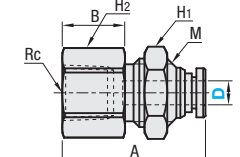

Material: Ring: PBT (Polybutylene Terephthalate)

Male Elbows

MSELL



MJELLS



MSELL Thread: C3604 (Brass)
: Electroless Nickel Plating
MJELLS Thread: SUS304

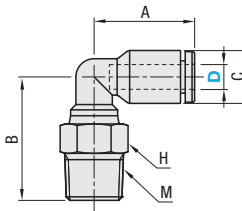

Material: Body: PBT (Polybutylene Terephthalate)
The drawing is for MSELL. See the CAD data for MJELLS.

Part Number Type	Nominal D	A	Hex Socket H ₁	Wrench Flats H ₂	Thread Size M	Effective Sectional Area (mm ²)	Mass (g)	MSCNL		MJCMLS	
								Unit Price 1 - 9 pcs)	Volume Discount Rate 10 - 50	Unit Price 1 - 9 pcs)	Volume Discount Rate 10 - 50
MSCNL MJCMLS	4	M5	20.1(21.5)	2	8(10)	M5x0.8	4.5(6)	-	-	-	-
		1	20.1(20.5)	3	10	R1 / 8	8.6(8)	-	-	-	-
	6	2	20.1(19.5)	3	14	R1 / 4	17.3(15)	-	-	-	-
		M5	21.8(23)	2	11(12)	M5x0.8	3.2(4.4)	8.3(9)	-	-	-
	8	1	22.6(23)	4	17	R1 / 8	9.2(11)	18.2(18)	-	-	-
		2	22.8(23.5)	4	14	R1 / 4	11.5(10.3)	26.4(26)	-	-	-
	10	3	22.8(21.5)	4	17	R3 / 8	18.7(17.5)	13.7(11)	-	-	-
		1	27.7(28)	5	13(14)	R1 / 8	26.9(22.4)	27.3(24)	-	-	-
	12	2	25.7(27)	6	14	R1 / 4	18.5(17.5)	22.2(26)	-	-	-
		3	23.7(22.5)	5	17	R3 / 8	26.9(30.5)	27.6(22)	-	-	-
	14	1	29.4(31)	6	17	R1 / 8	38.9(30.5)	29.3(26)	-	-	-
		2	32.4(32.5)	6	17	R1 / 4	48.5(49)	34.2(37)	-	-	-
	16	3	28.4(28.5)	8	19	R3 / 8	47.9(40)	54.8(51)	-	-	-
		4	27.3(26.5)	8	21(22)	R1 / 2	58.7(60)	58.2(66)	-	-	-

Value in () are for MJCMLS. There is no hex portion (H₁) in the inner circumference.

Part Number Type	Nominal D	A	Hex Socket H	Od	Thread Size M	Effective Sectional Area (mm ²)	Mass (g)	MSCNC		
								Unit Price 1 - 9 pcs)	Volume Discount Rate 10 - 50	
MSCNC	4	M5	20.1	2	8.2	M5x0.8	4.2	-	-	
		1	20.1	3	10	R1 / 8	8	-	-	
	6	M5	21.8	2	11	M5x0.8	7.2	-	-	
		1	22	4	11	R1 / 8	8.6	-	-	
	8	2	22.8	4	13.5	R1 / 4	16.8	-	-	
		1	27.7	5	13	R1 / 8	18.7	-	-	
	10	2	25.7	6	13.5	R1 / 4	15.5	-	-	
		3	23.7	6	17	R3 / 8	26.9	-	-	
	12	1	29.4	5	15.5	R1 / 8	18.5	-	-	
		2	32.4	6	15.5	R1 / 4	26.9	23.3	-	-
	14	3	28.4	8	17	R3 / 8	38.9	25.7	-	-
		4	27.3	8	21	R1 / 2	46.7	46.7	-	-
	16	2	35.4	6	18.8	R1 / 4	26.9	29.7	-	-
		3	31.8	8	18.8	R3 / 8	47.9	30.2	-	-
	4	33.8	8	21	R1 / 2	56.6	56.6	-	-	

Part Number Type	Nominal D	A	B	Wrench Flats H ₁	Wrench Flats H ₂	Thread Size M	Effective Sectional Area (mm ²)	Mass (g)	MSCNF	
									Unit Price 1 - 9 pcs)	Volume Discount Rate 10 - 50
MSCNF	4	1	24.4	11	13	Rc1 / 8	3.2	13.5	-	-
		2	27.4	14	17	Rc1 / 4	24.9	24.9	-	-
	6	1	26.4	11	13	Rc1 / 8	11.0	14.8	-	-
		2	28.4	14	17	Rc1 / 4	27.6	26.1	-	-
	8	3	29.4	15	19	Rc3 / 8	16.4	27.6	-	-
		1	27.7	10	13	Rc1 / 8	25.2	16.4	-	-
	10	2	30.7	14	17	Rc1 / 4	29.2	27.7	-	-
		3	31.7	15	19	Rc3 / 8	30.3	29.2	-	-
	12	2	32.4	13	17	Rc1 / 4	32.5	30.3	-	-
		4	36.4	18	24	Rc1 / 2	45.3	32.5	-	-
	14	2	35.4	12	19	Rc1 / 4	44.6	45.3	-	-
		3	36.4	15	19	Rc3 / 8	60.6	39.4	-	-
	4	39.4	18	24	Rc1 / 2	70.5	60.6	-	-	

Part Number Type	Nominal D	A	B	Wrench Flats H ₁	Wrench Flats H ₂	Thread Size M	Effective Sectional Area (mm ²)	Mass (g)	MSSB	
									Unit Price 1 - 9 pcs)	Volume Discount Rate 10 - 50
MSSB	4	1	25.1	11	14	M12x1.0	3.2	18	-	-
		1	26.3	9	17	M14x1.0	11	26	-	-
	6	2	31.3	14	17	M16x1.0	25.2	30	-	-
		1	28.9	8	19	M18x1.0	38.7	34.5	-	-
	8	2	34.9	14	19	M20x1.0	44.6	42.5	-	-
		3	35.9	15	24	M22x1.0	70.5	36	-	-
	10	2	32.3	13	24	M24x1.0	88.5	58.5	-	-
		3	34.3	15	26	M26x1.0	115.5	55	-	-
	12	3	37.4	14	26	M28x1.0	141.5	71.5	-	-
		4	41.4	18	24	M30x1.0	170.5	70.5	-	-

Part Number Type	Nominal D	Body Color	A	B	C	Wrench Flats H ₁	Thread Size M	Effective Sectional Area (mm ²)	Mass (g)	MSELL		MJELLS	
										Unit Price 1 - 9 pcs)	Volume Discount Rate 10 - 50	Unit Price 1 - 9 pcs)	Volume Discount Rate 10 - 50
MSELL MJELLS	4	M5	17.1(18)	14.6(15)	9(10)	9(8)	M5x0.8	3.2	4.6(5)	-	-	-	-
		1	17.1(18.5)	17.8(20.5)	10	10	R1 / 8	4.4(3.5)	7.9(8)	-	-	-	-
	6	2	17.1(18.5)	20.8(24)	14	14	R1 / 4	8.5(8)	17.1(15)	-	-	-	-
		M5	18(20)	15.7(15)	11(12)	11(12)	M5x0.8	3.2(4.2)	5.4(7)	-	-	-	-
	8	1	18(21)	18.9(24)	14	14	R1 / 8	8.5(8)	8.7(13)	-	-	-	-
		2	18(21)	21.9(28)	17	17	R3 / 8	15(18)	17.8(18)	-	-	-	-
	10	3	18(21)	22.9(30)	17	17	R3 / 8	22.1(24.3)	27.2(26)	-	-	-	-
		1	23.6	20.3(25.5)	10(14)	10(14)	R1 / 8	15(18)	10.4(17)	-	-	-	-
	12	2	23.6	22.8(28.5)	14	14	R1 / 4	20.8(26)	19.1(20)	-	-	-	-
		3	23.6	23.8(30)	17	17	R3 / 8	28.4(28)	28.4(28)	-	-	-	-
	14	1	25(27)	23.6(28)	17	17	R1 / 8	31.5(27)	20.8(26)	-	-	-	-
		2	25(27)	26.6(31)	17	17	R1 / 4	41.7(33)	25.5(28)	-	-	-	-
	16	3	25(27)	26.1(32.5)	17	17	R3 / 8	47.2(49)	27.5(33)	-	-	-	-
		4	32(29.5)	28.5(33)	21(22)	21(22)	R1 / 2	77.8(80)	47.2(49)	-	-	-	-
	18	2	32(29.5)	28.5(33)	19.7	19.7	R1 / 4	42.6(35)	31.1(37)	-	-	-	-
		3	32(29.5)	28.3(34.5)	21(22)	21(22)	R3 / 8	52.8(56)	33.1(43)	-	-	-	-
20	4	32(29.5)	31.3(39.5)	20(22)	20(22)	R1 / 2	52.8(56)	52.8(56)	-	-	-	-	
	3	34(35.5)	36(41)	20(22)	20(22)	R3 / 8	77.8(80)	52.9(63)	-	-	-	-	
22	4	34(35.5)	38.5(44)	21(22)	21(22)	R1 / 2	77.8(80)	67.2(76)	-	-	-	-	

Values in () are for MJELLS. Body color of MSELL is black.

Body color seletypem is available only for MJELLS.



Ordering Example
Part Number - Nominal - Body Color
MSCNL6 - 1 - B
MJELLS8 - 1 - B



Specifications	MJCMLS		MJCMLS Other than MJELLS	
	Compressed Air	Water	Compressed Air	Water
Applicable Fluid	Compressed Air	Water	Compressed Air	Water
Operating Temperature Range	-15~60°C	5~40°C	0~60°C	0~60°C
Max. Operating Pressure	1MPa	1MPa	0.9MPa	0.9MPa
Operating Vacuum Level	-100kPa	-	-100kPa	-

* No Freezing

The entire threaded part C3604 (brass) is plated with electroless nickel. It is also seal-coated and does not need sealant tape (except for M5).