

# Sanitary Pipe Fittings

## Pipe Straps / Gaskets / Clamps / One-Touch Clamps

**■ Pipe Straps**

Type	Material
SNZP	SUS304

RoHS10

Part Number	Type	No.	d	A	B	L1	L2	C	Unit Price	Volume Discount Rate
									Qty. 1 - 9	10-20
SNZP	1S	25.4	60	56	28	30	2			
	1.5S	38.1	81.5	63	39	37.5	5			
	2S	50.8	96.5	76	46	47	3.5			
	2.5S	63.5	111.5	*86	53.5	54.5	3.5			
	3S	76.3	122	*98	58	61	3			

Dimensions marked with \* are B' dimension. For orders larger than indicated quantity, please check with WOS.  
 All widths are 28.

**■ Gaskets**

Type	Material
SNGS	Silicone
SNGSF	PTFE

RoHS10

Part Number	Type	No.	A	d	T	t	SNGS	SNGSF
							Unit Price	Unit Price
SNGSF	8A			10.5			-	-
	10A	34		14	4.9	1.7	-	-
	15A			17.5			-	-
SNGS	1S	50.5		23.2 (23)				
	1.5S			35.9 (35.7)				
	2S	64		48 (47.8)	5.5 (5.0)	2 (1.8)		
	2.5S	77.5		59.7 (59.5)				
	3S	91		72.5 (72.3)				

Dimensions in ( ) are for SNGSF. For orders larger than indicated quantity, please check with WOS.

**■ Clamps - Low Pressure Use**

Type	Material	Recommended Operating Pressure
SNCP	8A-15A 1S-3S	SCS13A SUS304
		8A-2S:0-0.3MPa 2.5S-3S:0-0.2MPa

RoHS10

Part Number	Type	No.	D	A	B	Unit Price	Volume Discount Rate
						Qty. 1 - 9	10-20
SNCP	8A						
	10A	45		65	74		
	15A						
	1S		60	94	90		
	1.5S		75	110	103		
2S		90	130	108			
2.5S		104	144	114			

As the ferrule shape for No.8A - 15A and 1S and 1.5S are identical, the shapes for SNCP8A - 15A and SNCP1S and 1.5s are identical. For orders larger than indicated quantity, please check with WOS.

**■ Clamps - Medium and High Pressure Use**

Type	Material	Recommended Operating Pressure
SNCPH	SCS13A	1S-2S:0-1MPa 2.5S-3S:0-0.5MPa

RoHS10

Part Number	Type	No.	D	A	B	Unit Price	Volume Discount Rate
						Qty. 1 - 9	10-20
SNCPH	1S		65	97	88		
	1.5S						
	2S		79	109	96		
	2.5S		94	128	104		
	3S		107	143	110		

The shapes for SNCPH1S and 1.5S are identical. For orders larger than indicated quantity, please check with WOS.

**■ One-Touch Clamps**

Type	Material	Recommended Operating Pressure
SNCPW	SUS304	0-1MPa

RoHS10

Part Number	Type	No.	D	A	B	W	Unit Price	Volume Discount Rate
							Qty. 1 - 9	10-20
SNCPW	1S		60	114	70	25		
	1.5S							
	2S		75	124	88	25		

SNFK1S and 1.5S are the same shape. For orders larger than indicated quantity, please check with WOS.

### ■ Features

- Reduces time for attaching or detaching the clamps, and improves operating efficiency.
- Suitable for test equipment requiring frequent attaching and detaching.
- Lever provides uniform torque to enable secure tightening without damaging the gaskets.
- Lack of cross-threading results in more durability compared to screw fastening type.
- Little wear of threads produces less metal powder, contributing in excellent hygiene.

### ■ Allowable Pressure Range: 1MPa or lower

### ■ Results of Pressure Test (Conditions: under Pressure at Room Temperature)

- 1.5MPa x30 minutes: No Leakage
- After 300 times of open/close cycles, 1.5MPa x30 minutes: No Leakage



Excessive pressure on the lever may cause the clamp to come off as there is no locking mechanism. To prevent the malfunction of the clamp, locking the lever using a hole on the lever is recommended.



Example

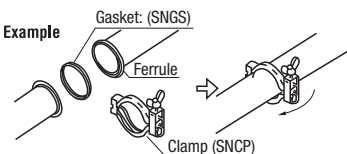

### ● Clamp (SNCP)

### ● One-Touch Clamp (SNCPW)

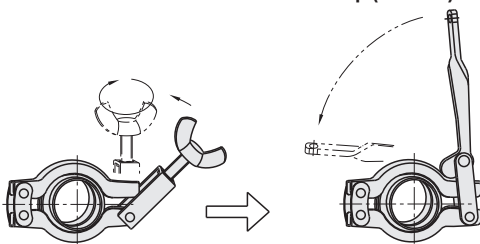

Ordering Example

Part Number  
SNCPW2S