

Annealed Copper Pipes / Annealed Copper Pipe Fittings

Annealed Copper Pipes

DKEN DKENF (End Flare Type)

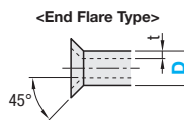
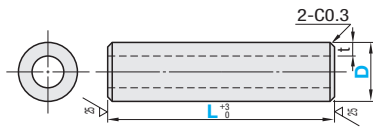

D Dimension Tolerance	
D	Tolerance
3-6	±0.1
8, 10	±0.2

DKENF End Flare Type is flared only at one end.

Material: Copper Phosphate (C1220)

Part Number Type	D	L Selection				t	DKEN Unit Price				DKENF Unit Price					
		L100	L200	L300	L500		L100	L200	L300	L500						
DKEN DKENF	3	100	200	300		1										
	4															
	5															
	6	100	200	300	500											
	8															
	10															

DKEN is shipped unrolled and may arrive a little distorted.

When DKEN and Annealed Copper Pipe Fittings are combined, expand the pipe end to 45° using the flare ring tool.

Ordering Example: Part Number - L
DKEN8 - 300

Annealed Copper Pipe Fittings - Straight

DKNT

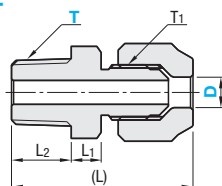

Material: Brass

Annealed Copper Pipe Fittings - Elbow

DKNTL

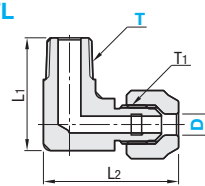

Material: Brass

Part Number Type	D	R (PT) T Selection	T (PT)	(L)	L1	L2	T1 (UNF) Unify Fine Thread	Square		Unit Price
								Main Body	Nut	
DKNT	6	1	1/8	34	6	9	7/16-20UNF	16	17	
		2	1/4	37	6	12		16	17	
		3	3/8	40	8	13		19	17	
	8	1	1/8	35	6	9	1/2-20UNF	16	19	
		2	1/4	38	6	12		16	19	
		3	3/8	41	8	13		19	19	
10	2	1/4	43	8	12	5/8-18UNF	19	22		
	3	3/8	44	8	13		19	22		
	4	1/2	49	10	16		22	22		

Part Number Type	D	R (PT) T Selection	T (PT)	L1	Approx. L2	T1 (UNF) Unify Fine Thread	Square		Unit Price
							Main Body	Nut	
DKNTL	6	1	1/8	22	32	7/16-20UNF	16	17	
		2	1/4	25	32		16	17	
		3	3/8	28	34		19	17	
	8	1	1/8	22	33	1/2-20UNF	16	19	
		2	1/4	25	33		16	19	
		3	3/8	28	35		19	19	
10	2	1/4	27	38	5/8-18UNF	19	22		
	3	3/8	28	38		19	22		
	4	1/2	34	41		24	22		

Annealed Copper Pipe Fittings - Female Threaded Connector (G Thread Type)

DKFGF

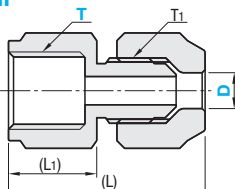

Material: Brass

Fitting Specifications

Applicable Fluids	Air, Water, Industrial Oil
Normal Operating Pressure	3.5MPa
Max. Operating Pressure	7.0MPa
Operating Temperature Range	-20 ~ 150°C (No Freezing)

Features: Suitable for plumbing that requires air tightness such as refrigerant gas pipe.

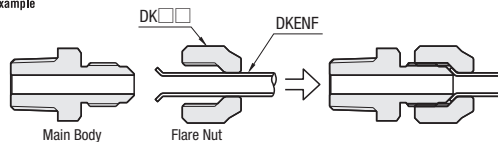

Align the coupling body to the copper pipe, end to end, hand tighten the flare nut, then tighten it securely using a wrench and an adjustable spanner.

Part Number Type	D	T G (PF)	(L)	(L1)	T1 (UNF) Unify Fine Thread	Square		Unit Price
						Main Body	Nut	
DKFGF	6	1/4	34	15	7/16-20UNF	17	17	
	8	1/4	35	15	1/2-20UNF	17	19	
	10	3/8	42	19	5/8-18UNF	22	22	

Ordering Example: Part Number - T
DKNT8 - 2
DKFGF6