

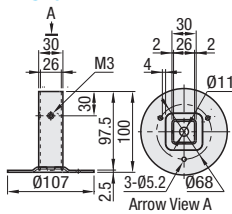

Part Number	Material	Surface Treatment
FFS201	SPCC	
FFS202-12	Leveling Mount: SS400 Equivalent Insert Nut: S45C	Trivalent Chromate
FFS203-8	Main Body: Polyethylene Nut: SS400	- Trivalent Chromate

■ Pipe Stands
FFS201



⚠ Screw is not included.

■ Adjusting Bolt Set
FFS202-12 (Applicable Frame: FFA28)

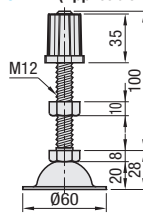

■ Insert Nut M8
FFS203-8 (Applicable Frame: FFA28)

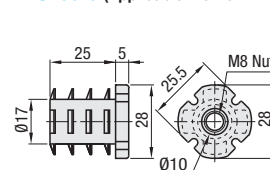

Part Number	Mass (g)	Unit Price
FFS201	320	
FFS202-12	264	
FFS203-8	15	

Ordering Example
Part Number: FFS202-12

Alterations
Part Number - (SET)
FFS201 - SET
⚠ Applicable to FFS201 only.

Alteration	Code	Spec.
Set Screw	SET	2 set screws (M3-6) come with FFS201 as a set.



Part Number	Material	Surface Treatment
FFS203-12	S45C	
FFS204	Polychloroprene	
FFS205	ADC12	

■ Insert Nut M12
FFS203-12 (Applicable Frame: FFA28)

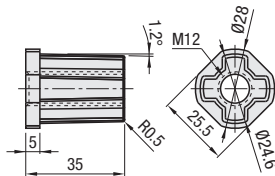

■ Rubber Foot
FFS204 (Applicable Frame: FFA28)

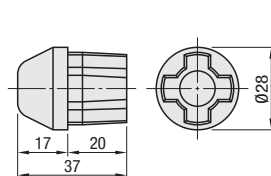

■ Clamp for Factory Frame
FFS205

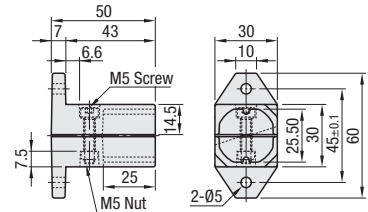

⚠ Accessory: Hex Socket Head Cap Screw M5-20 x 1 pc., M5 Nut x 1 pc.

Part Number	Mass (g)	Unit Price
FFS203-12	80	
FFS204	18	
FFS205	80	

Ordering Example
Part Number: FFS203-12

