

Magnetic Catches for Panels / Ball Catch Sets for Aluminum Extrusions

Magnetic Catches for Panels



RoHS 10

HMENP

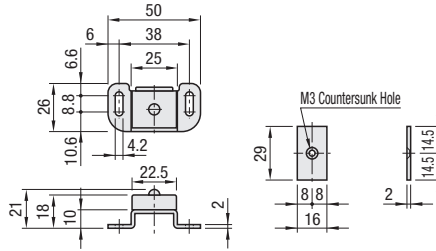

Part Name	Material	Surface Treatment
Housing	SUS304	Dark Brown Paint
Magnet	Ferrite	
Plate	SPCC	Trivalent Chromate

Part Number	Unit Price	Volume Discount Rate
HMENP	1 ~ 9 pc(s)	10~50



Example

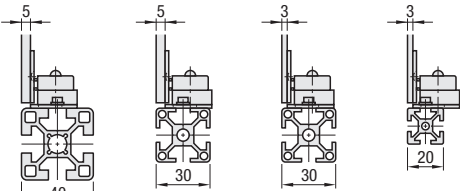

■ When mounting 5mm thick panel to 40 square ■ When mounting 5mm thick panel to 30 square ■ When mounting 3mm thick panel to 30 square ■ When mounting 3mm thick panel to 20 square

Ordering Example

Part Number: **HMENP**

Ball Catch Sets



Material: Ball Catch ① ②: Zinc Alloy (Chrome Plating)
Bracket ③ ④: SPHC (Chrome Plating)
⑤ ⑥: A6063

RoHS 10

HBCS

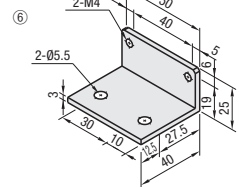
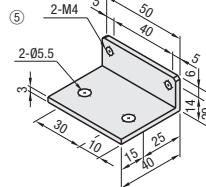
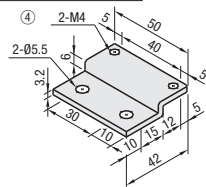
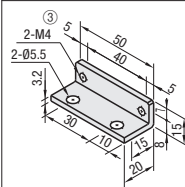
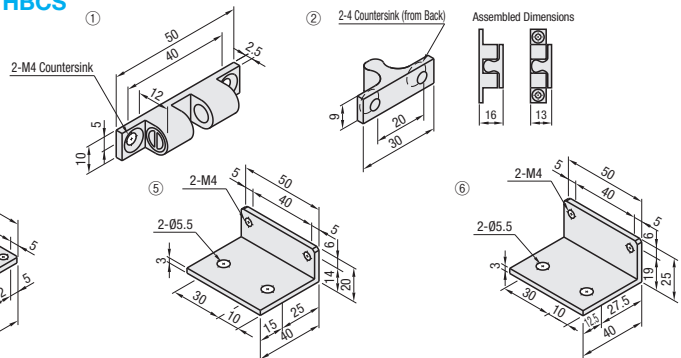

Part Number		Component										Push Force	Pull Force	Unit Price	Volume Discount Rate	
Type	No.	Ball Catch Side				Door Side										
		Ball Catch	Mounting Bracket	For Catch Fitting		For Extrusion Fitting		Door side catch		For Catch Fitting				1 ~ 9 pc(s)	10~50	
				Mounting Screw	Quantity	Screw	Quantity	T Nut	Quantity	Mounting Screw	Quantity	T Nut	Quantity			
HBCS	5	①	③	Flathead Screw M4×6	2	SCB5-8	2	HNTT5-5	2	②	Flathead Screw M4×8	2	HNTT5-4	2		
	6		④			SCB5-10		HNTT6-5								
	8		⑤			SCB5-12		HNTT8-5								
	8-45		⑥			SCB5-15		HNTT8-5								

Ordering Example

Part Number: **HBCS6**

Example

