

Side-Wiring Magnetic Catches for Panel Fitting / Thin Magnetic Catches for Aluminum Extrusions

Side-Wiring Magnetic Catches for Panel Fitting (Photo: HMGAR)

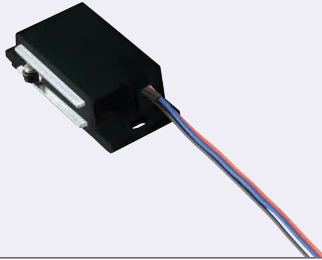

When the magnet housing and the catch plate are attracted, White-Red combination conducts.
When the magnet housing and the catch plate are separated, White-Black combination conducts.



Max. Contact Capacity
AC250V3A
DC125V0.4A

RoHS10

Part Name	Material	Surface Treatment
Caster	Polyethylene	-
Plate	SPCC	Trivalent Chromate



Example

<Existing Product>

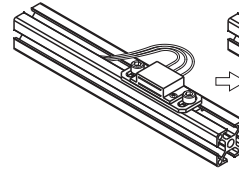

<New Product>

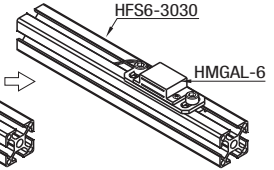

- Wiring comes out from the side, which allows easy fitting into the extrusion slot.
- Wiring does not protrude from the extrusion since bending is not necessary.

Magnet Side	Mounting Plate for M5	Mounting Plate for M6, M8	Door Side Plate
<p>HMGAR (Wiring on the Right) (Drawing: HMGAL) HMGAL (Wiring on the Left)</p>	<p>Plate Thickness 3.2mm</p>	<p>Plate Thickness 3.2mm</p>	<p>Plate Thickness 1.6mm</p>

Part Number	Type	No.	Retaining Force N (kgf)	Mounting Plate	Component						Unit Price	Volume Discount Rate					
					Magnet Side			Door Side									
					For Magnet Mounting		For Extrusion Fitting			Door Side							
					Mounting Screw	Quantity	Screw	Quantity	Pre-Assembly	Insertion Nut	Quantity	Plate	Screw	Nut	1 ~ 4 pc(s)	5 ~ 100	
HMGAR	(Wiring on the Right)	5	9.8 (1)	S5			SCB5-8		HNTT5-5			S Plate	M3x8				
HMGAL	(Wiring on the Right)	6		S6	M3x6	2	SCB6-10	2	HNTT6-6	2			M3x10	2			
HMGAL	(Wiring on the Left)	8		S8			SCB6-15		HNTT8-6								

Thin Magnetic Catches for Aluminum Extrusions



* When requesting magnets only, refer to MGCBU on P.1213.

RoHS10

Parts	Material	Surface Treatment
Housing	ABS Resin	-
Magnet	Ferrite	-
Attraction Board	SPCC	Chrome Plating



Example

6-6 Mounting Example

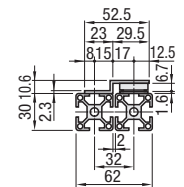

5-5 Mounting Example

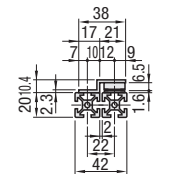

MB5-5

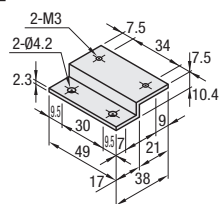

MB6-6

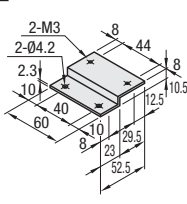

MGCBU

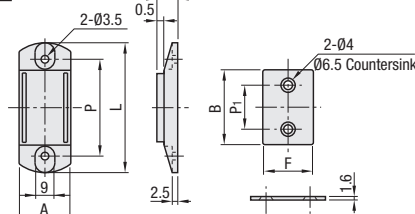

Part Number	Type	No.	Magnet	Component										Unit Price	Volume Discount Rate								
				Extrusion Side					Door Side														
				L	P	A	t	F	B	P ₁	Mounting Plate	Mounting Screw	Quantity	Nut	Quantity	Mounting Screw	Quantity	Mounting Screw	Quantity	Nut	Quantity	1 ~ 9 pc(s)	10 ~ 200
HMBCE	5-5	MGCBU49	49	34	17	6.5	16.5	24	13	MB5-5	SCB4-6	2	HNTT5-4	2	SCB3-6	4	HFBCM3-6	2	HNTT5-3	2			
HMBCE	6-6	MGCBU59	59	44	23.5	6.7	23	34	20	MB6-6	SCB4-8	2	HNTT6-4	2	SCB3-6	4	HFBCM3-8	2	HNTT6-3	2			

Ordering Example
Part Number
HMGAR5
HMBCE6-6