

Extrusion End Caps

For 8-45 Series (Slot Width 10mm) Aluminum Extrusions

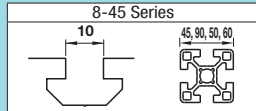

Features: Standard caps for protecting extrusion end faces. Alterations for Aluminum Extrusions not necessary.

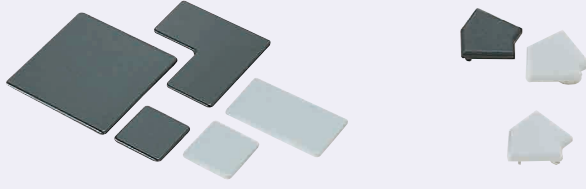

Type	Material
HFC	Polyamide
HFCL	Low Density Polyethylene

- Some products are not required to specify colors. In that case, color is black.
- The pin's shape and numbers of extrusion end caps may be changed to prevent caps from easily falling off.
- HFCL is not applicable to extrusions with Wrench Hole in Fixed Position (P761), D Type Hole (P764), or L Type Hole (P767).

HFC8-4545

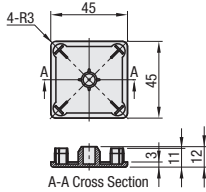

HFCL8-4545

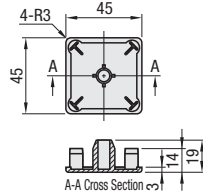

HFC8-4590

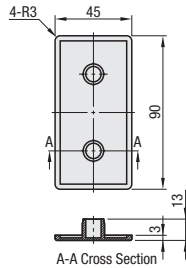

HFCL8-4590

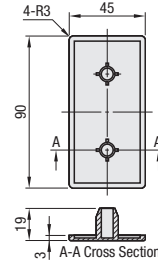

HFC8-9090

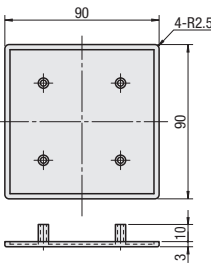

HFC8-909045

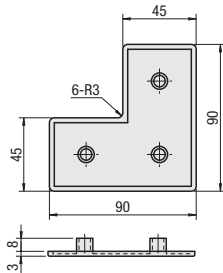

HFC8-5050

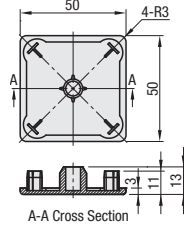

HFC8-50100

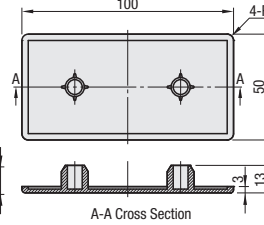

HFC6-8-6060

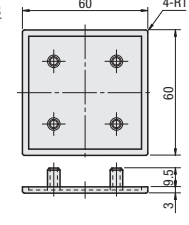

HFC30A8-45

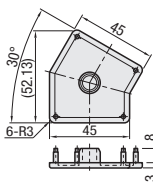

HFC45A8-45

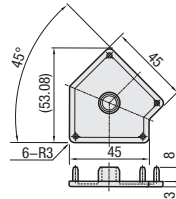

HFC60A8-45

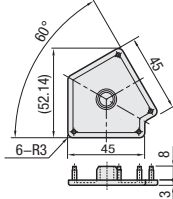

HFCL8-4545

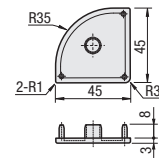

HFC and HFCL can be used for each Aluminum Extrusion other than GFS/GNFS Series.
 For Aluminum Extrusions other than GFS Series, the same extrusion end caps as of HFS Series can be used. For caps for GFS Series, see P734.

Part Number		Color	Unit Price 1 - 14 pc(s)	Volume Discount Rate		Applicable Extrusion
Type	No.			15~19	20~200	
HFC8	4545	B (Black)				8-4545
	4590					8-4590
	9090					8-9090
	909045					8-909045
	4545					8-4545
HFCL8	4590					8-4590
	30A8-45		S (Light Gray)			
HFC45A8-45						45A8-45
HFC60A8-45						60A8-45
HFCR8-4545						8-909045
HFC8	5050					8-5050
	50100					8-50100
HFC6-8	6060					8-6060 (6-6060)

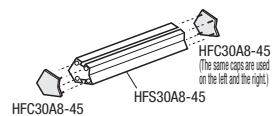

When using Aluminum Extrusion HFS8-90180, please use 2 pieces of HFC8-9090.

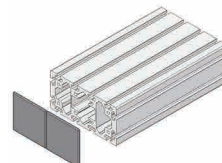

HFC8-5050 cannot be used for 6-5050 extrusion.
 HFC6-8-6060 can be used for both 6-6060 and 8-6060.