

Free Angle Brackets

For 6 Series (Slot Width 8mm) Aluminum Extrusions

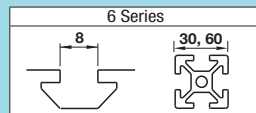

■ **Features:** Extrusions can be connected at any arbitrary angles.

Free Angle Brackets



Type	Material	Surface Treatment
HBLTBA30 HBLTBBN30 HBLTBC30 HBLTBD30	A6N01SS-T5	Anodize
Included Screw	SCM435	Trivalent Chromate

Extrusion Side Face Connection Type

HBLTBA30 (An order of quantity 1 includes 1 pc.)

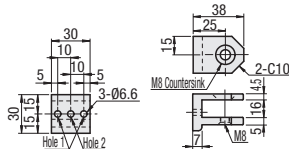

Extrusion Cross Section Connection Type

HBLTBBN30 (An order of quantity 1 includes 1 pc.)

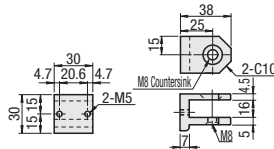

Clamp Lever Type

HBLTBC30 (An order of quantity 1 includes 1 pc. each of ① and ③.)

HBLTBD30 (An order of quantity 1 includes 1 pc. each of ② and ③.)

① Extrusion Side Face Connection Type

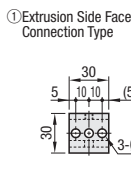

② Extrusion Cross Section Connection Type

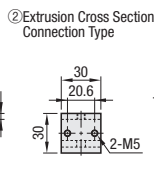

③ Extrusion Cross Section Connection Type (Base)

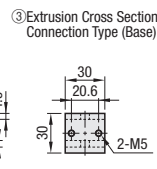

Part Number	Applicable Extrusion	Mass (g)	Accessory	Quantity	Unit Price	Volume Discount Rate
HBLTBA30	30 Square (HFS6)	33	M8x12	1		15-50
HBLTBBN30		35				
HBLTBC30		86				
HBLTBD30		88				

Ordering Example
Part Number: **HBLTBA30**

Alterations	Code	How to Use	Part Number	Accessory			
				Type	No.	Screw	Quantity
Applicable Screws and Nuts Set	SET1	Use the hole 1.	HBLTBBN	CBM5-25	2	HDJFSN6	1
	SET2	Use the hole 2.	HBLTBA	CBM6-15	2	HNTTG-6	2
	SET3	Use the hole 1.	HBLTBC	CBM6-15	1	HNTTG-6	1
	SET4	Use the hole 2.	HBLTBC	CBM5-25	2	HDJFSN6	1
	SET5		HBLTBD	CBM5-25	2	HNTTG-6	2

⚠ When connecting with Pre-Assembly Insertion Double Joints, S type hole machining (P765) is required on extrusions.
⚠ Included Screw is not RoHS compliant when -SET□ is specified.



(1) Connection of Two End Sections

Two pieces of HBLTBBN are used to connect two end sections using Pre-Assembly Insertion Double Joints (P611). (With Clamp Lever Type: HBLTBD30)

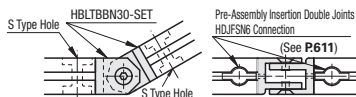

(2) Connection of Two Side Faces

To the extrusion side face, connect with HBLTBA, a screw and a nut. To the end face, use 1 HBLTBBN for 1 HBLTBA using Pre-Assembly Insertion Double Joint. (With Clamp Lever Type: HBLTBD30)

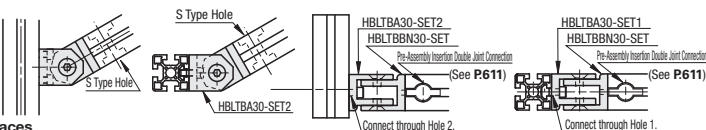

(3) Connection of Two Side Faces

Two pieces of HBLTBA are used to connect them with extrusion side using screws and nuts.

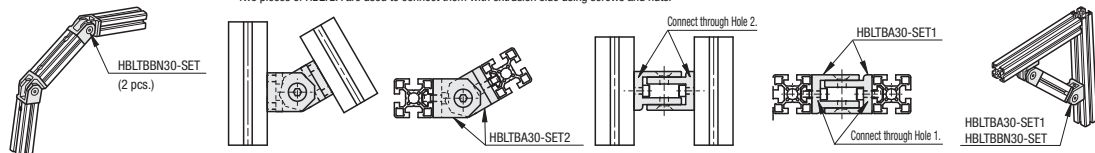

■ **Features:** Sheet Metal Brackets to fix at arbitrary positions.

Free Angle Sheet Metal Brackets

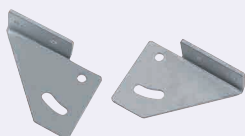

Material: SPCC
Surface Treatment: Trivalent Chromate



HBLPBL6

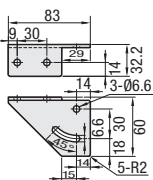

HBLPBR6

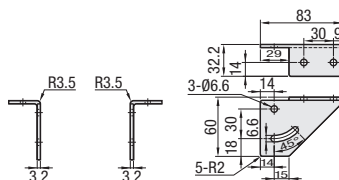

Ordering Example
Part Number: **HBLPBL6**

Part Number	Applicable Extrusion	Applicable Screw and Nut	Unit Price	Volume Discount Rate
HBLPBL6 HBLPBR6	30 Square (HFS6)	CBST6-12	1-99 pc(s).	100-150



Alterations	Code	Spec.	Applicable Bracket
Applicable Screws and Nuts Set	SET	Supplies a set of applicable screws and nuts for fixing the bracket to an extrusion.	HBLPBL6 HBLPBR6
Set with applicable screws, nuts and clamp levers.	SET1	Applicable Screw: 3 pcs. Clamp Lever (LNP): 1 pc. Flat Washer (PWF): 1 pc. Applicable Nut: 4 pcs. Set with the above items.	HBLPBL6 HBLPBR6