

# Locating Screw Stopper Blocks

## L-Shaped Type

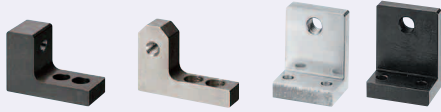

RoHS 10

Lengthways Adjustable Type		Widthways Adjustable Type		Bottom Mounting Type*		M	S
Coarse	Fine	Coarse	Fine	Coarse	Fine		
AJLTT	AJLSTT	AJLCTY	AJLCSTY	AJLN	AJLS	*S45C	Black Oxide Electress Nickel Plating
AJLTTM	AJLSTTM	AJLCTYM	AJLCSTYM	AJLNM	AJLSM	SUS304	-
AJLTTs	AJLSTTs	AJLCTYS	AJLCSTYS	AJLNs	AJLSs		

\*SS400 for Bottom Mounting Type

25 / ( 6.3 / )

### Lengthways Adjustable Type

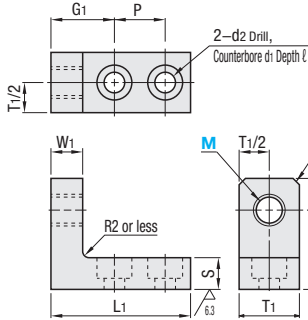

### Widthways Adjustable Type

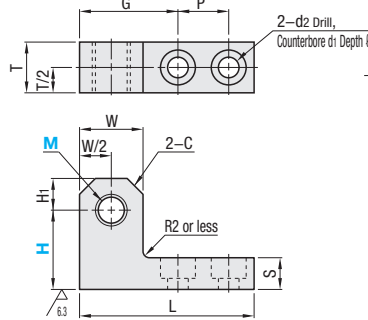

### Bottom Mounting Type

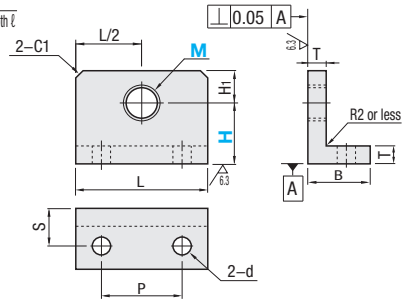

## Lengthways Adjustable Type

Part Number		H Selection	H <sub>1</sub>	T <sub>1</sub>	MxPitch		W <sub>1</sub>	L <sub>1</sub>	P	S	d <sub>1</sub>	d <sub>2</sub>	ℓ	G <sub>1</sub>
Type	M				Coarse	Fine								
(Coarse) AJLTT AJLTTM AJLTTs	3	15 20	4	9	3x0.5	3x0.35	5	25	10	6	6.5	3.5	3.5	10
	4				4x0.7	4x0.5								
	5	25 30 35	6	12	5x0.8	5x0.5	8	32	10	8	8	4.5	4.5	15
	6				6x1.0	6x0.75								
	8				8x1.25	8x0.75								
	10				10x1.5	10x1.0								
	12	35 40	10	22	12x1.75	12x1.0	10	44	16	10	11	6.5	6.5	20
	16				16x2.0	16x1.5								
	20				20x2.5	20x1.5								
	16	30 35 40	15	30	16x2.0	16x1.5	15	65	30	15	14	9	9	25
20	20x2.5				20x1.5									

## Widthways Adjustable Type

Part Number		H Selection	H <sub>1</sub>	T	MxPitch		L	W	P	S	d <sub>1</sub>	d <sub>2</sub>	ℓ	C	G
Type	M				Coarse	Fine									
(Coarse) AJLCTY AJLCTYM AJLCTYS	3	10 15	4	9	3x0.5	3x0.35	28	8	10	6	6.5	3.5	3.5	2	13
	4				4x0.7	4x0.5									
	5	20 25 30	6	10	5x0.8	5x0.5	32	10	10	8	8	4.5	4.5	2	17
	6				6x1.0	6x0.75									
	8				8x1.25	8x0.75									
	10				10x1.5	10x1.0									
	12	30 35 40	10	16	12x1.75	12x1.0	55	20	16	10	11	6.5	6.5	5	31
	16				16x2.0	16x1.5									
	20				20x2.5	20x1.5									
	16	30 35 40	15	19	16x2.0	16x1.5	75	30	20	15	14	9	9	7	45
20	20x2.5				20x1.5										

## Bottom Mounting Type

Part Number		H Selection	H <sub>1</sub>	T	MxPitch		L	B	P	S	d
Type	M				Coarse	Fine					
AJLN AJLS AJLNM AJLSM AJLNs AJLSs	3	15 20	10	6	3x0.5	3x0.35	30	20	14	12	4.5
	4				4x0.7	4x0.5					
	5	25 30 40	15	10	5x0.8	5x0.5	40	30	20	20	6.5
	6				6x1.0	6x0.75					
	8				8x1.25	8x0.75					
	10				10x1.5	10x1.0					
	12	30 40 50	15	(8)	12x1.75	12x1.0	60	40	30	27.5	9
	16				16x2.0	16x1.5					
	20				20x2.5	20x1.5					

⚠ T dimension of AJLNs and AJLSs (Material: Stainless Steel) is shown in ( ). M16 and 20 is not available.



Order Example  
Part Number - H  
AJLTT5 - 15