

# Spur Gear

Pressure Angle 20°, Module 2.0, Shaft Bore Configurable Type



Type			M Material	S Surface Treatment	A Accessory
Straight Bore	Straight Bore + Tap	Keyway, Keyway + Tap	S45C Equivalent	-	Set Screw (SCM435, Black Oxide)
GEAHB	GEAB	GEAKB		Black Oxide	
GEAHBB	GEABB	GEAKBB		Electroless Nickel Plating	
-	GEABG	GEAKBG	SUS304	-	Set Screw (SUS304)
GEAHS	-	GEAKS		-	

⊗ Set Screw is not included in Un-tapped Type products.

### Shaft Shape

Shape A

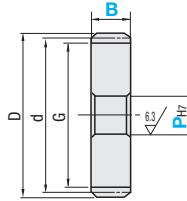

Shape B

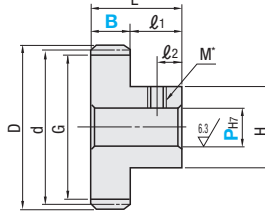

Shaft Bore Specifications (Selectable Gear Shapes)

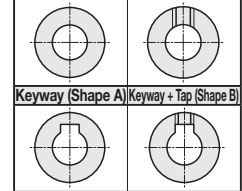

⊗ For Tap, Keyway Dimension Details, see P.1532.  
⊗ Positioning of keyway and teeth is not fixed.

Accuracy Previous JIS B 1702 Class 4 (New JIS B 1702-1 Class 8 Equivalent)

⊗ Tapped shaft bores are not available for Shape A.

When desiring to fix the gear hub onto the shaft through MechaLock, see Keyless Type on P.1557. For configuring the tooth width / hub dimensions, see P.1511.

Part Number	Number of Teeth	B	Gear Shape	Shaft Bore Dia. P/10 (1mm Increment)		d Reference Dia.	D Tip Dia.	G Root Dia.	H	L	l1	l2	M (Coarse)	*1 Allowable Transmission Force (N·m)	
				Straight Bore	Keyway, Keyway + Tap									S45C Equivalent	SUS304
Straight Bore (Shape A, Shape B) GEAHB GEAHBB GEAHS	12	2	A	8	8N	24	28	19	18	30	10	5	M5	19.75	11.27
	13			8~11	26	30	21	20	22.65					12.92	
	14			8~15	28	32	23	20	25.58					14.6	
	15			8~16	30	34	25	24	28.65					16.35	
	16			8~19	32	36	27	25	31.73					18.11	
	17			8~21	34	38	29	28	34.89					19.91	
	18			8~21	36	40	31	30	38.07					21.73	
	19			8~21	38	42	33	31	41.27					23.55	
	20			8~23	40	44	35	33	44.59					25.45	
	21			8~23	42	46	37	34	47.87					27.32	
	22			8~25	44	48	39	36	51.27					29.26	
	23			8~25	46	50	41	37	54.57					31.14	
	24			8~28	48	52	43	40	57.96					33.07	
	25			8~30	50	54	45	40	61.43					35.05	
	26			8~30	52	56	47	42	64.99					37.09	
	27			8~33	54	58	49	45	68.39					39.02	
	28			8~33	56	60	51	45	72.12					41.16	
	29			8~35	58	62	53	47	75.35					43	
	30			8~36	60	64	55	48	78.93					45.04	
	32			8~38	64	68	59	50	85.59					48.84	
34	10~38	68	72	63	50	93.52	53.37								
35	10~40	70	74	65	52	97.01	55.36								
36	10~43	72	76	67	55	100.13	57.14								
38	10~43	76	80	71	55	107.7	61.46								
40	10~43	80	84	75	55	114.52	65.35								
42	10~48	84	88	79	60	121.92	69.57								
44	10~48	88	92	83	60	129.46	73.88								
45	10~48	90	94	85	60	133.29	76.06								
46	10~48	92	96	87	60	137.15	78.26								
48	10~50	96	100	91	62	144.35	82.38								
50	10~50	100	104	95	62	151.64	86.53								
52	12~52	104	108	99	65	158.99	90.73								
54	12~52	108	112	103	65	166.42	94.97								
55	12~52	110	114	105	65	170.54	97.32								
56	12~52	112	116	107	65	174.69	99.69								
58	15~52	116	120	111	65	181.5	103.58								
60	15~52	120	124	115	65	189.16	107.94								
62	15~52	124	128	119	65	196.02	111.86								
64	15~52	128	132	123	65	203.78	116.29								
65	15~52	130	134	125	65	207.23	118.26								
68	15~52	136	140	131	65	219.54	125.28								
70	15~52	140	144	135	65	226.51	129.26								
*72	20~52	144	148	139	65	233.49	-								
*75	20~52	150	154	145	65	245.07	-								
*80	20~52	160	164	155	65	263.82	-								
*85	20~55	170	174	165	70	282.76	-								
*90	20~55	180	184	175	70	301.9	-								
*95	20~55	190	194	185	70	321.22	-								
*100	20~55	200	204	195	70	362.11	-								

⊗ \* marked number of teeth is not available for GEAKS, GEAKS. ⊗ The "-" text on the above table means that any Shaft Bore Dia. is not selectable.

⊗ Shaft bore diameter 9N is not available for Keyway Bore + Tap.

⊗ Specify 10K as the P dimension if keyway width of 4.0mm (height 1.8mm) for Keyway + Tap with shaft bore diameter of 10 is desired P.1532.

\*1. Allowable Transmission Forces in the table are reference values calculated with prescribed conditions. For conditions, see P.1534.

Ordering Example	Part Number	Number of Teeth	B	Gear Shape	P
	GEAKBG2.0	15	20	B	10N
	GEAHB2.0	30	20	A	8