

Pulleys for Flat Belts - Width L = 110~510

Crowned, Crosspiece Groove Straight

For products uncovered by the e-Catalog Standard, see P.131.



Type	Material	Surface Treatment
Crowned (Crosspiece Groove Straight)	Pulley Press Fit Bushing	
ROBAWC ROBAWM	Aluminum Alloy	Clear Anodize
ROBMWC ROBMWM	STKM13A	Electroless Nickel Plating
ROBSWC ROBSWM	SUS304	

Set screws are not included. P.2-239
 *1. Since the drawing surface of pipe is unpolished, the Inner Dia. d1 is misshapen to some extent.



Crowned ROBAWC, ROBMWC, ROBSWC

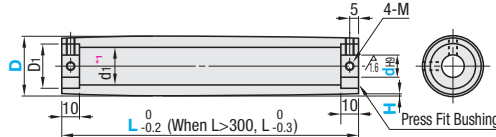

Crosspiece Groove Straight ROBAWM, ROBMWM, ROBSWM

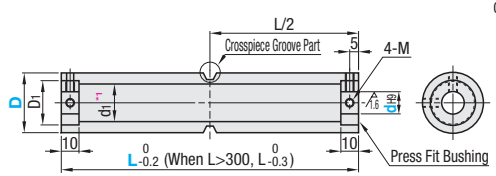

Keyway Shape

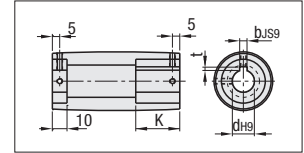

New JIS (B1301) Keyway Dimensions

Nominal	dH9	bJS9	t Tolerance
N8	8	3	1.4
N10	10	3	1.8
NK10	10	4	±0.150
N12	12	5	2.3
N15	15	6	2.8
N20	20	8	3.3
N25	25	10	±0.180
N30	30	10	±0.20
N35	35	10	±0.20

*X≥Y
 For Crosspiece Groove Part Dimensions, see "Pulley, Idler Relief Dimensions", P.1399

Part Number	Type	dH9		1mm Increment	H Selection		0.1mm Increment			K	d1			M					
		Round Hole + Tap	Keyway + Tap		L	L=110-300	L=310-510	X	Y		Z	Key Length	Aluminum Alloy	Steel (STKM13A)	Stainless Steel (SUS304)	D1	Round Hole + Tap	Keyway + Tap	
Crowned ROBAWC ROBMWC ROBSWC	30	8	N8	110-510	0.3	0.5	7.0-15.0	5.0-12.0	2.0-4.5	25	15	15.8	18	22	M4	M3			
		10	N10								18.1	18	27						
		12	N12								18.1	18	27						
		10	N10								17	18.7	20				33	M4	M3
		12	N12								17	18.7	20				33	M4	M4
		15	N15								22	22.7	22				40	M5	M5
	40	12	N12							17	18.7	20	33	M4	M3				
		15	N15							17	18.7	20	33	M4	M4				
		20	N20							22	22.7	22	40	M5	M5				
		15	N15							17	18.7	20	33	M4	M3				
		20	N20							22	22.7	22	40	M5	M5				
		25	N25							27	27.7	27	45	M6	M6				
Crosspiece Groove Straight ROBAWM ROBMWM ROBSWM	50	20	N20	110-510	0.5	1.0	7.0-15.0	5.0-12.0	4.0-6.0	30	30	28	40	45	M6	M6			
		25	N25								30	28	40				M5	M5	
		25	N25								30	28	40				M5	M5	
	30	N30	32								-	-	45				M6	M6	
	20	N20	22								-	-	45				M6	M6	
	25	N25	27								-	-	45				M6	M6	
(60)	25	N25	30							28	40	M5	M5						
	30	N30	32							-	-	45	M6	M6					
	35	N35	35							-	-	55	M8	M8					
(80)	25	N25	30							28	40	M5	M5						
	30	N30	32							-	-	45	M6	M6					
	35	N35	35							-	-	55	M8	M8					

D=(60) or (80) is applicable only for the Aluminum Alloy material. For Crosspiece Groove Straight Type with D = 30 or 35, only Aluminum Alloy is available as the material. Specify NK10 when Keyway + Tap with shaft bore dia. 10 and keyway width 4.0mm (height 1.8mm) is desired.



Ordering Example

Part Number	d	L	H
ROBAWC30	10	L350	H1.0
ROBMWC35	N10	L300	H0.5
ROBSWC50	N15	L400	H0.5

Part Number	d	L	X	Y	Z
ROBAWM60	25	L250	X14.0	Y11.8	Z6.0
ROBMWM50	20	L350	X13.0	Y11.5	Z6.0
ROBSWM50	25	L400	X12.0	Y10.0	Z6.0

D	Unit Price																				Keyway Machining Charge (Body Price +)			
	Crowned										ROBSWC													
	ROBAWC Aluminum Alloy					ROBMWC Steel (STKM13A)					Stainless Steel (SUS304)													
	L110-150	L160-200	L210-250	L260-300	L310-350	L360-400	L410-450	L460-510	L110-150	L160-200	L210-250	L260-300	L310-350	L360-400	L410-450	L460-510	L110-150	L160-200	L210-250	L260-300	L310-350	L360-400	L410-450	L460-510
30																								
35																								
40																								
50																								
60																								
80																								

D	Unit Price																				Keyway Machining Charge (Body Price +)			
	Crosspiece Groove Straight										ROBSWM													
	ROBAWM Aluminum Alloy					ROBMWM Steel (STKM13A)					Stainless Steel (SUS304)													
	L110-150	L160-200	L210-250	L260-300	L310-350	L360-400	L410-450	L460-510	L110-150	L160-200	L210-250	L260-300	L310-350	L360-400	L410-450	L460-510	L110-150	L160-200	L210-250	L260-300	L310-350	L360-400	L410-450	L460-510
30																								
35																								
40																								
50																								
60																								
80																								