

# Free Guide Arm Sets

## Fixed Arm / Flex-Arm / Mechanical Locking Flex-Arm

■ **Features:** A set of a Free Guide Arm and a Magnetic Base. Suitable for holding measurement instruments, sensors and lights with easy adjustment. For Arm only, P.2035

■ **Fixed Arm**

■ **Fixed Arm**

**FGPMA**  
Tip Tapped

**FGPMB**  
Tip Holder Through Hole

**FGPMC**  
Tip Holder Tapped Hole

■ **Material:**  
Body SUM22  
Magnet Base SS400, Neodymium Magnet, ABS

■ **Surface Treatment:**  
Main Body Electroless Nickel Plating  
Magnetic Base Paint Finish

Magnetic Base (MGNBS100)

⚡ **Magnetic Bases Details P.2037**

■ **Flex-Arm**  
■ **Mechanical Locking Flex-Arm**

■ **Flex-Arm**

**FGLMA**  
Tip Tapped

**FGFMB**  
Tip Holder Through Hole

**FGFMC, FGFKC**  
Electroless Nickel Plating Black Oxide  
Tip Holder Tapped Hole

■ **Mechanical Locking Flex-Arm: Locking Method**

- To lock,
  - Turn the nut ① counterclockwise.
  - Turn the nut ② counterclockwise.
  - Lift up the lock lever ③ from Left to Up and lock.
- To unlock,
  - Push down the lock lever ③ from Up to Left.
  - Turn the nut ② counterclockwise.
  - Turn the nut ① clockwise and unlock.

■ **Material:**  
Main Body SUM22  
Magnetic Bases SS400, Neodymium Magnet, ABS

■ **Surface Treatment:**  
Main Body Electroless Nickel Plating  
Black Oxide  
Magnetic Base Paint Finish

Magnetic Base (MGNBS80)

⚡ **Magnetic Bases Details P.2037**

■ **Fixed Arm**

Part Number	Type	No.	(L)	(L1)	(L2)	h1	h2	Weight (kg)	Allowable Load (N) (Ref.)	Attraction Force (N)	FGPMA		FGPMB		FGPMC	
											Unit Price	Volume Discount Rate	Unit Price	Volume Discount Rate	Unit Price	Volume Discount Rate
Tip Tapped (M6)	FGPMA	100	272	145	62	15	56	1.7	24.5	1000	1 ~ 4 pc(s)	5 ~ 10	1 ~ 4 pc(s)	5 ~ 10	1 ~ 4 pc(s)	5 ~ 10
Tip Holder Through Hole	FGPMB	200	432	228	142	17	68	1.9	17.6		1 ~ 4 pc(s)	5 ~ 10	1 ~ 4 pc(s)	5 ~ 10	1 ~ 4 pc(s)	5 ~ 10
Tip Holder Tapped Hole	FGPMC										1 ~ 4 pc(s)	5 ~ 10	1 ~ 4 pc(s)	5 ~ 10	1 ~ 4 pc(s)	5 ~ 10

■ **Flex-Arm**

⚡ For orders larger than indicated quantity, please check with WOS.

Part Number	Type	L	Weight (kg)	Allowable Load (N) (Ref.)	Attraction Force (N)	FGLMA	
						Unit Price	Volume Discount Rate
Tip Tapped (M6)	FGLMA	200	0.8	3.9	800	1 ~ 4 pc(s)	5 ~ 10
		300	0.9	2.0		1 ~ 4 pc(s)	5 ~ 10

■ **Mechanical Locking Flex-Arm**

⚡ For orders larger than indicated quantity, please check with WOS.

Part Number	Type	Weight (kg)	Allowable Load (N) (Ref.)	Attraction Force (N)	FGFMB		FGFMC		FGFKC	
					Unit Price	Volume Discount Rate	Unit Price	Volume Discount Rate	Unit Price	Volume Discount Rate
Tip Holder Through Hole	FGFMB	1.1	4.9	800	1 ~ 4 pc(s)	5 ~ 10	1 ~ 4 pc(s)	5 ~ 10	1 ~ 4 pc(s)	5 ~ 10
Tip Holder Tapped Hole	FGFMC				1 ~ 4 pc(s)	5 ~ 10	1 ~ 4 pc(s)	5 ~ 10		
	FGFKC				1 ~ 4 pc(s)	5 ~ 10	1 ~ 4 pc(s)	5 ~ 10		

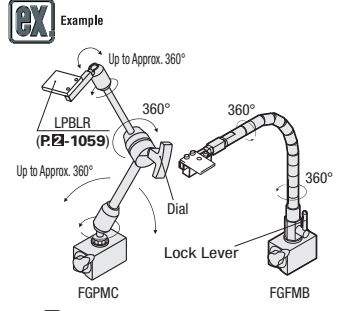

**Ordering Example**

**Part Number**  
FGPMA100  
FGLMA300  
FGFMB

⚡ For orders larger than indicated quantity, please check with WOS.

