

# Threaded Stopper Blocks

Standard, Counterbored Holes, Counterbored and Tapped Holes

**Features:** Slim Screw Stopper Blocks without excess thickness. The hex screw cap is designed to not protrude from the top.

**Threaded Stopper Blocks Standard**

RoHS 10

Type		Material	Surface Treatment
Coarse	Fine		
SNTBB	SSTXB	Steel for General Structure (SNTBB) SS400 (SSTXB)	Black Oxide
SNTBM	SSTBM	Steel for General Structure	Electroless Nickel Plating
SNTBS	SSTBS	SUS304	-

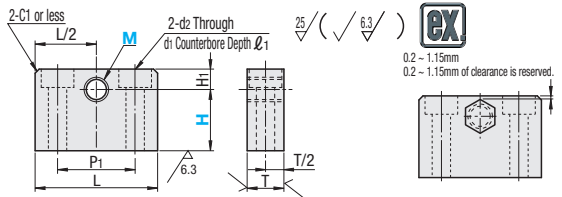

Part Number		MxPitch										Unit Price				
Type	M	H 1mm Increment	H1	T	Coarse		Fine		L	P1	d1	d2	l1	SNTBB SSTXB	SNTBM SSTBM	SNTBS SSTBS
(Coarse)	4	5-20	5	8	4x0.7	4x0.5	22	14	6	3.5	3.5					
(Fine)	5	5-20	5	10	5x0.8	5x0.5	30	18	8	4.5	4.5					
SNTBB	6	6-20	6	10	6x1.0	6x0.75	32	20	9.5	5.5	5.5					
SNTBM	8	8-20	8	12	8x1.25	8x0.75	32	20	11	6.5	6.5					
SNTBS	10	10-20	10	16	10x1.5	10x1.0	38	22								
	12	12-25	12	16	12x1.75	12x1.0	38	22								
	16	15-30	15	19	16x2.0	16x1.5	50	32	14	9	9					

Ordering Example: Part Number - H  
SNTBM8 - 12  
SSTBS10 - 20

**Threaded Stopper Blocks Counterbored Holes**

RoHS 10

Type		Material	Surface Treatment
Coarse	Fine		
STBN	STBS	SS400 Equivalent	Trivalent Chromate

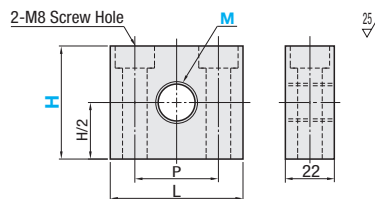

Part Number		H Selection		MxPitch		L	P	Unit Price
Type	M	Coarse	Fine	Coarse	Fine			
(Coarse)	6	30	6x1.0	6x0.75	45	24		
(Fine)	8	30	8x1.25	8x0.75				
STBN	10	50	10x1.5	10x1.0	50	28		
STBS	12	50	12x1.75	12x1.0				

Ordering Example: Part Number - H  
STBS10 - 50

For orders larger than indicated quantity, please check with WOS.

**Threaded Stopper Blocks Counterbored and Tapped Holes**

RoHS 10

H Selectable		H Configurable		Material	Surface Treatment
Coarse	Fine	Coarse	Fine		
AJSN	AJSS	AJFSN	AJFSS	Steel for General Structure	Black Oxide
AJSNM	AJSSM	AJFSNM	AJFSSM		Electroless Nickel Plating
AJSNS	AJSSS	AJFSNS	AJFSSS		-

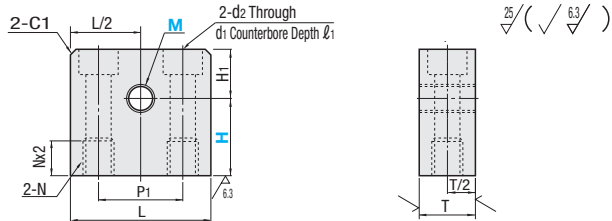

Part Number		H				MxPitch		Unit Price												
Type	M	Selectable	Configurable 1mm Increment	H1	T	Coarse	Fine	L	P1	d1	d2	l1	N	H Selectable			H Configurable			
														AJSN	AJSNM	AJSNS	AJFSN	AJFSNM	AJFSNS	
(H Selectable)	3	10 15	10-20	10	10	3x0.5	3x0.35													
(H Configurable)	4	10 15	10-20			4x0.7	4x0.5													
(Coarse)	5	10 15	10-20			5x0.8	5x0.5	32	20	8	4.5	4.5	M5							
AJSN	6	15 20 25 30	15-35			6x1.0	6x0.75													
AJFSN	8	15 20 25 30	15-35			8x1.25	8x0.75													
AJSS	10	15 20 25 30	15-35	15	16	10x1.5	10x1.0	44 (50)	28	11	6.5	6.5	M8							
AJFSS	12	15 20 25 30	15-35			12x1.75	12x1.0													
AJSSM	16	20 25 30 40	20-50	20	22	16x2.0	16x1.5	60 (65)	42	14	9	9	M10							
AJSSS	20	20 25 30 40	20-50			20x2.5	20x1.5													

L dimension of Stainless Steel Type is shown in ( ).

Ordering Example: Part Number - H  
AJSN3 - 10