

Pulleys for Round Belts

Double

Pulleys for Round Belts



RoHS10

Type	M Material	S Surface Treatment	A Accessory
MBWAC	Aluminum Alloy	Clear Anodize	Set Screw 2 pcs. (SUS304)
MBWS	SUS304	-	-

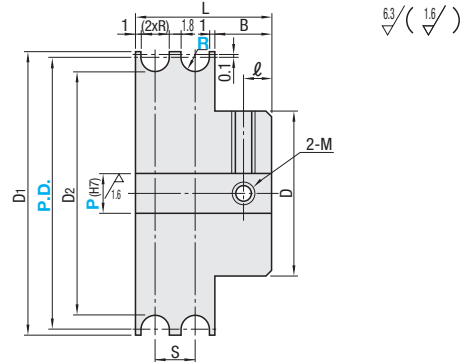

Part Number Type	P.D.	R	Shaft Bore Specification, I.D. P (H7) 1mm Increment	S	D	D1	D2	L	l	B	M (Coarse)	Accessory: Set Screw	Applicable Round Belt Dia.	Unit Price		
														MBWAC	MBWS	
MBWAC MBWS	15	1.1	3~8	4	12	17	13	14	3	5.8	M3	M3x3	2			
	20		4~10		16	22	18									
	30		4~12		20	32	28									
	20	1.6	3~10	5	16	22	17	16	3	5.8	M3	M3x3	3			
	30		5~12		20	32	27									
	40		5~12		20	42	37									
	45		5~20		30	47	42									
	23	2.1	5~12	6	25	19	18	3	5.8	M3	M3x3	4				
	28				30	24										
	30				32	26										
	40				42	36										
	45				25	47							41			
	48	30	50	44	20	4	7.8	M4	M4x3							
	28	2.6	5~12	7	20	30	23	20	3	5.8	M3	M3x3	5			
	40		5~20		30	42	35	22	4	7.8	M4	M4x3				
	50		5~20		30	52	45									
	28	3.1	5~12	8	30	22	30	22	22	3	5.8	M3	M3x3	6		
	38		40			32										
	48		50			42										
	50		52			44										
	60		62			54										
	75		77			69										
	100	102	94													
	50	4.1	5~20	10	30	52	42	30	5	9.8	M5	M5x4	8			
	60		62			52										
	100		102			92										
	60	5.1	5~20	12	34	62	50	34	5	9.8	M5	M5x4	10			
	100		102			90										
140	142		130													

For MBWAC, surface treatment may not be applied to shaft bores.



Ordering Example: Part Number - R - Shaft Bore Specification, I.D.
MBWS30 - 1.6 - P5



Alterations: Part Number - R - Shaft Bore Specification, I.D. - (DC)
MBWA40 - 2.6 - P8 - DC

Alterations Code	O.D. Cut DC									
Spec.	Reduces D1 diameter by cutting. Ordering Code: DC									
	<table border="1"> <thead> <tr> <th>Available R</th> <th>DC</th> </tr> </thead> <tbody> <tr> <td>1.1</td> <td>PD.+0.8</td> </tr> <tr> <td>1.6</td> <td>PD.+1.2</td> </tr> <tr> <td>2.1</td> <td>PD.+1.6</td> </tr> <tr> <td>2.6</td> <td>PD.+1.8</td> </tr> </tbody> </table>	Available R	DC	1.1	PD.+0.8	1.6	PD.+1.2	2.1	PD.+1.6	2.6
Available R	DC									
1.1	PD.+0.8									
1.6	PD.+1.2									
2.1	PD.+1.6									
2.6	PD.+1.8									

Applicable only to products with R 1.1, 1.6, 2.1 and 2.6.
 Surface treatment may not be applied to the machined area.



Example

