

Pulleys for Flat Belts with Urethane

Crowned, Crosspiece Groove Straight

Width L=25 ~ 100

Features: Urethane lining is applied on the surface to increase friction resistance for the prevention of slip between belt and pulley.



Type				Material		Hardness
Crowned		Crosspiece Groove Straight		Core	Lining	
No Flange	Flanged	No Flange	Flanged	A5052	Urethane (Natural Color)	Shore A90 Shore A70
RWCUN	RWCUF	RWMUN	RWMUF			
RWCGN	RWCGF	RWMGN	RWMGF			

6.3 / (1.6 /)

Urethane is heat-bonded on the outer circumference of the core material.

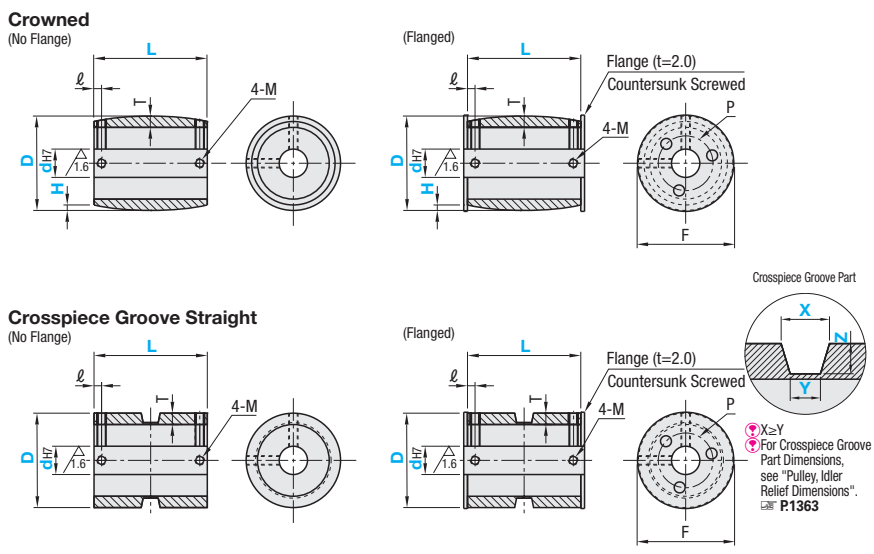

RoHS10

Part Number Type	D	dH7	1mm Increment L	H Selection Crowned Type only	1mm Increment			T	M	ℓ	F	P							
					X	Y	Z												
Crowned (No Flange) RWCUN RWCGN (Flanged) RWCUF RWCGF	15	8	Crowned 25-100	0.3	-	-	-	2	M4	4.5	-	-							
	20	8						2			-	-							
	25	10						3			-	-							
	30	8						3			M4	4.5	31	19					
	30	10											-	-					
	30	12											-	-					
	30	10											36	24					
	35	12						Crosspiece Groove Straight 50-100			0.5	7-15	5-12	4-5	6	M5	5	51	33
	40	10													6			41	23
	40	15													6			-	-
50	12	6	M6	5.5	61	39													
50	15						8		61	39									
50	20						8		81	59									
50	25						8		M8	7					81			59	
60	20																		
80	25																		
80	30																		
80	35																		

Flanged Type is applicable to * marked d dimensions only. Urethane may discolor over time, but there is no effect on properties.

Ordering Example

Crowned
 Part Number - d - L - H
 RWCUN30 - 10 - 62 - H0.3

Crosspiece Groove Straight
 Part Number - d - L - X - Y - Z
 RWMGF40 - 15 - 82 - X7 - Y6 - Z5

D	Unit Price											
	Crowned Shore A90						Crowned Shore A70					
	RWCUN	L51	L76	RWCUF	L51	L76	RWCGN	L51	L76	RWCGF	L51	L76
15	L25 ~50	L76 ~75	L100 ~100									
20												
25												
30												
35												
40												
50												
60												
80												

D	Unit Price										
	Crosspiece Groove Straight Shore A90				Crosspiece Groove Straight Shore A70						
	RWMUN	L50	L76	RWMUF	L50	L76	RWMGN	L50	L76	RWMGF	
40	L50 ~75	L76 ~100		L50 ~75	L76 ~100		L50 ~75	L76 ~100		L50 ~75	L76 ~100
50											
60											
80											