

Slide Tapes / Strong Double-Sided Tapes / Guide Rails

Slide Tapes

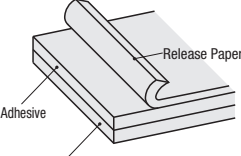

NLTP



Release Paper
Adhesive
Base Material (Ultra High-Molecular-Weight Polyethylene)
Heat Resistance Temperature: -30~80°C Color: Milky White

Part Number	Base Material Thickness	Tape Width	Tape Length	Unit Price	
				1 ~ 4 pc(s)	5~20 pcs.
NLTP 1320	0.13	20	40m		
NLTP 1330		30			
NLTP 1340		40			
NLTP 1350	0.5	50	20m		
NLTP 5020		20			
NLTP 5030		30			
NLTP 5040		40			
NLTP 5050		50			

For orders larger than indicated quantity, please check with WOS.

Strong Double-Sided Tapes



RMT

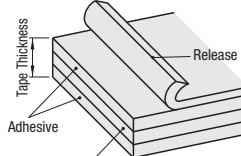

Release Paper
Adhesive
Base Material (Polyester)
Heat Resistance Temperature: -40~70°C

Part Number	Tape Thickness	Tape Width	Tape Length	Unit Price	
				1 ~ 4 pc(s)	5~20 pcs.
RMT3310	0.33	10	20m		
RMT3315		15			
RMT3320		20			
RMT3325		25			
RMT3330		30			
RMT3335		35			
RMT3340		40			

For orders larger than indicated quantity, please check with WOS.

Ordering Example

Part Number
NLTP1320

Dynamic Friction Coefficient (Reference Value)

	Dry		Water Lubricated	
	UHMWPE	Nylon 6	Nylon 66	Fluororesin
UHMWPE	0.07~0.22	0.15~0.40	0.15~0.40	0.04~0.25
Nylon 6	0.15~0.40	0.15~0.35	0.14~0.19	0.14~0.19
Nylon 66	0.15~0.40	0.14~0.19	0.14~0.19	0.04~0.08
Fluororesin	0.04~0.25	0.10~0.20	0.10~0.20	
Polyacetal	0.15~0.35			

Cautions on the Usage of Tape

- Remove contamination including dust, grease and water.
- Some materials have low adhesion properties.
- NLTP attached 1 or 2 days prior to assembly will have higher bonding strength.
- RMT bonds well to ultra high-molecular-weight polyethylene (UHMWPE).

Referential Adhesive Strength (NLTP) (Unit: N/20mm Width)

Taped Subject	Base Material Thickness 0.13	Base Material Thickness 0.5
SUS304	9.8	8.8
Polyvinyl Chloride Resin	18.6	18.6

Referential Adhesive Strength (RMT)

Taped Subject	21.6N
SUS304	

(Test Method) 180° Peeling Test: Temperature: 23°C, Peeling Speed: 300mm/min

Guide Rails



RoHS 10

Type	M Material	S Surface Treatment
SGL	SS400D	(Black)
SGLM		Electroless Nickel Plating

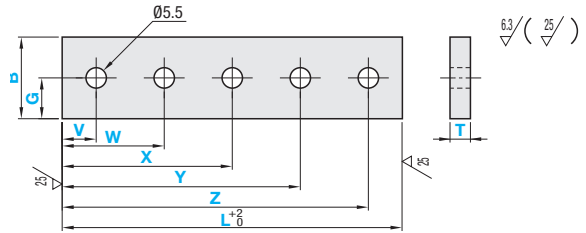

Part Number	H (Number of Holes)	B Selection	T Selection	L 1mm Increment	G, V, W, X, Y, Z 0.5mm Increment
SGL SGLM	N (No Hole)	22 25 32 38	3 5 6 10	50~1000	5~995
	2H				
	3H				
	4H				
	5H				

When N is selected, no hole will be machined.

Ordering Example

Part Number: B - T - L - G - V - W - X - Y - Z

SGL N - 22 - 3 - 300
SGLM 5H - 25 - 5 - 800 - G14 - V15 - W265 - X480 - Y600 - Z785

(Non-Hole Machined) Type Body Price (The body price of SGLM is calculated by adding the price in the table to the SGL price.)

Type	B	L 1mm Increment	Body Price				Body Price
			T				SGLM
			3	5	6	10	Added Price (SGL+)
SGL	22	50~200					
		201~400					
		401~600					
		601~800					
		801~1000					
	32	50~200					
		201~400					
		401~600					
		601~800					
		801~1000					

EX Example

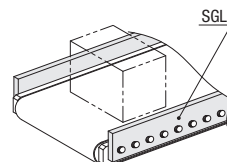

Hole Machining Charge

With Hole Machining Type	Hole Machining Charge
2H	
3H	
4H	
5H	

The price of the Hole Machined Type is the body price plus the hole machining charge.

(Ex.) Part Number: B - T - L - G - V - W
SGL2H - 25 - 5 - 50 - G13 - V15 - W35

(Body Price) + (Hole Machining Charge) = Hole Machined Type Unit Price

Volume Discount Rate is not applicable to hole machining charge.