

# Silicon Rubber / Urethane Molded Bearings

## Threaded Flat

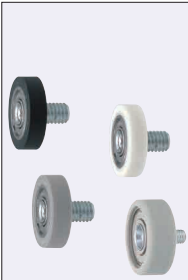

Type Flat		M Material	H Hardness	Color	Bearing	Shaft		
Standard Threaded	Long Threaded					M Material	S Surface Treatment	
UMBKH	UMBKT	Urethane	Shore A95	Black	SUJ2 SUS440C	SUM SUS303	Electroless Nickel Plating	
UMSBKH	UMSBKT			White	SUJ2 SUS440C	SUM SUS303	Electroless Nickel Plating *1	
UMBKWH	UMBKWT			Black	SUJ2 SUS440C	SUM SUS303	Electroless Nickel Plating	
UMSBKWH	UMSBKWT			White	SUJ2 SUS440C	SUM SUS303	Electroless Nickel Plating *1	
UMBH	UMBT			Shore A90	Black	SUJ2 SUS440C	SUM SUS303	Electroless Nickel Plating
UMSBH	UMSBT			Shore A90	White	SUJ2 SUS440C	SUM SUS303	Electroless Nickel Plating *1
UMBWH	UMBWT	Silicon Rubber	Shore A70	Black	SUJ2 SUS440C	SUM SUS303	Electroless Nickel Plating	
UMSBWH	UMSBWT			Black	SUJ2 SUS440C	SUM SUS303	Electroless Nickel Plating	
UMBGH	-			White	SUJ2 SUS440C	SUM SUS303	Electroless Nickel Plating *1	
UMBLH	-			SUJ2	SUM	SUM	Electroless Nickel Plating	
UMBLWH	UMBLWT			SUJ2	SUM	SUM	Electroless Nickel Plating *1	
SUMBH	SUMBT			SUS440C	SUS303	SUS303	Electroless Nickel Plating	
SUMBWH	SUMBWT	Artistic (Antistatic Resin)	Shore A90	Light Gray	SUJ2	SUM	Electroless Nickel Plating	
UMBDH	UMBDT			Gray	SUJ2	SUM	Electroless Nickel Plating	

Shape A

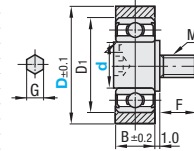

Shape B

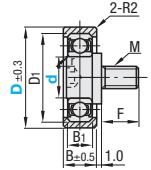

Bearing Accuracy JIS B 1514, 0 Class

\*1 Surface treatment is changed from Trivalent Chromate to Electroless Nickel Plating.

⚠ No undercutting on threads.

### Shape A

Part Number	Type	d	D	M (Coarse)	F	Allowable Load N (kgf)					B	D <sub>1</sub>	r (min.)	G	Used Bearing	
						Urethane										Silicon
						Shore A95	Shore A90	Shore A70	Shore A50	Shore A70						B
Standard Threaded	UMBKH	3	10	M3	4	6	38(3.8)	28(2.8)	9(0.9)	4(0.4)	7(0.7)	3	7	0.1	W683ZZA	
		3	12			53(5.4)	34(3.5)	10(1)	6(0.6)	9.8(1)	4	9	0.15	W684V50ZZ		
Long Threaded	UMBKT	4	13	M4	5	8	66(6.7)	44(4.5)	13(1.3)	7(0.7)	13(1.3)	4	9	0.15	W684V50ZZ	
		4	16			79(8.1)	59(6)	16(1.6)	6(0.6)	18(1.8)	5	13	0.2	624ZZ		
Standard Threaded	UMSBKH	5	16	M4	5	8	79(8.1)	59(6)	16(1.6)	6(0.6)	18(1.8)	5	16	0.3	WBC5-13ZZ	
		5	20			102(10.4)	78(8)	20(2)	9(0.9)	24(2.4)	5	16	0.3	625ZZ		
Long Threaded	UMSBKT	6	20	M6	8	12	114(11.7)	78(8)	23(2.3)	15(1.5)	24(2.4)	6	19	0.2	696ZZ	
		6	28			218(22.2)	157(16)	44(4.5)	39(4)	47(4.8)	6	19	0.2	626ZZ		
Standard Threaded	UMSBKWH	8	28	M6	8	12	208(21.2)	157(16)	42(4.3)	35(3.6)	47(4.8)	7	22	0.3	608ZZ	
		8	30A			-	176(18)	81(8.3)	65(6.7)	53(5.4)	7	22	0.3	608ZZ		
Long Threaded	UMSBKT	10	30A	M10	12	20	-	176(18)	94(9.6)	51(5.2)	53(5.4)	8	26	0.3	6000ZZ	
		10	40A			-	176(18)	136(13.9)	93(9.5)	53(5.4)	8	26	0.3	6200ZZ		
Standard Threaded	UMBH	15	40A	M10	12	20	-	274(28)	122(12.4)	96(9.9)	82(8.4)	9	30	0.6	6200ZZ	
		15	45A			-	274(28)	109(11.1)	102(10.5)	103(10.5)	9	32	0.3	6002ZZ		
Long Threaded	UMSBT	20	45A	M10	12	20	-	343(35)	130(13.3)	98(10.1)	103(10.5)	11	35	0.6	6202ZZ	
		20	55A			-	343(35)	130(13.3)	98(10.1)	103(10.5)	9	37	0.3	6904ZZ		
Standard Threaded	UMSBWH	25	55A	M10	12	20	-	490(50)	225(22.9)	176(18.1)	147(15)	14	47	1	6204ZZ	
		25	65A			-	490(50)	225(22.9)	176(18.1)	147(15)	14	47	1	6205ZZ		

⚠ Only d4 ~ 8 are available for \* marked types.

⚠ See price chart for available sizes.

⚠ Allowable load is for reference.



Ordering Example Part Number - D  
UMBH10 - 30A

⚠ For bearing detailed dimensions, see P989.

### Shape B

Part Number	Type	d	D	M (Coarse)	F	Allowable Load N (kgf)					B	D <sub>1</sub>	B <sub>1</sub>	r (min.)	G	Used Bearing	
						Urethane											Silicon
						Shore A95	Shore A90	Shore A70	Shore A50	Shore A70							B
Standard Threaded	UMBKH	8	30	M6	8	12	248(25.3)	176(18)	81(8.3)	65(6.7)	53(5.4)	11	22	7	0.3	4	608ZZ
		8	30			201(20.5)	176(18)	94(9.6)	51(5.2)	53(5.4)	11	26	8	0.3	6000ZZ		
Long Threaded	UMBKT	10	40	M10	12	20	412(42)	274(28)	136(13.9)	93(9.5)	82(8.4)	12	32	9	0.3	5	6200ZZ
		10	40			369(37.6)	274(28)	122(12.4)	96(9.9)	82(8.4)	12	32	9	0.3	6002ZZ		
Standard Threaded	UMSBKH	15	45	M10	12	20	534(54.5)	343(35)	109(11.1)	102(10.5)	103(10.5)	15	35	11	0.6	6202ZZ	
		15	45			391(39.9)	343(35)	130(13.3)	98(10.1)	103(10.5)	12	37	9	0.3	6904ZZ		
Long Threaded	UMSBKT	20	55	M10	12	20	674(68.7)	490(50)	225(22.9)	176(18.1)	147(15)	18	47	14	1	8	6204ZZ
		20	55			999(101.9)	750(70)	333(34)	250(25.8)	226(23)	19	52	15	1	10	6205ZZ	

⚠ See price chart for available sizes.

⚠ Allowable load is for reference.



Alterations Part Number - D - (DC)  
UMBH6 - 20 - DC18

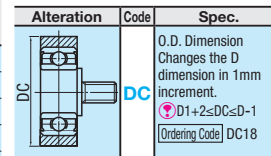

Alteration	Code	Spec.
DC	DC	O.D. Dimension Changes the D dimension in 1mm increment. ⚠ D1 + 2 ≤ DC ≤ D - 1 Ordering Code DC18

Properties of Antistatic Urethane		
Item	Unit	UMBH, UMBDT
Specific Volume Resistivity	Ω·cm	2.1x10 <sup>8</sup>
Surface Resistivity	Ω	4.0x10 <sup>8</sup>

⚠ Test Conditions (Temperature 30°C / Humidity 60%)

⚠ Listed values are not guaranteed values but an example of measured values.

d	D	Unit Price											
		Urethane (Shore A95)		Urethane (Shore A90)				Urethane (Shore A70)	Urethane (Shore A50)	Silicon Rubber (Shore A70)		Artistic Urethane (Shore A90)	
		Steel Bearing	Stainless Steel Bearing	Steel Bearing	Stainless Steel Bearing			Steel Bearing	Steel Bearing	Stainless Steel Bearing	Steel Bearing		
		UMBKH	UMSBKH	UMBH	UMSBH	UMSWH	UMSBT	UMSWT	UMBGH	UMBLH	SUMBH	SUMSBH	UMBDH
		UMSBKT	UMSBKT	UMSBT	UMSBT	UMSBT	UMSBT	UMSBT	UMBLWH	UMBLWT	SUMBT	SUMSBT	UMBDT
		UMBKWT	UMSBKWT	UMBWT	UMSBWT	UMSWWT	UMSBWT	UMSWWT	UMBLWT	UMBLWT	SUMBWT	SUMSBWT	UMBDWT
3	10	-	-	-	-	-	-	-	-	-	-	-	-
3	12	-	-	-	-	-	-	-	-	-	-	-	-
4	13	-	-	-	-	-	-	-	-	-	-	-	-
4	16	-	-	-	-	-	-	-	-	-	-	-	-
5	16	-	-	-	-	-	-	-	-	-	-	-	-
5	20	-	-	-	-	-	-	-	-	-	-	-	-
6	20	-	-	-	-	-	-	-	-	-	-	-	-
6	28	-	-	-	-	-	-	-	-	-	-	-	-
8	28	-	-	-	-	-	-	-	-	-	-	-	-
8	30	-	-	-	-	-	-	-	-	-	-	-	-
8	30A	-	-	-	-	-	-	-	-	-	-	-	-
8	30	-	-	-	-	-	-	-	-	-	-	-	-
10	40	-	-	-	-	-	-	-	-	-	-	-	-
10	30A	-	-	-	-	-	-	-	-	-	-	-	-
10	40A	-	-	-	-	-	-	-	-	-	-	-	-
15	40	-	-	-	-	-	-	-	-	-	-	-	-
15	45	-	-	-	-	-	-	-	-	-	-	-	-
15	40A	-	-	-	-	-	-	-	-	-	-	-	-
15	45A	-	-	-	-	-	-	-	-	-	-	-	-
20	45	-	-	-	-	-	-	-	-	-	-	-	-
20	55	-	-	-	-	-	-	-	-	-	-	-	-
20	45A	-	-	-	-	-	-	-	-	-	-	-	-
20	55A	-	-	-	-	-	-	-	-	-	-	-	-
25	65	-	-	-	-	-	-	-	-	-	-	-	-
25	65A	-	-	-	-	-	-	-	-	-	-	-	-