

Rollers

Straight with Keyway

■ **Features:** 5th business day shipping is available for shaft bore with keyway machining and Urethane Lined.



L Selectable				Urethane Thickness Selectable				M Material		Hardness
Straight	Tapped	Straight	Tapped	Straight	Tapped	Core	Lining			
ROUSK	ROUSKN	ROEUSK	ROEUSKN	SUS304		Aluminum Alloy		Urethane (Natural Color)	Shore A90	
ROUAK	ROUAKN	ROEUAK	ROEUAKN	Aluminum Alloy					Shore A70	
ROGSK	ROGSKN	ROEGSK	ROEGSKN	SUS304					Shore A50	
ROGAK	ROGAKN	ROEGAK	ROEGAKN	Aluminum Alloy						
ROHSK	ROHSKN	ROEHSK	-	SUS304						
ROHAK	ROHAKN	ROEHAK	ROEHAKN	Aluminum Alloy						

When $L \leq dx3$, hole d is machined from the same direction.
 When $L > dx3$, hole d is machined from both ends as shown below. There may be no relief in some cases.

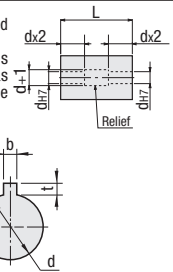

■ **Keyway Dimensions**

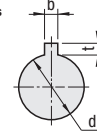

Urethane is baked on the outer circumference of the core material.

6.3 (1.6)

Straight

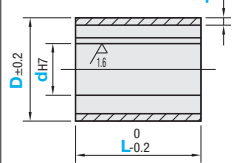

Tapped

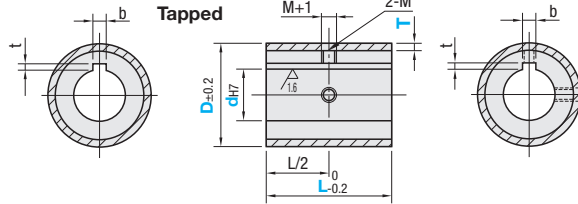

Shaft Hole Dia.	d	Reference Dim.	b	Tolerance (JS9)	Reference Dim.	t	Tolerance (JS9)
8	8	3	±0.0125	1.4			
10	10	4	±0.0150	1.8			+0.1
12	12	5	±0.0150	2.3			0
15	15	6	±0.0180	2.8			
20	20	8	±0.0180	3.3			+0.2
25	25						0
30	30						

■ **L Selectable**

Part Number		D	dh7 Selection					L Selection										T	M
Type	Type		20	8	10	12	15	15	20	25	30	40	50	60	70	80	90		
Straight	Tapped	20	8	10	12	15	15	20	25	30	40	50	60	70	80	90	100	3	3
ROUSK	ROUSKN	25	8	10	12	15	15	20	25	30	40	50	60	70	80	90	100		
ROUAK	ROUAKN	30	8	10	12	15	15	20	25	30	40	50	60	70	80	90	100		
ROGSK	ROGSKN	35	10	12	15	20	20	25	30	40	50	60	70	80	90	100			
ROGAK	ROGAKN	40	10	12	15	20	20	25	30	40	50	60	70	80	90	100			
ROHSK	ROHSKN	50	12	15	20	25	25	30	40	50	60	70	80	90	100	4	4		
ROHAK	ROHAKN						25	30	40	50	60	70	80	90	100				

■ **Urethane Thickness Selectable**

Part Number		D	dh7 Selection				L	T Selection	M
Type	Type		10	12	15	20			
Straight	Tapped	50	10	12	15	30~100	5	5	
ROEUSK	ROEUSKN	60	12	15	20				
ROEUAK	ROEUAKN	80	15	20	25				
ROEGSK	ROEGSKN	100	20	25	30				
ROEGAK	ROEGAKN								
ROEHSK	ROEHSKN					6	6		
ROEHAK	ROEHAKN								



Ordering Example: Part Number - d - L - T
 ROUSK20 - 8 - 30
 ROGSKN30 - 12 - 40
 ROEUSK80 - 20 - 50 - T5



Alterations: Part Number - d - L - T - (UDC, LC)
 ROUSK20 - 8 - 30 - UDC
 ROEUSK80 - 20 - 50 - T5 - LC29
 ROUAK30 - 10 - 30 - LC29

Alterations	Code	Spec.
Change to Antistatic Urethane (Urethane Color: Gray)	UDC	Change Urethane Shore A90 to Antistatic Urethane Change to Urethane [Ordering Code] UDC Specific Volume Resistivity 2.1x10 ¹⁰ -cm Surface Resistivity 4.0x10 ¹⁰ Ω (Temperature 30°C / Humidity 60%)
L Dimension	LC	[Ordering Code] LC11 LC=1mm Increment 10 ≤ LC < L Only applicable to L Selectable Types.

■ **L Selectable**

D	L	Unit Price					
		Straight - Tapped For Tapped Type, add to the prices shown below.					
		ROUSK (ROUSKN)	ROUAK (ROUAKN)	ROGSK (ROGSKN)	ROHSK (ROHSKN)	ROGAK (ROGAKN)	ROHAK (ROHAKN)
20	15-25						
20	30-50						
20	60-100						
25	15-25						
25	30-50						
25	60-100						
30	15-25						
30	30-50						
30	60-100						
35	20-25						
35	30-50						
35	60-100						
40	20-25						
40	30-50						
40	60-100						
50	25						
50	30-50						
50	60-100						

■ **Urethane Thickness Selectable**

D	L	Unit Price					
		Straight - Tapped For Tapped Type, add to the prices shown below.					
		ROEUSK (ROEUSKN)	ROEUAK (ROEUAKN)	ROEGSK (ROEGSKN)	ROEGAK (ROEGAKN)	ROEHSK (ROEHSKN)	ROEHAK (ROEHAKN)
50	30-50						
50	60-100						
60	30-50						
60	60-100						
80	30-50						
80	60-100						
100	30-50						
100	60-100						

Urethane may discolor over time, but there is no effect on physical properties.