

Oldham Couplings

Large Shaft Diameter, Set Screw / Clamping / Spacers

■ **Features:** Large tolerance for lateral and angular misalignments covers up to Ø38 max. shafts.



RoHS 10

■ Set Screw

MFJ (Standard Bore)

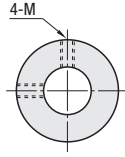
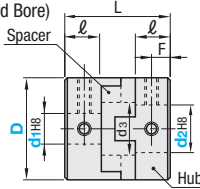

MFJWK (Keywayed Bore d1, d2)

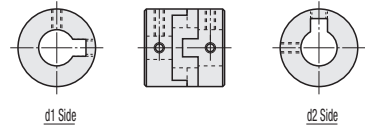

■ Clamping

MFJC (Standard Bore)

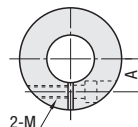
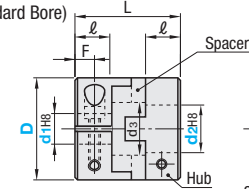

MFJCLK (Keywayed Bore d1)

MFJCRK (Keywayed Bore d2)

MFJCWK (Keywayed Bore d1, d2)

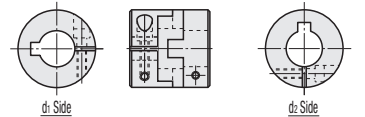

- Operating Temperature: -20°C ~ 80°C
- Tolerances for d1 and d2 are values before slit machining.
- The lateral, angular, and axial misalignment values shown are for each occurring individually. When multiple misalignments are occurring simultaneously, the allowable maximum value of each will be reduced to 1/2.
- When multiple misalignments are occurring simultaneously, the allowable maximum value of each will be reduced to 1/2.

For Keyway dimensions, see P1092

Shape	Standard Bore	Keywayed Bore			Material	Spacer	Accessory
		d1 (One Side)	d2 (One Side)	d1, d2 (Both Sides)			
Set Screw	MFJ	-	-	MFJWK	Aluminum Alloy	Polyacetal	Set Screw
Clamping	MFJC	MFJCLK	MFJCRK	MFJCWK			Set Screw Hub Side Seal Cap Screw

For the selection criteria and alignment procedures, see P1061

■ Set Screw

Part Number	Type	D	d1, d2 Selection (d1 ≤ d2)						d3	L	l	F	Set Screw		Unit Price	
			14	15	16	18	20	22					M	Tightening Torque (N·m)	MFJ	MFJWK
MFJ MFJWK		44	14	15	16	18	20	22	22.5	46	15	7.5	M 6	7.0		
			55	18	20	22	25	26	28	57	19	9.5	M 8	15.0		
			70	22	25	28	30	35	38	39	77	25	12.5	M10	30.0	

■ Clamping

Part Number	Type	D	d1, d2 Selection (d1 ≤ d2)						d3	L	l	F	A	Clamp Screw		Unit Price		
			14	15	16	18	20	22						M	Tightening Torque (N·m)	MFJC	MFJCLK MFJCRK	MFJCWK
MFJC MFJCLK MFJCRK MFJCWK		44	14	15	16	18	20	22.5	46	15	7.5	14.5	M5	*8.4				
			55	18	20	22	25	28	57	19	9.5	17	M6	*14.4				
			70	22	25	28	30	35	39	77	25	12.5	24	M8	*30.0			

* When the shaft diameter is small, clamp screw tightening torque should be higher than the prescribed value to prevent shaft slipping. The above tightening torque is for reference.

Part Number	Type	D	Allowable Torque (N·m)	Angular Misalignment (°)	Lateral Misalignment (mm)	Static Torsional Spring Constant (N·m/rad)	Max. Rotational Speed (r/min)	Moment of Inertia (kg·m²)	Allowable Misalignment (mm)	Mass (g)	
Set Screw MFJ MFJWK	Clamping MFJC MFJCLK MFJCRK MFJCWK	44	30	26	1	1500	12000	4 × 10 ⁻⁵	±0.5	140	
		55	45	40	2	1.5	2800	10000	11 × 10 ⁻⁵	±0.6	260
		70	80	72	2	4800	8000	40 × 10 ⁻⁵	±0.8	450	

The allowable torque varies depending on temperature P1062

Ordering Example: Part Number MFJ44 - Shaft Dia. d1 - 15 - Shaft Dia. d2 - 20 MFJCWK70 - 22 - 35 - KLH8

Alterations: Part Number MFJ55 - LDC19.5 - RDC21 - KLH, KRH, LK, RK MFJCWK70 - 22 - 35 - KLH8

Alterations	Shaft Bore Dia.		Keyway Width		Keyway																								
	LDC (Left Shaft)	RDC (Right Shaft)	KLH (Left Shaft)	KRH (Right Shaft)	LK (Left Shaft)	RK (Right Shaft)																							
Spec.	<p>0.1mm Increment Ordering Code: LDC19.5, RDC21 Values in () are for Clamping Type.</p>		<p>Keyway Width (b) is changed as the table below.</p> <table border="1"> <thead> <tr> <th>Shaft Bore Dia. d1, d2</th> <th>Reference Dia.</th> <th>Tolerance</th> <th>Reference Dia.</th> <th>Tolerance</th> </tr> </thead> <tbody> <tr> <td>22</td> <td>8</td> <td>±0.0180</td> <td>3.3</td> <td>+0.2</td> </tr> <tr> <td>30</td> <td>10</td> <td></td> <td></td> <td></td> </tr> </tbody> </table> <p>Cannot be combined with shaft bore change (LDC, RDC) alterations. Applicable to Keywayed Bore only.</p>		Shaft Bore Dia. d1, d2	Reference Dia.	Tolerance	Reference Dia.	Tolerance	22	8	±0.0180	3.3	+0.2	30	10				<p>Ordering Code: LK5, RK8 Shaft Dia. d1, d2 LK, RK</p> <table border="1"> <tbody> <tr> <td>14~17</td> <td>5</td> </tr> <tr> <td>17~22</td> <td>6</td> </tr> <tr> <td>22~30</td> <td>8</td> </tr> <tr> <td>30~38</td> <td>10</td> </tr> </tbody> </table> <p>For Keyway dimensions, see P1092</p>		14~17	5	17~22	6	22~30	8	30~38	10
	Shaft Bore Dia. d1, d2	Reference Dia.	Tolerance	Reference Dia.	Tolerance																								
22	8	±0.0180	3.3	+0.2																									
30	10																												
14~17	5																												
17~22	6																												
22~30	8																												
30~38	10																												
Code	LDC (Left Shaft)	RDC (Right Shaft)	KLH (Left Shaft)	KRH (Right Shaft)	LK (Left Shaft)	RK (Right Shaft)																							

■ Spacers (for MFJ□□, MFJC□□)

MFJS

Material: Polyacetal

Part Number	Type	D1	T	d3	W	G	Applicable Coupling	Unit Price
MFJS	44	44.3	14	22.5	10.4	9	MFJ□□44 MFJC□□44	
	55	55	17	28	13	11	MFJ□□55 MFJC□□55	
	70	69	25	39	15	16.5	MFJ□□70	
							MFJC□□70	

Ordering Example: Part Number MFJS70