

Miniature Cam Followers

Miniature Cam Followers



RoHS10

Application	Type	Material	Accessory
General	CFFAN	SUJ2 (Stud: SCM415)	1 Hex Nut (S45C Carbon Steel, Black Oxide)
	CFFAM	SUS440C Equivalent	Hex Nut 1 pc. (SUS304)
Low Dust Generation	CFFAMC	SUJ2 (Stud: SCM415)	1 Hex Nut (S45C Carbon Steel, Black Oxide)
Heavy Load	CFFANG	SUS440C Equivalent	Hex Nut 1 pc. (SUS304)
	CFFAMG	SUS440C Equivalent	Hex Nut 1 pc. (SUS304)

Operating Temp.: 80°C or lower

General, Low Particle Generation

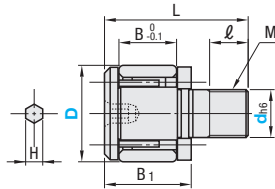

Heavy Load Full Roller for Heavy Load

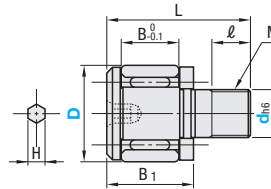

Note: Thread diameter of Miniature Cam Follower is small. To prevent damage, use torque wrench and secure within the maximum tightening torque. (Please note that the maximum tightening torque for a miniature cam follower is about one-fourth of that of the conventional equivalents.)

General, Low Particle Generation

Type	Part Number		D Selectable	MxPitch	ℓ	B	B ₁	L	H		Basic Load Rating				Max. Allowable Load (N)	Track Load Capacity (N)	Max. Rotational Speed (rpm)	Mass (g)	Max. Tightening Torque (N·cm)	Unit Price								
	d _{h6} Tolerance	Type							Steel	Stainless Steel	Steel	Stainless Steel	Steel	Stainless Steel						Cr (Dynamic) N	Cor (Static) N	Steel	Stainless Steel	Steel	Stainless Steel	CFFAN	CFFAM	CFFAMC
CFFAN (General, Steel)	2.5	5	0	2.5x0.45	2.5	3	4.5	9.5	0.9	0.9	410	350	335	285	285	3360	1	16										
	3		-0.006	6	3x0.5	3	4	5.5	11.5	1.5	1.3	630	565	610	525	525	2800	2	28									
CFFAM (General)	4	8	0	4x0.7	4	5	7	15	2	1.5	1080	915	1080	915	915	2100	4	64										
	5		-0.008	10	5x0.8	5	6	8	18	2.5	2	1570	1340	1860	1400	1400	1680	7	125									
CFFAMC (Low Dust Generation)	6	12	0	6x1.0	6	7	9.5	21.5	3	2.5	2060	1880	2160	2040	2040	1700	1400	13	226									

kgf=Nx0.101972

Heavy Load (Full Rollers)

Type	Part Number		D Selectable	MxPitch	ℓ	B	B ₁	L	H		Basic Dynamic Load Rating				Max. Allowable Load (N)	Track Load Capacity (N)	Max. Rotational Speed (rpm)	Mass (g)	Max. Tightening Torque (N·cm)	Unit Price											
	d _{h6} Tolerance	Type							Steel	Stainless Steel	Steel	Stainless Steel	Steel	Stainless Steel						Cr (Dynamic) N	Cor (Static) N	Steel	Stainless Steel	Steel	Stainless Steel	Steel	Stainless Steel	Steel	Stainless Steel	CFFANG	CFFAMG
CFFANG (Heavy Load)	2.5	5	0	2.5x0.45	2.5	3	4.5	9.5	0.9	0.9	1000	665	1080	410	260	410	300	285	2000	1	16										
	3		-0.006	6	3x0.5	3	4	5.5	11.5	1.5	1.3	1370	1020	1770	590	360	590	480	470	1680	2	28									
CFFAMG (Heavy Load)	4	8	0	4x0.7	4	5	7	15	2	1.5	2350	1680	3040	1050	780	1050	770	795	1260	4	64										
	5		-0.008	10	5x0.8	5	6	8	18	2.5	2	3140	2520	4710	1640	1420	1640	1180	1210	1000	7	125									
	6	12	0	6x1.0	6	7	9.5	21.5	3	2.5	4610	3400	6270	2360	2110	2360	1540	1700	840	13	226										

kgf=Nx0.101972



Ordering Example

Part Number - **D**
CFFAM2.5 - 5