

Stainless Steel Small Ball Bearings

Double Shielded

⚠ This product can be used even when heavy load, high rotation speed, and high rotational accuracy are required. See **P.994** for the C-VALUE Product of this item.

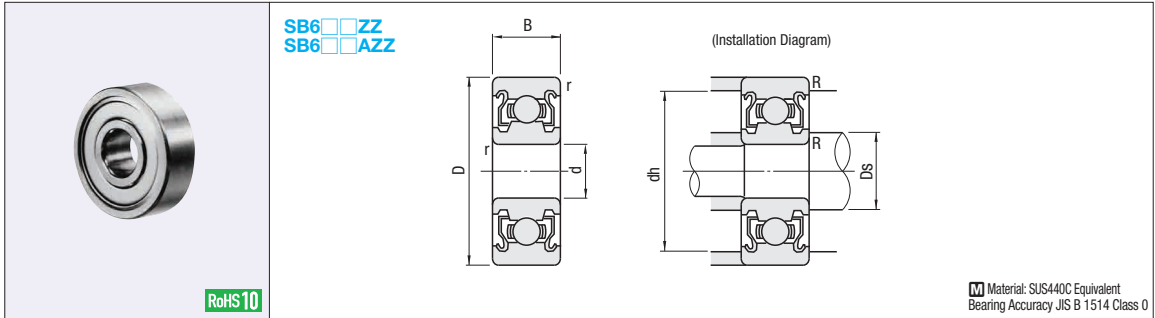

For details on the tolerance and allowable values of inner and outer rings, see **P.2243**

Part Number	d	D	B	r (min)	Basic Load Rating		Allowable Rotational Speed rpm (Reference)	Relative Dimensions			Mass (g) (Reference)	Unit Price
					Cr (Dynamic) N	Cor (Static) N		Ds (min)	dh (max)	R (max)		
SB682ZZ	2	5	2.3	0.08	143	40	85000	2.7	3.9	0.08	0.17	
SB692ZZ		6	3.0	0.15	281	79	75000	3.0	4.8	0.15	0.38	
SB602ZZ		7	3.5		328	102	60000	3.2	5.8		0.58	
SB682AZZ	2.5	6	2.6	0.08	178	59	71000	3.7	4.9	0.08	0.29	
SB692AZZ		7	3.5	0.15	328	102	63000	3.85	5.65	0.15	0.55	
SB673ZZ	3	6	2.5	0.1	178	59	71000	3.6	5.4	0.08	0.2	
SB683ZZ		7	3		331	104	63000	3.9	5.8	0.1	0.45	
SB693ZZ		8	4	0.15	474	144	60000	4.2	6.8	0.15	0.83	
SB603ZZ	9	5	485		151	56000	7.8		1.45			
SB623ZZ	10	4	536		175	50000	8.8		1.66			
SB633ZZ	4	13	5	0.2	1105	388	40000	4.6	11.4	0.2	3.33	
SB674ZZ		7	2.5	217	86	60000	6.4		0.08	0.28		
SB684ZZ		9	4	0.1	544	179	53000		5.0	7.8	0.1	1.01
SB694ZZ	11	0.15		607	220	48000	5.2	9.8	0.15	1.75		
SB604ZZ	4	12	5	0.2	813	276	40000	5.6	10.4	0.2	2.29	
SB624ZZ		13		1105	386	40000			11.4		3.04	
SB634ZZ		16	0.3	1139	418	36000			6	14	0.3	5.21
SB675ZZ	5	8	2.5	0.1	174	72	53000	5.8	7.4	0.1	0.34	
SB685ZZ		11	5	0.15	607	225	45000	6.2	9.8	0.2	1.96	
SB695ZZ		13	4	0.2	915	344	43000	6.6	11.4		2.5	
SB605ZZ		14	5	0.3	1105	404	40000	7	12.4	0.3	3.48	
SB625ZZ		16			1470	536	36000		14		4.86	
SB635ZZ		19	6	1986	708	32000	17	8.34				
SB676ZZ	6	10	3	0.1	396	174	45000	7.04	9.3	0.1	0.68	
SB686ZZ		13	5	0.15	918	352	40000	7.0	11.8	0.2	2.69	
SB696ZZ		15		1139	418	7.6		13.4	3.72			
SB606ZZ		17	6	0.3	1921	668		38000	15	6.08		
SB626ZZ		19			1986	708	32000	17	7.94			
SB636ZZ		22			7	2833	1138	30000	20	14.5		
SB678ZZ	8	12	3.5	0.1	434	219	40000	9.05	11.33	0.1	0.97	
SB688ZZ		16	5	0.2	1368	568	36000	9.6	14.4	0.2	4.02	
SB698ZZ		19	6	1901	728	17		7.18				
SB608ZZ		22	7	2799	1103	34000		20	12			
SB628ZZ		24	8	2833	1138	28000	22	17				
SB638ZZ		28	9	3879	1586		26	30.3				

⚠ kgf-Nx0.101972



Ordering Example

Part Number

SB636ZZ