

Hex

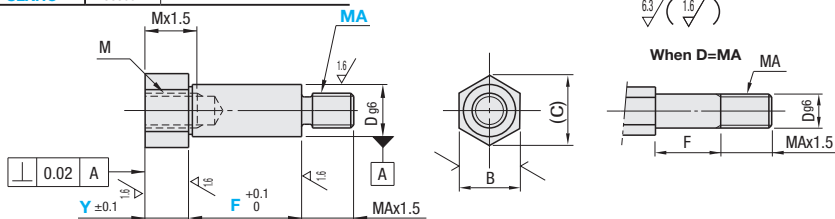

Type	M Material	S Surface Treatment
LXHC	S45C	Black Oxide
PLXHC	Equivalent	Electroless Nickel Plating
SLXHC	SUS304	-



- This type may have centering holes depending on dimensions.
- Please refer to Table 1 to specify dimensions Y and F.
- Refer to the table below for thread undercut dimensions.

Part Number Type	No.	D _{g6}	1mm Increment		MA (Coarse) Selection	M (Coarse)	B	(C)	Unit Price				
			Y	F					LXHC	PLXHC	SLXHC		
LXHC PLXHC SLXHC	6	6	2-60	5-100	4 5 6	M 3	8	9.2					
	8	8			5 6 8	M 4	10	11.5					
	10	10			6 8 10	M 6	13	15					
	12	12			6 8 10 12	M 8	14	16.2					
	13	13			8 10 12 (15)		17	19.6					
	15	15			10-100	10-100	10 12 (15) 16	M10	19	21.9			
	16	16	10 12 (15) 16 20	M12			24		27.7				
	17	17	10 12 (15) 16 20 24 (25)				M16	27	31.2				
	18	18	12 (15) 16 20 24 (25) 30	M12				32	36.9				
	20	20	4-60				4-60		M16				
	22	22						M12					
	25	25											
	25A	25											
	30	30											
	30A	30											

Table 1

M	Y+F
M3	Y+F ≥ 10
M4	Y+F ≥ 12
M6	Y+F ≥ 15.5
M8	Y+F ≥ 19.5
M10	Y+F ≥ 23.5
M12	Y+F ≥ 29.5
M16	Y+F ≥ 37
M20	Y+F ≥ 45

MA dimensions with () (M15 and M25) are Fine Thread. Specify MSC instead of MA.



Ordering Example

Part Number	Y	F	MA
FXHC12	5	F15	MA8
LXHC10	20	F35	MA6



Alterations

Part Number	Y	F	MA(MSC)	(YKC, WSC, APC)
FXHC15	20	F22	MSC15	APC

Alterations	Y Dimension Tolerance	Four Wrench Flats	Adds a Pilot	Fine Thread																																																																								
Code	YKC	WSC	APC	MSC																																																																								
Spec.	Changes Y dimension tolerance to ±0.05. Applicable to all types. Ordering Code: YKC	Changes from two wrench flats to four wrench flats. Applicable to Standard and Stepped Types. Ordering Code: WSC	Adds a pilot to the shaft seat. Applicable to all types. Ordering Code: APC <table border="1"> <thead> <tr> <th>D</th> <th>M</th> <th>APC g6</th> </tr> </thead> <tbody> <tr><td>6</td><td>M3</td><td>6</td></tr> <tr><td>8</td><td>M4</td><td>8</td></tr> <tr><td>10</td><td>M6</td><td>10</td></tr> <tr><td>12</td><td>M8</td><td>12</td></tr> <tr><td>13</td><td>M8</td><td>13</td></tr> <tr><td>15</td><td>M10</td><td>15</td></tr> <tr><td>16</td><td>M10</td><td>16</td></tr> <tr><td>17</td><td>M10</td><td>17</td></tr> <tr><td>18</td><td>M12</td><td>18</td></tr> <tr><td>20</td><td>M12</td><td>20</td></tr> <tr><td>22</td><td>M12</td><td>22</td></tr> <tr><td>25</td><td>M16</td><td>25</td></tr> <tr><td>25A</td><td>M12</td><td>25</td></tr> <tr><td>30</td><td>M20</td><td>30</td></tr> <tr><td>30A</td><td>M16</td><td>30</td></tr> </tbody> </table>	D	M	APC g6	6	M3	6	8	M4	8	10	M6	10	12	M8	12	13	M8	13	15	M10	15	16	M10	16	17	M10	17	18	M12	18	20	M12	20	22	M12	22	25	M16	25	25A	M12	25	30	M20	30	30A	M16	30	Changes Thread MA to Fine Thread in the table below. Applicable to all types. Specify MSC instead of MA. Ordering Code: MSC12 <table border="1"> <thead> <tr> <th>MSC</th> <th>Pitch</th> <th>MSC</th> <th>Pitch</th> </tr> </thead> <tbody> <tr><td>M4</td><td>0.5</td><td>M12</td><td>1.0</td></tr> <tr><td>M5</td><td>0.75</td><td>M15</td><td>1.0</td></tr> <tr><td>M6</td><td>1.0</td><td>M20</td><td>1.5</td></tr> <tr><td>M8</td><td>1.0</td><td>M25</td><td>1.5</td></tr> <tr><td>M10</td><td>1.0</td><td>M30</td><td>1.5</td></tr> </tbody> </table>	MSC	Pitch	MSC	Pitch	M4	0.5	M12	1.0	M5	0.75	M15	1.0	M6	1.0	M20	1.5	M8	1.0	M25	1.5	M10	1.0	M30	1.5
D	M	APC g6																																																																										
6	M3	6																																																																										
8	M4	8																																																																										
10	M6	10																																																																										
12	M8	12																																																																										
13	M8	13																																																																										
15	M10	15																																																																										
16	M10	16																																																																										
17	M10	17																																																																										
18	M12	18																																																																										
20	M12	20																																																																										
22	M12	22																																																																										
25	M16	25																																																																										
25A	M12	25																																																																										
30	M20	30																																																																										
30A	M16	30																																																																										
MSC	Pitch	MSC	Pitch																																																																									
M4	0.5	M12	1.0																																																																									
M5	0.75	M15	1.0																																																																									
M6	1.0	M20	1.5																																																																									
M8	1.0	M25	1.5																																																																									
M10	1.0	M30	1.5																																																																									

Thread Undercut Dimensions

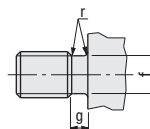

Coarse Thread				Fine Thread			
Thread Dia. (MA)	g	r	f	Thread Dia. (MSC)	g	r	f
4	1.2-1.5	0.2-0.3	2.9-3.2	4	1.2-1.5	0.2-0.3	2.9-3.2
5			3.9-4.1	5			3.9-4.1
6			4.3-4.9	6			4.3-4.9
8	1.5-2.5	0.2-0.6	6.3-6.6	8	1.5-2.5	0.2-0.6	6.3-6.6
10			8.1-8.3	10			8.1-8.6
12			9.8-10.1	12	1.5-3.0	0.2-1.0	9.8-10.7
16	1.5-3.0	0.2-1.0	13.6-13.8	15			13.6-13.8
20	1.5-4.0		17.0-17.2	20	1.5-4.0		17.2-18.8
24			20.2-20.7	25			20.2-23.2
30	2.5-5.0	0.2-1.5	26.0-26.2	30	2.5-5.0	0.2-1.5	26.2-28.2