

Cantilever Shafts

Screw Mount with Retaining Ring Groove

Standard



RoHS 10

Type	Material	Surface Treatment
FXHA	S45C Equivalent	Black Oxide
PFXHA		Electroless Nickel Plating
SFXHA	SUS304	-

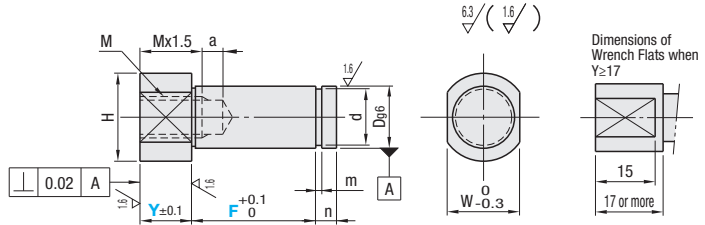

⚠ This type may have centering holes depending on dimensions.

Part Number Type	No.	D ₉₆	1mm Increment		M (Coarse)	H	W	d		m	n	Unit Price			
			Y	F				Ref. Dim.	Tolerance			FXHA	PFXHA	SFXHA	
FXHA PFXHA SFXHA	6	6	-0.004 -0.012	2-60	5-100	M 3	10	8	5	+0.075 0	0.7	2			
	6A						14	12							
	8	8	-0.005 -0.014			M 4	12	10	7	+0.090 0	0.9	3			
	8A						16	14							
	10	10	-0.006 -0.017			M 6	15	13	9.6	0 -0.090	1.15	4			
	10A						20	17							
	12	12	-0.007 -0.020			M 8	17	14	11.5	0 -0.110	1.35	5			
	13						18	15					12.4		
	15	15	-0.007 -0.020			M10	20	17	14.3	0 -0.210	1.65	5			
	16						21	18					15.2		
	17	17	-0.007 -0.020	M12	23	20	16.2	0 -0.210	1.65	5					
	18				23	20					17				
	20	20	-0.007 -0.020	M16	26	24	19	0 -0.210	1.65	5					
	20A				28	26					21				
	22	22	-0.007 -0.020	M16	31	27	23.9	0 -0.210	1.65	5					
	22A				36	32					28.6				
	25	25	-0.007 -0.020	M20	36	32	28.6	0 -0.210	1.65	5					
	25A														
	30	30	-0.007 -0.020	M16											
	30A														

M	a
M 3~M10	5
M12~M20	7

When (Mx1.5)+a ≥ Y+F, the pilot hole for M goes through.
When Mx1.5 ≥ Y+F, M also goes through.

Stepped



RoHS 10

Type	Material	Surface Treatment
FXJA	S45C Equivalent	Black Oxide
PFXJA		Electroless Nickel Plating
SFXJA	SUS304	-

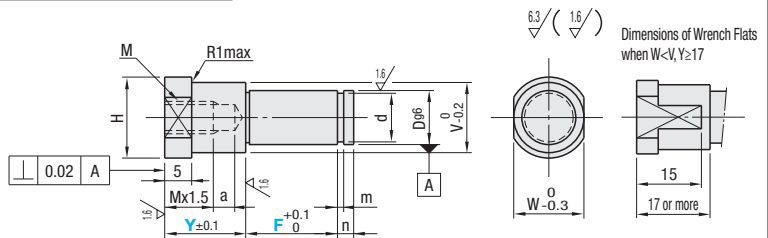

⚠ This type may have centering holes depending on dimensions.

Part Number Type	No.	D ₉₆	1mm Increment		M (Coarse)	a	V	H	W	d		m	n	Unit Price		
			Y	F						Ref. Dim.	Tolerance			FXJA	PFXJA	SFXJA
FXJA PFXJA SFXJA	6	6	-0.004 -0.012	7-60	5-100	M 3	8	10	8	5	+0.075 0	0.7	2			
	6A						12	14	12							
	8	8	-0.005 -0.014			M 4	10	12	10	7	+0.090 0	0.9	3			
	8A						14	16	14							
	10	10	-0.006 -0.017			M 6	13	15	13	9.6	0 -0.090	1.15	4			
	10A						18	20	17							
	12	12	-0.007 -0.020			M 8	15	17	14	11.5	0 -0.110	1.35	5			
	13						16	18	15					12.4		
	15	15	-0.007 -0.020			M10	18	20	17	14.3	0 -0.210	1.65	5			
	16						19	21	18					15.2		
	17	17	-0.007 -0.020	M12	20	23	20	16.2	0 -0.210	1.65	5					
	18				21	17	17									
	20	20	-0.007 -0.020	M12	24	26	24	19	0 -0.210	1.65	5					
	20A				26	28	26					21				
	22	22	-0.007 -0.020	M16	29	31	27	23.9	0 -0.210	1.65	5					
	22A				34	36	32					28.6				
	25	25	-0.007 -0.020	M20	34	36	32	28.6	0 -0.210	1.65	5					
	25A															
	30	30	-0.007 -0.020	M16												
	30A															

⚠ When W < V, wrench flats W reaches O.D.V. ⚠ When (Mx1.5)+a ≥ Y+F, the pilot hole for M goes through. When Mx1.5 ≥ Y+F, M also goes through.