

Rotary Shafts

End Shape Selectable



RoHS10

Type	Material	Surface Treatment
SFR□□	S45C Equivalent	Black Oxide
PSFR□□		Electroless Nickel Plating
SSFR□□		-

Base Shape (A Shape on Both Ends)

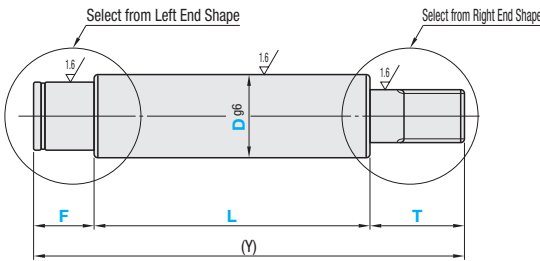
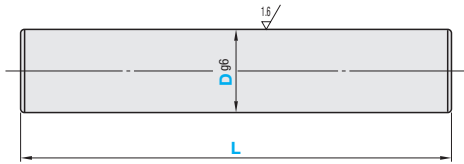

- ⊙ $(Y) \leq D \times 50$ is required for (Y) dimension.
- ⊙ When only one end needs to be machined, select A Shape for the other end.
- ⊙ When L dimension is less than the tap pilot hole depth, the pilot hole might go through.
- ⊙ H and J will not be symmetrical when applied to both ends of the shaft.
- ⊙ H and J may be out of phase with other alterations.

	Left End Shape	Right End Shape	Machining Conditions
A			-
B			For M3-8, M≤D-2 For M10-16, M≤D-3 For M20 or 24, M≤D-4 For M30, M≤D-5
C			P(Q)=M(N) Specify M(N) Dimension. Specification of P(Q) dimension is not required.
D			-
E			For M3-8, M(N)≤P(Q)-2 For M10-16, M(N)≤P(Q)-3 For M20 or 24, M(N)≤P(Q)-4 For M30, M(N)≤P(Q)-5
F			For dimensions of retaining ring grooves (m, d), see P820 . D dimension 27, 31, 33, 34, 36, 37, 38, 39, 41, 42, 43, 44, 46, 47, 48 or 49 cannot be specified.
G			
H			For details of hex socket dimensions, see P820 . Applicable when D≤30.
J			R(W)-M(N)≥t D-R-M≥2 D-W-N≥2 M(N) tmin 4- 5 0.8 6-12 1.0 Tap Depth Mx2 Nx2

Type	Part Number		1mm Increment	0.1mm Increment	1mm Increment			Selection	1mm Increment	C
	Left End Shape	Right End Shape			D	L	F, T			
SFR	A	A	6-50	20.0-800.0 (L≤Dx50)	2≤F≤Px5 2≤T≤Qx5	When M, N≤10 2≤B≤Mx3 2≤S≤Nx3	When D, P, Q≤6 2≤H, U	D/3≤P, Q<D	3 4 5 6 8 10 12 16 20 24 30	D≥M+4+R D≥N+4+W R≥M+3 W≥N+3
PSFR	B	B				When M, N≥12 2≤B≤Mx3 2≤S≤Nx3	When 6<D, P, Q≤10 3≤H, U			
	C	C				& B≤F-3 S≤T-3	When 10<D, P, Q≤20 4≤H, U			
	D	D					When 20<D, P, Q 5≤H, U			
	E	E								
SSFR	F	F								

⊙ For D Dimension, 31, 37, 39, 41-44 or 46-49 cannot be specified.