

Cable Carriers

Flap Open-Close Full Cover Type

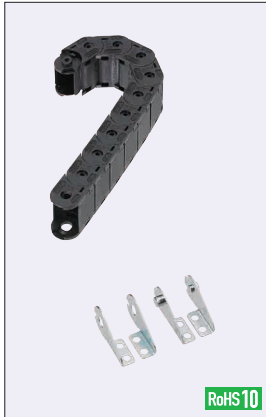

RoHS10

Type	FHPS	Main Body		Mounting Bracket	
		Material	Material	Surface Treatment	
Cable Carrier + Mounting Bracket	FHPS	Nylon 6 + Glass Fiber 20% (Operating Temperature -10 ~ 80°C) Flammability Standard UL94-HB Equivalent	SPCC	Trivalent Bright Chromate Plating	

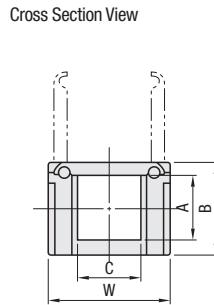
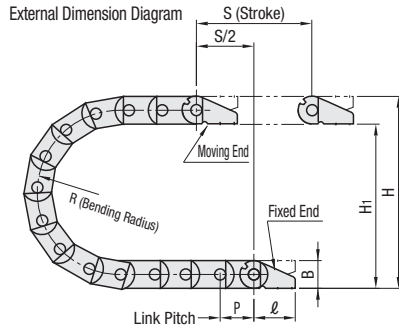

The above is a drawing of Cable Carrier assembled with 10 links and mounting brackets.

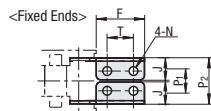
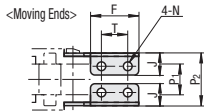

<Cautions>

- Cable Carrier (10 Links and 1 Link) and mounting brackets are not assembled together at the time of delivery. Link connection and brackets assembly are required for use.
- Install the mounting bracket fixed end on the lower side, and moving end on the upper side. (Refer to the Positional Relationship in External Dimension Diagram)
- Mounting bracket shape varies depending on size.

Part Number	Type	No.	Bending Radius	Number of Links	Mounting Direction *	Cable Carrier Dimensions						Mounting Dimensions				H		HF (Required Physical Height)	K (Arc + Margin)	Weight per Meter (kg) (Reference)						
						A	B	C	W	P	l	F	T	J	N	Moving End P1	Fixed End P2				P1	P2	(Mounting Height)	H1		
FHPS (Cable Carrier + Mounting Brackets)	A	202	30	8~43	B	13	20	14	26	20	30	20	10	10	4.5	9.8	21.8	8	20	80	60	95	144.2	0.28		
		203	30	8~43		13	20	20	32	20	30					15.8	27.8	14	26	80	60	95	144.2	0.31		
		204	38	7~34		13	22	22	40	26	43	32	18	14	5.8	18.6	34.6	15	31	98	76	118	179.3	0.5		
		206	38	7~34		13	22	42	60	26	43					38.6	54.6	35	51	98	76	118	179.3	0.6		
		408	B	50		9~36	B	25	40	58	78	45	60	40	24	22	7	44	72	40	68	122	100	142	217	1.36
				70		8~45		25	40	97	117	45	60	40	24	22	7	83	111	79	107	180	140	210	319.8	
				100		10~47		25	40	97	117	45	60	40	24	22	7	83	111	79	107	240	200	270	414	
				70		8~45		25	40	97	117	45	60	40	24	22	7	83	111	79	107	180	140	210	319.8	
		412	100	11~49		25	40	97	117	45	60	40	24	22	7	83	111	79	107	240	200	270	414	1.7		

Part Number	Type	No.	Bending Radius Selection	Number of Links	Mounting Direction *	Unit Price		
						Cable Carrier + Mounting Bracket (One Link Unit Price x Number of Links) + Mounting Bracket Price		
FHPS (Cable Carrier + Mounting Brackets)	A	202	30	8~43	B			
		203	30	8~43				
		204	38	7~34				
		206	38	7~34				
		408	B	50		9~36		
				70		8~45		
				100		10~47		
				70		8~45		
		412	100	11~49				

<Cautions on Model Selection>

- A Cable Carrier and suitable Mounting Brackets (Moving Ends x1 set, Fixed Ends x1 set) are in a set.
- Please note that part numbers vary depending on inner/outer circumference mounting.



Ordering Example

Part Number - Bending Radius - Number of Links - Mounting Direction
FHPS204 - 38 - 12 - A

Mounting Direction

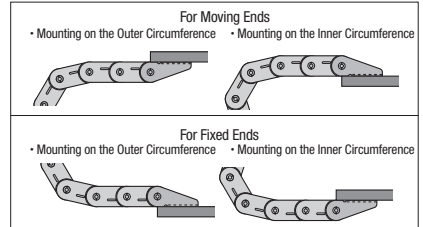

In the case of new designs, there may be a possibility that carrier links run short. It is recommended that links are selected longer by one or two links, and are adjusted (removed) at the time of installing (removing) device.

* Mounting Bracket Structural Components

No.	Mounting Direction	Mounting Bracket Structural Components	
		For Moving Ends	For Fixed Ends
202~206	A	Mounting on the Outer Circumference	Common to Mounting on the Outer and Inner Circumferences
	B	Mounting on the Inner Circumference	Common to Mounting on the Outer and Inner Circumferences
408, 412	A	Common to Mounting on the Outer and Inner Circumferences	Mounting on the Outer Circumference
	B	Common to Mounting on the Outer and Inner Circumferences	Mounting on the Inner Circumference

Flap Opening and Closing



- Flaps are laid on one another. Insert a flathead screwdriver in the side window and pry the flap to open. Start with the top flap.

Link Connection (Common)

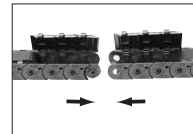

- Open link flaps, mate the blocks with each other and push the both ends to joint fit together.

Link Disconnection (Common)

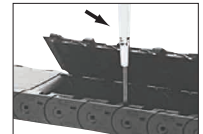

- Open the link flaps, insert and push down a flathead screwdriver in a gap between the links to disconnect.