

Simplified Slide Rails

Stainless Steel, With Ball Bearing, With Lock

Load Rating: 380N, 460N/pc

■ **Features:** Corrosion resistant since made of stainless steel.



	Type		Rail	Part Name	Material
	Set (Slider 1 pc. + Rail 1 pc.) Standard Type	With Lock			
No Stopper	KSR	KSRC	KSRR	Slider	SUS304
				Rail	SUS304
With Stopper	KSRST	KSRCST	-	Stopper	MC Nylon
				Clamp Screw	SUS304

🔒 To prevent the slider fall-off, select with-stopper type.

Set **KSR**
(Standard Type)

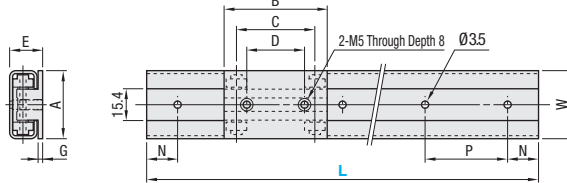

Set: With Stopper
KSRST
(Standard Type)
KSRCST
(With Lock)

Set
KSRC
(With Lock)

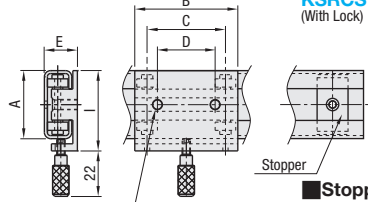

■ **Stopper Part**

Slider
(Standard Type)

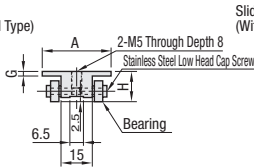

Slider
(With Lock)

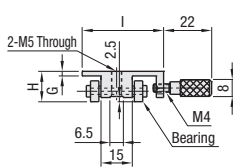

Rail
KSRR

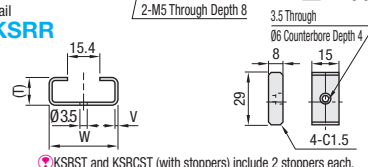

📐 Use in places where guides are subjected to moment load is not recommended.

🔩 For installation of rails, use Hex Socket Extra Low Head Cap Screw (Part P2-194)

🔒 KSRST and KSRCST (with stoppers) include 2 stoppers each.
🔩 Fasten the stopper together with the rail.

No.	Slider									Rail				
	A	B	C	D	E	G	H	I	W	P	N	(T)	V	Bearing
13	32	40	30	20	13	1.8	11.8	38	32	50	10	10.7	1.2	SUS693ZZ Bearing
16	33	50	38	28	16	2.2	14.55	39	33	40	15	13.3	1.5	SUS623ZZ Bearing

Part Number	L	Mounting Hole Qty.	Effective Stroke Slider 1 pc.	Load Rating N (kgf) Slider 1 pc.	Unit Price					Addable Slider Qty.		
					KSR	KSRST	KSRC	KSRCST	KSRR	No Stopper	With Stopper	
Set Standard Type KSR (With Stopper) KSRST	70	2	24	380(39)	-	-	-	-	-	1	-	
	120	3	74		39	-	-	-	-	-	1~3	1~2
	170	4	124		89	-	-	-	-	-	1~4	1~3
	220	5	174		139	-	-	-	-	-	1~5	1~4
	270	6	224		189	-	-	-	-	-	1~6	1~5
	320	7	274		239	-	-	-	-	-	1~8	1~7
	370	8	324		289	-	-	-	-	-	1~9	1~8
	420	9	374		339	-	-	-	-	-	1~10	1~10
	470	10	424		389	-	-	-	-	-	1~10	1~10
	520	11	474		439	-	-	-	-	-	1~10	1~10
	570	12	524		489	-	-	-	-	-	1~10	1~10
	620	13	574		539	-	-	-	-	-	1~10	1~10
	670	14	624		589	-	-	-	-	-	1~10	1~10
	720	15	674		639	-	-	-	-	-	1~10	1~10
	770	16	724		689	-	-	-	-	-	1~10	1~10
	With Lock KSRC (With Stopper) KSRCST	70	2		14	460(47)	-	-	-	-	-	1
110		3	54	9	-		-	-	-	-	1~2	1~2
150		4	94	49	-		-	-	-	-	1~3	1~2
190		5	134	89	-		-	-	-	-	1~4	1~3
230		6	174	129	-		-	-	-	-	1~5	1~4
270		7	214	169	-		-	-	-	-	1~6	1~5
310		8	254	209	-		-	-	-	-	1~7	1~6
350		9	294	249	-		-	-	-	-	1~8	1~7
390		10	334	289	-		-	-	-	-	1~10	1~10
430		11	374	329	-		-	-	-	-	1~10	1~10
470		12	414	369	-		-	-	-	-	1~10	1~10
510		13	454	409	-		-	-	-	-	1~10	1~10
550		14	494	449	-		-	-	-	-	1~10	1~10
590		15	534	489	-		-	-	-	-	1~10	1~10
630		16	574	529	-		-	-	-	-	1~10	1~10
670		17	614	569	-		-	-	-	-	1~10	1~10
710	18	654	609	-	-	-	-	-	1~10	1~10		
750	19	694	649	-	-	-	-	-	1~10	1~10		
790	20	734	689	-	-	-	-	-	1~10	1~10		
830	21	774	729	-	-	-	-	-	1~10	1~10		
870	22	814	769	-	-	-	-	-	1~10	1~10		
910	23	854	809	-	-	-	-	-	1~10	1~10		
950	24	894	849	-	-	-	-	-	1~10	1~10		
990	25	934	889	-	-	-	-	-	1~10	1~10		
1030	26	974	929	-	-	-	-	-	1~10	1~10		

📐 *1 Effective stroke (No Stopper) is the dimension value with a margin of approx. 3mm set from each end to avoid dropout of sliders.

📐 *2 Effective stroke (With Stopper) is the dimension value with a margin of approx. 3mm set from contacts of sliders and stoppers to avoid conflict between them.

Ordering Example	Part Number	L
	KSR13	- 520 (Set)
	KSRST16	- 510 (With Stopper)
	KSRR16	- 630 (Rail only)

Load Direction

Please install the rail in horizontal or overhead position as shown below. Wall-hanging is not applicable.

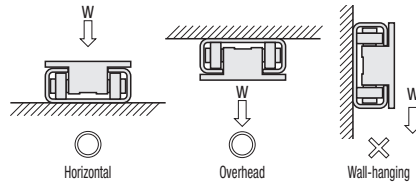

Precision Standards

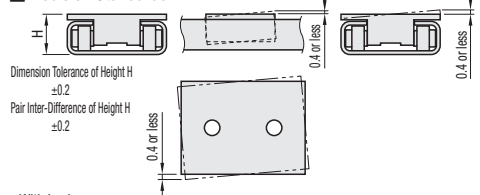

<With Lock> Simply push rail side surfaces with clamp screws to hold a slider position manually.

Retaining Force (Reference Value)

13	3.9kg
16	5.2kg

🔒 Retaining force is the value when Tightening Torque is 0.3N·m.

*When external force more than retaining force is applied, retaining position will change.
*When installing simplified slide rails on vertical position or slanted position, provide external devices to avoid sliders falling off.



Part Number - L - (S · C)
KSR16 - 550 - S1

Alterations	Code	Spec.												
Additional Slider	S	Sliders are added. Please specify additional slider quantity after S and C. Please refer to the price list for maximum quantity of addable sliders.												
		<p>■ Selection Example</p> <table border="1"> <thead> <tr> <th>Additional Slider Qty.</th> <th>Ordering Code</th> <th>Slider Total Qty.</th> </tr> </thead> <tbody> <tr> <td>Standard</td> <td>With Lock</td> <td></td> </tr> <tr> <td>5</td> <td>0</td> <td>KSR16-550-S5</td> <td>6</td> </tr> <tr> <td>1</td> <td>2</td> <td>KSR16-550-S1-C2</td> <td>4</td> </tr> </tbody> </table>	Additional Slider Qty.	Ordering Code	Slider Total Qty.	Standard	With Lock		5	0	KSR16-550-S5	6	1	2
Additional Slider Qty.	Ordering Code	Slider Total Qty.												
Standard	With Lock													
5	0	KSR16-550-S5	6											
1	2	KSR16-550-S1-C2	4											
With Lock Slider	C	<p>🔒 Added sliders are the same size as that of the original part number model.</p> <p>🔒 When ordering 50 or more identical sliders at a time, please request a quotation.</p> <p>🔒 Not applicable when ordering rails only.</p>												