

Linear Guide Clamps

For Medium/Heavy Load Linear Guides



RoHS 10

Type		Part	Material	Surface Treatment
Knob Type	Clamp Type			
SVCN	SVCK	① Main Body	S45C	Electroless Nickel Plating
		② Right and Left Hand Thread	SCM435	Black Oxide Coating
		③ Contacts	S45C	-

Tightening Torque and Retaining Force

- Knob Type: 0.7 N·m
- Retaining Force (Reference) 100 N
- Clamp Lever Type: 2.5 N·m
- Retaining Force (Reference) 400 N

- Opening Ranges of Contacts
- H24→10-22mm
 - H28→14-28mm
 - H30→15-30mm
 - H33→16-40mm
 - H36→17-36mm
 - H42→21-56mm
 - H42G→21-56mm

Fitting Dimensions Knob Type SVCN

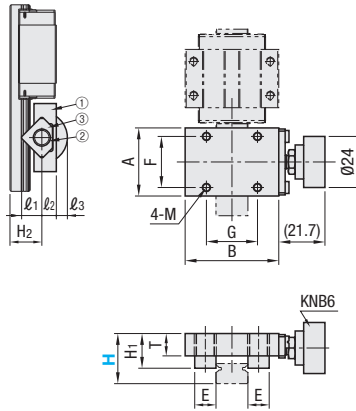

Fitting Dimensions Clamp Lever Type SVCK

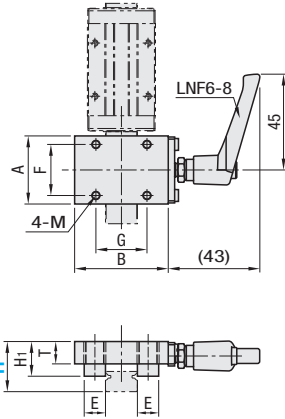

(SVCN42 Type)

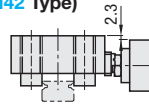

Example

* Do not use for vertical position retaining.

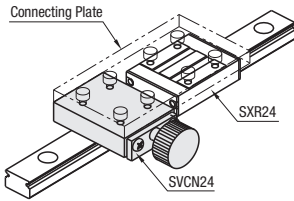

- ① Linear guide clamp must be mounted to a connecting plate with linear guide first, then attached to the rail.
- ② Connecting plate is to be supplied by user.
- ③ Match with the H dimension of Medium/Heavy Load Linear Guides.
- ④ For KNB6, see **P.2-1165**.
- ⑤ For LNF6-8, see **P.2-1145**.

Part Number Type	H	A	B	F	G	E	T	H1	H2	l1	l2	l3	M (Coarse)	Unit Price	
														SVCN	SVCK
24	32	44	24	24	10	10.5	16.3	17.2	9.5	6.8	5.2	M4			
28	35	50	25	25	10	11.5	17.3	20.2	9.5	7.8	4.2	M5			
30	38	54	28	28	11	11.0	18.3	22.7	11.0	7.3	4.7	M5			
33	38	62	26	26	10	14.0	19.8	22.7	9.5	10.3	1.7	M6			
36	42	60	30	30	11	13.0	20.3	26.7	11.0	9.3	2.7	M6			
42	46	80	32	32	11	18.0	25.3	27.7	11.0	14.3	-	M8			



Ordering Example

Part Number

SVCN24



Example

Conveyer Pitch Change

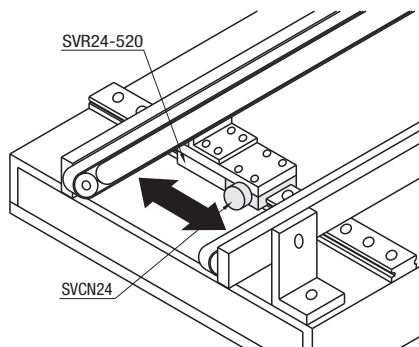

Positioning of Robots etc.

