

Shaft Collar Threaded Bore

Set Screw / Clamp



Type		M	S	A
Fine	Coarse	Material	Surface Treatment	Accessory
SCCNS	SCCNCN	S45C	Black Oxide Coating	Set Screw 2 pcs, Thread Protectors 2 pcs.
PSCNS	PSCNCN	Equivalent	Electroless Nickel Plating	MSCM435 Equivalent
SSCCNS	SSCCNCN	SUS304	-	MSCM304 Equivalent, M Copper Alloy

25/(6.3/)

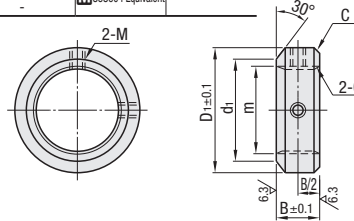

RoHS10

Part Number	Type	No.	B		m×Pitch		D1	d1	C	Set Screw M x Length	Unit Price		
			(Fine)	(Coarse)	(Fine)	(Coarse)					SCCNS	PSCNS	SSCCNS
(Fine Thread Type) SCCNS PSCNS SSCCNS	*3 4 5	6	6	-	M3x0.35	-	7	4.5	0.2	M3x3			
				M4x0.5	M4x0.7	8	5.5						
				M5x0.5	M5x0.8	11	10						
	6 8 10	10	M6x0.75	M6x1.0	12	11							
			M8x0.75	M8x1.25	14	12							
			M10x0.75	M10x1.5	16	13							
	(Coarse Thread Type) SCCNCN PSCCNCN SSCCNCN	*10A 12 *15	10	-	M10x1.0	-	20	15	0.5	M5x4			
				M12x1.0	M12x1.75	24	20						
				M15x1.0	-	26	22						
		16 20 *25 30	12	15	M16x1.0	M16x2.0	32	27		M6x5			
					M20x1.0	M20x2.5	38	31					
					M25x1.5	M30x3.5	46	38					

* marked sizes are applicable to Fine Thread Type only.



Type		M	S	A
Fine	Coarse	Material	Surface Treatment	Accessory
SCSN	SCSNCN	S45C	Black Oxide Coating	Hex Socket Head Cap Screw 1 pc.
PSCSN	PSCSNCN	Equivalent	Electroless Nickel Plating	MSCM435 Equivalent
SSCSN	SSCSNCN	SUS304	-	MSCM304 Equivalent

25/(6.3/)

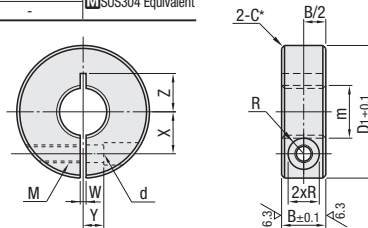

*m3 ~m8 : C0.5
m10~m30: C1

RoHS10

Part Number	Type	No.	B	m×Pitch		D1	M (Coarse)	d	R	W	X				Unit Price				
				(Fine)	(Coarse)						(Fine)	(Coarse)	Y	Z	SCSN	PSCSN	SSCSN		
(Fine Thread Type) SCSN PSCSN SSCSN	3 4 5	8	8	M3x0.35	M3x0.5	16	M3	3.4	3	1.0	4.5	4.5	2.2	3-5					
				M4x0.5	M4x0.7	18					5	5	3	3.5-6					
				M5x0.5	M5x0.8	20					5.5	5.5	4	5-6.5					
	6 8 *18A	10	10	M6x0.75	M6x1.0	25	M4	4.5	3.75	1.5	6	6	-	6-6.5					
				M8x0.75	M8x1.25	30					8	8	-	8-9					
				M10x0.75	M10x1.5	34					9	9	-	9-10					
	(Coarse Thread Type) SCSNCN PSCSNCN SSCSNCN	*110A 12 *12A	12	12	M10x1.0	M12x1.75	35	M5	5.5	4.5	1.5	10	10	-	10				
					M12x1.25	-	40					11.5	-	-	10-11				
					M14x1.5	M16x2.0	45					12	12.5	6	11-12				
		*116A *118 20 *120A *122 24*2 *125 *127 30	15	15	15	M16x1.5	M20x2.5	55	M6	6.6	6	1.5	12.5	-	-	12-13			
						M18x1.5	-	55					14	14	-	13			
						M20x1.0	M20x2.5	55					17	17	-	14-15			
					M22x1.5	-	55					17	17	-	16				
					M25x1.5	M24x3.0	55					20	20	8	17-20				
					M27x1.5	-	55					20	20	10	18-20				
				M30x1.5	M30x3.5	55					20	20	10	18-20					

* 1 marked size in No. is applicable to Fine Thread Type only.

* 2 marked size in No. is applicable to Coarse Thread Type only.

W dimension of Coarse Thread Type No.5 is 1.5.

Ordering Example
Part Number
SCCNS20

