

SUS-SR TYPE



There are some non-conforming products.



Fixed wheel



Plate type



Stainless steel



SUS-SR-75RH

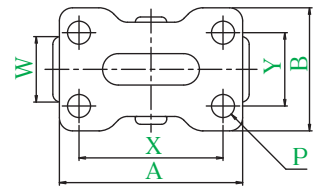
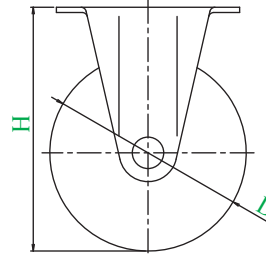

Description of product number

SUS - SR - 75 RH

Bracket type
Wheel diameter
Wheel type

Bracket = Stainless steel

Product number	Wheels								
		Wheel diameter D(mm)	Wheel width W(mm)	Mounting height H(mm)	Mounting base A × B(mm)	Mounting dimensions X × Y(mm)	Hole diameter P(mm)	Allowance load daN(kgf)	Wheel weight (g)
SUS-SR-50	RH Rubber wheel	50	28	70	70 × 47	55 × 28	8.8	50(51.0)	185
	N Nylon wheel							60(61.2)	150
	UR Urethane wheel with nylon wheel assembly		25					60(61.2)	155
SUS-SR-65	RH Rubber wheel	65	25	85	70 × 47	55 × 28	8.8	50(51.0)	275
	N Nylon wheel							70(71.4)	160
	UR Urethane wheel with nylon wheel assembly		60(61.2)					185	
	EL Elastomer wheel		27					40(40.8)	
SUS-SR-75	RH Rubber wheel	75	25	93	70 × 47	55 × 28	8.8	60(61.2)	265
	NR Rubber wheel with nylon wheel assembly		27					60(61.2)	195
	N Nylon wheel		25					80(81.6)	180
	UR Urethane wheel with nylon wheel assembly		26					70(71.4)	200
	EL Elastomer wheel		27					50(51.0)	190

● Conductive rubber wheel having wheel diameter of φ 75 can be manufactured.

Wheel in use

Refer to P163 for detailed specifications.



RH Rubber wheel



NR Rubber wheel with nylon wheel assembly



N Nylon wheel



UR Urethane wheel with nylon wheel assembly



EL Elastomer wheel

- J
- PM
- J2
- RJ2
- SJ
- S
- E
- G
- L
- SA
- H
- CAL -H
- M
- PL
- Silence
- SUS -J2
- SUS -SJ
- SUS -S**
- SUS -E
- SUS -H
- P
- SKY
- Equipped with adjuster foot
- Special
- Easy lock
- Wheels