

SUS-SG-S TYPE



There are some non-conforming products.



Swivel



Plate type



Equipped with a single stopper



Double bearing



Stainless steel

• Equipped with a pedal type single stopper



SUS-SG-75RHS

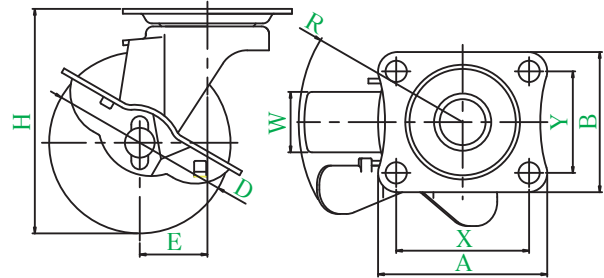

● Description of product number

SUS - SG - 75 RH S

Bracket type

Wheel diameter

Wheel type

Equipped with stopper

Bracket = Stainless steel

Product number	Wheels											
		Wheel diameter D(mm)	Wheel width W(mm)	Mounting height H(mm)	Mounting base A × B(mm)	Mounting dimensions X × Y(mm)	Hole diameter P(mm)	Eccentricity E(mm)	Turning radius R(mm)	Allowance load daN(kgf)	Wheel weight (g)	
SUS-SG-50	RH	50	28	70	70 × 58	55 × 42	8.8	27	67	50(51.0)	300	
	N S		25							60(61.2)	275	
	UR		25							60(61.2)	280	
SUS-SG-65	RH	65	25	85	70 × 58	55 × 42	8.8	27	67	50(51.0)	415	
	N S									27	70(71.4)	300
	UR									27	60(61.2)	330
	EL									27	40(40.8)	
SUS-SG-75	RH	75	25	93	70 × 58	55 × 42	8.8	28	68	60(61.2)	455	
	NR		27							60(61.2)	355	
	N S		25							80(81.6)	320	
	UR		26							70(71.4)	345	
	EL		27							50(51.0)	345	

- These casters are used for only locking rotation of the wheel.
- Conductive rubber wheel having wheel diameter of φ 75 can be manufactured.

Wheel in use

Refer to P163 for detailed specifications.



RH
Rubber wheel



NR
Rubber wheel with nylon wheel assembly



N
Nylon wheel



UR
Urethane wheel with nylon wheel assembly



EL
Elastomer wheel