

■ Dimensions (mm) and Weights (kg)

• TD-10NA

Nominal size	d	L	H <sub>1</sub>	H <sub>2</sub>	Weight
15A	Rc 1/2	90	49	55.5	0.9
20A	Rc 3/4	90	53	60.5	1.2
25A	Rc 1	90	56	62.5	1.4

• TD-30NA

Nominal size	L	H <sub>1</sub>	H <sub>2</sub>	Weight
15A	125	51	59	2.3
20A	140	54	63	3.4
25A	150	65	63	4.1

·The dimensions of the product with JIS 10K FF flanged and the product with JIS 20K FF flanged are identical.  
 ·The thickness of JIS 10K FF flanges conforms to that of JIS 20K FF flanges.

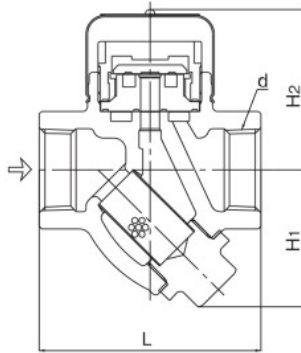

TD-10NA

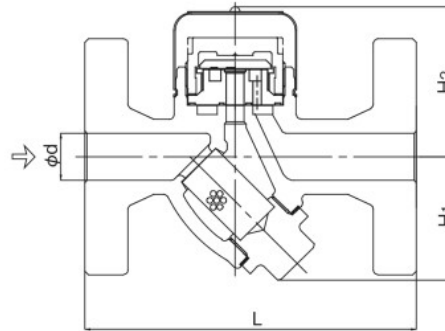

TD-30NA

■ Maximum Continuous Discharge Capacity Chart

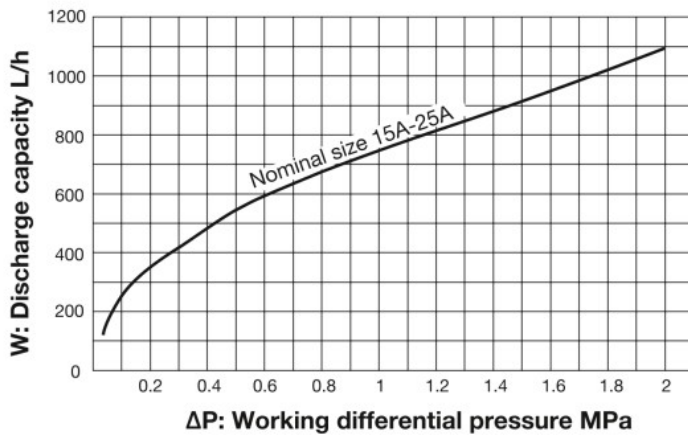

■ Installation Posture

\* The steam trap can be installed horizontally, slidingly, or vertically.

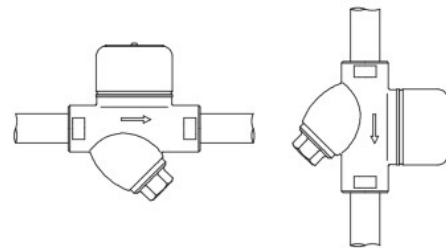

\*The discharge capacity shown on the above chart is the maximum value. In designing a system, select a steam trap with a sufficient safety factor (four to five times the regular level). For example, if a discharge capacity of 100 kg/h is required, select a steam trap capable of discharging 400 to 500 kg/h.