

SJC Series

Zero Backlash Jaw Coupling

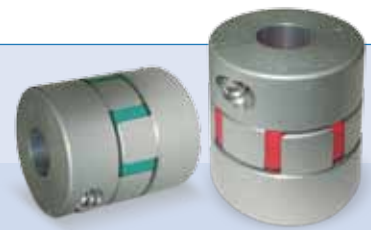

SJCM - C-GR(RD)

[CLAMP M TYPE]

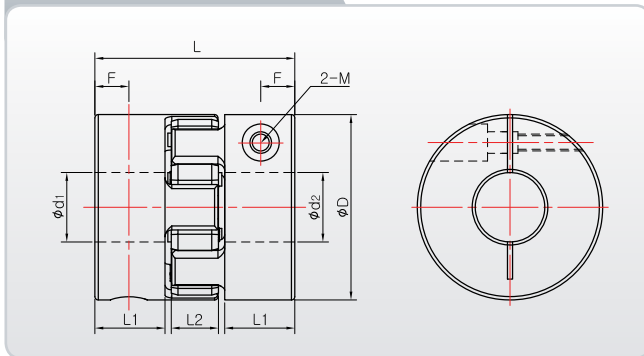

Ø D: Ø55~ Ø80

SJCM -100C-GR(RD)

[CLAMP M TYPE]

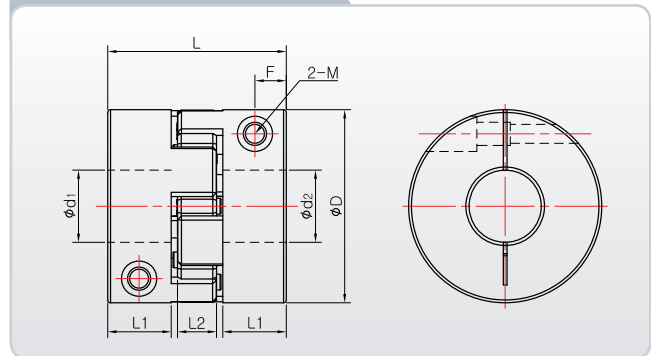

Dimensions & Performance

Product Number	Dimension (mm)(±0.3)					Fastening Bolt M	Fastening Torque (N·m)	Max-RPM (min ⁻¹)	Max Torque (N·m)	Rated Torque (N·m)	Torsional Stiffness (N·m/rad)	Moment of Inertia (kg·m ²)	Mass (g)	Permissible Misalignment		
	D	L	L ₁	L ₂	F									Angle (°)	Parallel (mm)	End-Play (mm)
SJCM-55C GR	55	59.3	20.8	14	10.1	M6	13	4,000	90	45	2,500	1.3×10 ⁻⁴	280	1	0.09	+1.4 -0.5
SJCM-65C GR	65	63.3	21.8	15	10.45	M8	30	3,500	240	120	4,000	2.6×10 ⁻⁴	400	1	0.1	+1.5 -0.6
SJCM-80C GR	80	87.2	31.7	18	15.5	M10	50	3,000	480	240	10,000	8.7×10 ⁻⁴	860	1	0.1	+1.5 -0.6
SJCM-100C GR	104	96.2	34.2	21	16.9	M12	90	3,000	600	300	7,000	3.1×10 ⁻³	1,700	1	0.15	+2.0 -0.6
SJCM-55C RD	55	59.3	20.8	14	10.1	M6	13	4,000	120	60	4,000	1.3×10 ⁻⁴	280	1	0.06	+1.4 -0.5
SJCM-65C RD	65	63.3	21.8	15	10.45	M8	30	3,500	360	180	8,000	2.6×10 ⁻⁴	400	1	0.08	+1.5 -0.6
SJCM-80C RD	80	87.2	31.7	18	15.5	M10	50	3,000	640	320	20,000	8.7×10 ⁻⁴	860	1	0.08	+1.5 -0.6
SJCM-100C RD	104	96.2	34.2	21	16.9	M12	90	3,000	1,200	600	40,000	3.1×10 ⁻³	1,700	1	0.1	+2.0 -0.6

* Mass and mass moment of inertia are measured with max. bore size

Standard Inner diameter

Product Number	Standard Inner Diameter(d ₁ , d ₂ unit:mm)																			
	10	12	14	15	16	18	19	20	22	24	25	26	28	30	32	35	40	45	50	60
SJCM-55C		●	●	●	●	●	●	●	●	●	●	●	●							
SJCM-65C				●	●	●	●	●	●	●	●	●	●	●	●	●				
SJCM-80C				●	●	●	●	●	●	●	●	●	●	●	●	●	●	●		
SJCM-100C								●	●	●	●	●	●	●	●	●	●	●	●	●

■ For the inner diameter, INCH type is available

■ Nonstandard inner diameter is also available

■ Keyway is available

■ The recommendation for shaft tolerance is h7.

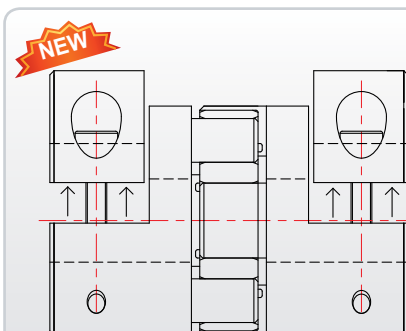

※ It is possible to order the CLAMP Split Type for outer Diameter Size Ø30-Ø100 (Ø 30 is available B TYPE)
 ※ It is impossible for SJCM series.



CLAMP SPLIT TYPE



GENERAL CLAMP TYPE