



Fitting series

SQZ series

CHELIC PNEUMATIC

◉ SQZ series Universal elbow

Metric specification

Port size ØD	Thread size Rc (PT)	Model	A	B	C	E	ØG	L	Opposite dim H	Effective area mm ²	Weight (g)
Ø4	M5	SQZ 4 - M5	3.8	17.1	14.6	19.9	10.5	31	10	3.5	8.5
	1/8"	SQZ 4 - 01	6	20.7	14.6	21.6		34.4	10	4.2	12
Ø6	M5	SQZ 6 - M5	3.8	17.1	17.1	21.8	12.4	36.6	10	3.5	11.5
	1/8"	SQZ 6 - 01	6	20.7	17.1	23.7		40.4	10	10	13.5
	1/4"	SQZ 6 - 02	9	23	17.1	25.9		43.6	14	10	20.5
Ø8	1/4"	SQZ 8 - 02	9	23	18.9	27.7	14.3	44	14	16	23
	3/8"	SQZ 8 - 03	10	27.4	18.9	29.9		45	17	16	28
Ø10	1/4"	SQZ 10 - 02	9	23	20.4	29.6	17.9	49.2	17	30	34
	3/8"	SQZ 10 - 03	10	27.4	20.4	31.7		49.4	17	30	35
	1/2"	SQZ 10 - 04	14	33.9	22.8	37.2		21.2	56.9	21	50
Ø12	3/8"	SQZ 12 - 03	10	27.4	22.8	35	21.2	54.4	17	50	47
	1/2"	SQZ 12 - 04	14	33.9	22.8	37.2		56.9	21	50	60

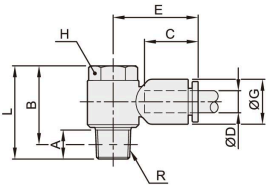

Inch specification

Port size ØD	Thread size NR / NPT	Model	A	B	C	E	ØG	L	Opposite dim H	Effective area mm ²	Weight (g)
1/4"	NR 10/32"	SQZ 1/4 - 10/32	3.8	17.1	17.1	21.8	12.4	36.6	10	3.5	11.5
	1/8"	SQZ 1/4 - 01	6	20.7	17.1	23.7		40.4	10	10	13.5
	1/4"	SQZ 1/4 - 02	9	23	17.1	25.9		43.6	14	10	20.5
5/16"	1/4"	SQZ 5/16 - 02	9	23	18.9	27.7	14.3	44	14	16	23
	3/8"	SQZ 5/16 - 03	10	27.4	18.9	29.9		45	17	16	28
3/8"	1/4"	SQZ 3/8 - 02	9	23	20.4	29.6	17.9	49.2	17	30	34
	3/8"	SQZ 3/8 - 03	10	27.4	20.4	31.7		49.4	17	30	35
	1/2"	SQZ 3/8 - 04	14	33.9	22.8	37.2		21.2	56.9	21	50
1/2"	3/8"	SQZ 1/2 - 03	10	27.4	22.8	35	21.2	54.4	17	50	47
	1/2"	SQZ 1/2 - 04	14	33.9	22.8	37.2		56.9	21	50	60