



# SLB series - Silencer ( Brass )

## Specification and External dimension

CHELIC PNEUMATIC



**CJ-M**  
Float joint

**M□V**  
Manually  
operated  
valve

**SA□**  
Shock  
absorber

**SHR**  
Hydraulic  
regulator

**SL□**  
Silencer

**P□S**  
Rod end

### Specification

Item	Model	SLB - M5	SLB - 01	SLB - 02	SLB - 03	SLB - 04
Fluid		Air				
Range of service pressure	kgf/cm <sup>2</sup> (kpa)	0 ~ 9 ( 900 )				
Ensure withstanding pressure	kgf/cm <sup>2</sup> (kpa)	13 ( 1300 )				
Range of service temperature	°C	5 ~ 60				
Material	Body	Brass				
	Filter element	Brass ( The thick of air pass through position 60μm)				
Connection port	Rc (PT)	M5x0.8P	1/8"	1/4"	3/8"	1/2"
Weight	g	3	55			60

### External dimension

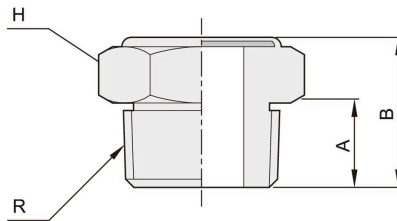

Model	Code	Connection port R Rc (PT)	A	B	Cross flat distance H
SLB - 01		1/8"	6	11.4	12
SLB - 02		1/4"	8.2	14.5	16
SLB - 03		3/8"	9	16	18
SLB - 04		1/2"	10.5	18	22