

Magnetic Catches

The number next to the logo mark indicates items in stock for each brand.

Hardware

Door Closers

Door Stoppers

Hinges

Slide Bolt Latches

Catches

Handles

Keys

Chains

Wire Ropes

Metal Fittings for Handling

Suspension Metal Fittings

Shelf Peg Metal Fittings

Joint Fittings

Steel Wires

Wire Nets

Inspection Doors, Air Inlet/Outlets

Handrails, Slopes

Corrugated Plates

Plastic Materials

Metal Materials

Construction Materials

Sash Rollers

Door Hangers

TRUSCO Stock **38,650** Items

Magnetic Catch (flat type)



- Features** • Since it is thin and has less projection, it can be used for various usages.
- Specs** • Main Body Mounting Hole Dimension: 3.5mm
- Materials** • Main Body: ABS Resin
- Origin** • Japan

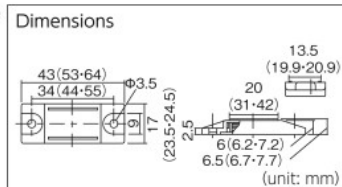

Order Unit: 1 Piece

Order Code	Item No.	Price (per piece)	MSRP (per piece)	Color	Total Length (mm)	Adhesion Strength (N)	SPQ (piece)	Weight (g)
300-5160	TSM-128-BK	¥125	¥135	Black	43	10	100	10
300-5178	TSM-129-BK	¥208	¥225	Black	53	30	100	22
300-5186	TSM-130-BK	¥259	¥280	Black	64	50	100	35

Contact us:0120-509-849 <http://www.orange-book.com/>

TRUSCO Stock **38,650** Items

Magnetic Catch (one-touch mounting type)



It can be installed and removed with one touch.

- Features** • Can be installed and removed with one touch.
- Specs** • One touch built-in type
• Recommended screw for receiving board: 2.7mm
- Materials** • Main Body: Polyacetate (POM)
• Bracket: Steel
- Accessories** • Bracket
- Origin** • Japan

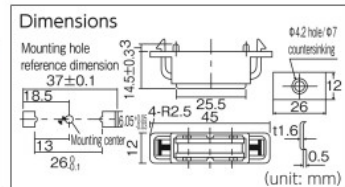

Order Unit: 1 Piece

Order Code	Item No.	Price (per piece)	MSRP (per piece)	Color	Total Length (mm)	Adhesion Strength (N)	SPQ (piece)	Weight (g)
300-5208	TSM-136-BK	¥79	¥85	Black	45	45	100	18

Contact us:0120-509-849 <http://www.orange-book.com/>

TRUSCO Stock **38,650** Items

Magnetic Catch (one-touch mounting type)



It can be installed and removed with one touch.

- Features** • Can be installed and removed with one touch.
- Specs** • One touch built-in type
• Recommended Flat Head Screw for Receiving Board: 2.4mm
- Materials** • Main Body: Polyacetate (POM)
• Bracket: Steel
- Accessories** • Bracket
- Origin** • Japan

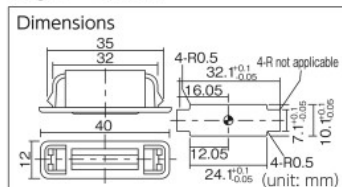

Order Unit: 1 Piece

Order Code	Item No.	Price (per piece)	MSRP (per piece)	Color	Total Length (mm)	Adhesion Strength (N)	SPQ (piece)	Weight (g)
300-5437	TSM-145-BK	¥111	¥120	Black	40	40	100	13

Contact us:0120-509-849 <http://www.orange-book.com/>

SUGATSUNE Stock **766** Items

Magnetic Catch



- Features** • 9kgf of high adsorption type.
- Materials** • Main Body: Aluminum Alloy
• Catch: Steel (SPCC)
- Accessories** • Catch
- Origin** • Japan

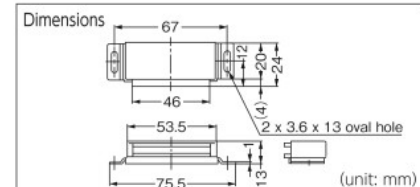

Order Unit: 1 Piece

Order Code	Item No.	Price (per piece)	MSRP (per piece)	Color	Total Length (mm)	Adhesion Strength (N)	SPQ (piece)	Weight (g)
481-1224	MC-12S	¥605	¥560	Brown metallic	75.5	88.2	20	72.9

Contact us:03-3851-1122 <http://www.sugatsune.co.jp/>

SUGATSUNE Stock **766** Items

Magnet Catch (horizontal type)



- Features** • With a sponge for noise reduction and avoidance of mounting failure.
- Materials** • Main body: PBT resin
• Catch: Steel (SPCC)
- Accessories** • Sponge cushion, cross recess pan head wood screw, cross recess round countersunk wood screw
- Origin** • Japan

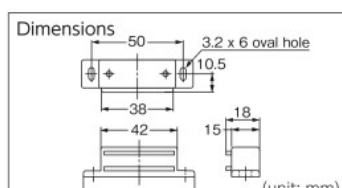

Order Unit: 1 Piece (Price revision date: May, 2015) SUGATSUNE KOGYO Co.Ltd.

Order Code	Item No.	Price (per piece)	MSRP (per piece)	Color	Total Length (mm)	Adhesion Strength (N)	SPQ (piece)	Weight (g)
481-1259	MC-KL-S	¥389	¥360	White	60	27.4	12	45

Contact us:03-3851-1122 <http://www.sugatsune.co.jp/>

SUGATSUNE Stock **766** Items

Strong Economy Magnetic Catch



- Features** • High adsorption type.
- Specs** • Main body mounting hole dimension: 3.5 x 6mm long hole
- Materials** • Main Body: Polyethylene (PE)
• York, catch: Steel (colored trivalent chromate treatment)
- Accessories** • Cross recess pan head wood screw M3.1 x 13, cross recess round countersunk wood screw M2.9 x 13
- Origin** • Japan

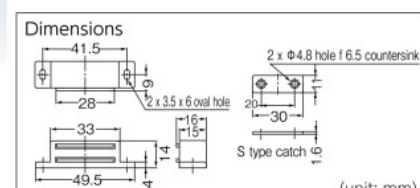

Order Unit: 1 Piece (Price revision date: May, 2015) SUGATSUNE KOGYO Co.Ltd.

Order Code	Item No.	Price (per piece)	MSRP (per piece)	Color	Total Length (mm)	Adhesion Strength (N)	SPQ (piece)	Weight (g)
418-3606	MC-EM-S	¥205	¥190	White	49.5	19.6	24	26

Contact us:03-3851-1122 <http://www.sugatsune.co.jp/>