

SBR · RB SERIES

TMC Optional parts

SBR SHORTING BAR

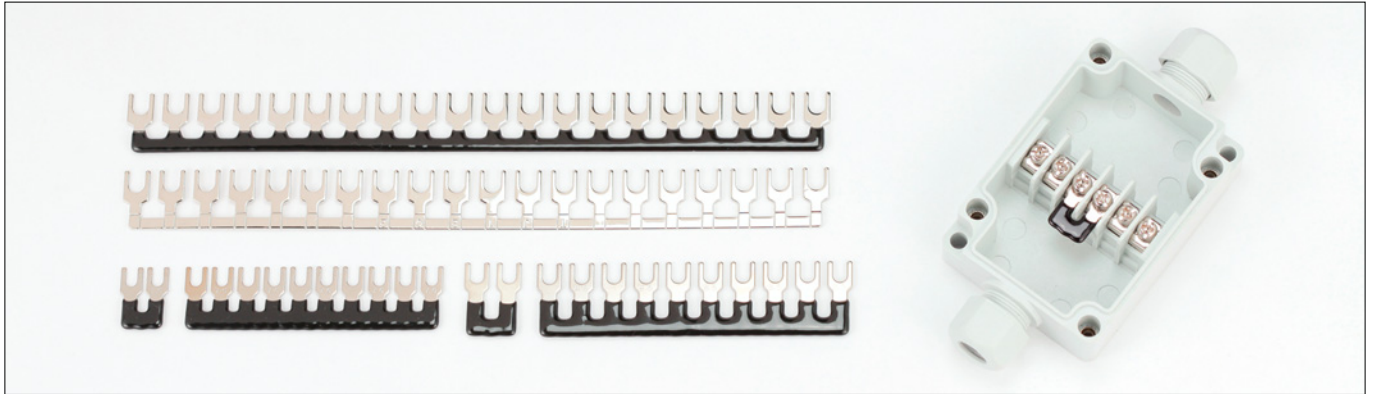

FEATURE

- Convenient for making common-wiring.
- Cut only a required number of shortings and use them.
- PVC coated.

SBR70-2P

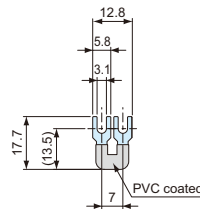

SBR70-10P

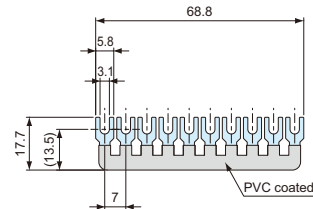

Part no. / Dimensions

| Part no. | Number of poles | Terminal pitch | Material | Color / Finish | Sales unit |
|-----------|-----------------|----------------|----------|----------------|------------|
| SBR70- 2P | 2P | 7.0mm | Brass | Nickel plated | 10 |
| SBR70-10P | 10P | 7.0mm | Brass | Nickel plated | 1 |

RB RUBBER BUSH



- Cable outside-diameter from $\Phi 8$ mm to 9mm is available.

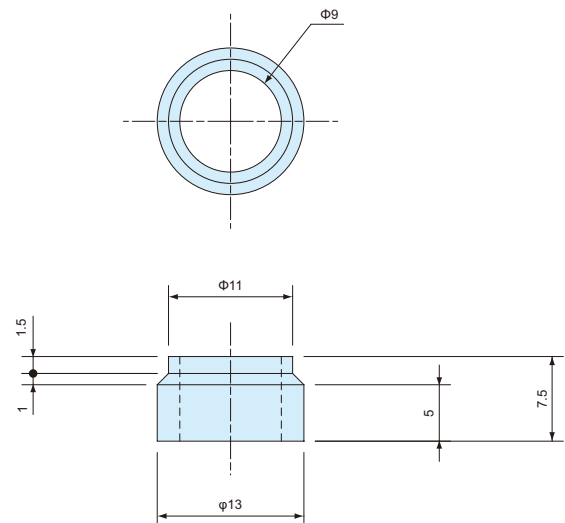

Part no. / Dimensions

1pack = 2pcs

| Part no. | Material | Color / Finish | Available cable size | Sales unit |
|----------|----------|----------------|-------------------------|------------|
| RB-9 | EPDM | Black | $\Phi 8 \sim \Phi 9$ mm | 2 |