

# RXE6100 RXH6100 (Duplex, Rotational Internal Pipe: Flange Connection)

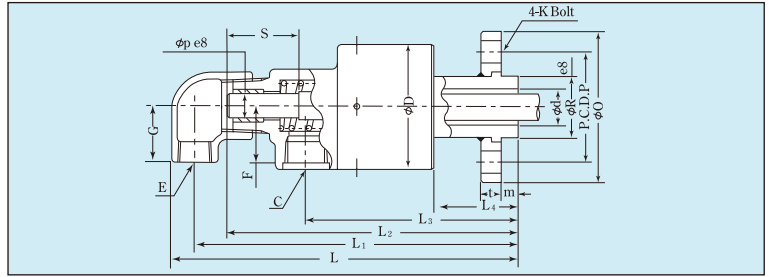
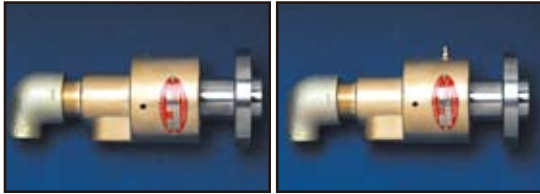

SIZE	CODE	C	E	d	FLANGE DIMENSIONS										F	G	D	L	L1	L2	L3	L4	INTERNAL PIPE	
					R	O	P	m	t	K	P	S												
15A	6115	Rc1/2	Rc3/8	12.5	25	62	45	8	10	M8	24	25	53	163	151	138	101	38	10	30				
20A	6120	Rc1/2	Rc3/8	18	30	74	54	8	12	M10	29	28	65	177	166	151	111	45	13	30				
25A	6125	Rc3/4	Rc1/2	22	35	80	60	9	12	M10	33	33	72	198	185	168	121	48	16	35				
32A	6132	Rc1	Rc3/4	30	50	96	75	9	14	M10	36	40	83	224	207	187	137	50	20	40				
40A	6140	Rc1	Rc3/4	35	50	96	75	9	14	M10	39	43	89	229	212	192	140	50	26	40				
50A	6150	Rc1 1/2	Rc1	48	65	120	95	10	14	M12	50	51	115	272	251	228	168	60	32	45				
65A	6165	Rc2	Rc1 1/2	58	80	136	110	12	16	M12	68	62	123	330	300	268	191	60	40	55				
80A	6180	Rc2	Rc1 1/2	68	90	154	125	15	20	M12	72	62	138	343	313	280	202	65	48	60				

- \* The flange connection type is supplied with a copper gasket (to be attached on the shaft end) , along with a stud bolt, nut and washer set.
- \* When you place an order for the flange connection type, it is not necessary to specify the direction of the thread.
- \* Please prepare the internal pipe by yourself. If you should place an order for the internal pipe with us, please be sure to specify the dimensions.

RXC & RXM are the same as RXE & RXH respectively but Casing and Elbow (connection for hose) threads are NPT.  
 RXC: Suitable for cooling service. Lubrication free due to pre-greased ball bearings  
 RXM: Available for high temperature operation with high grade seal materials and providing grease nipple for lubrication

# RXK6000 (Duplex, Rotational Internal Pipe: Flange Connection)

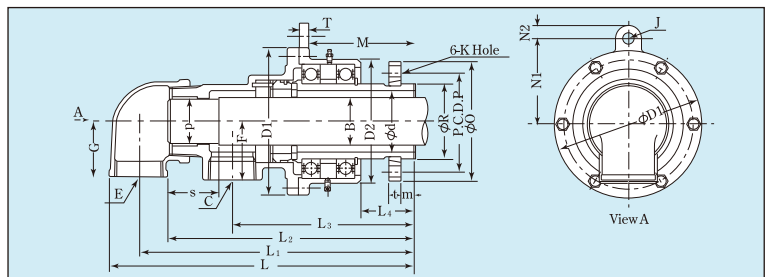

SIZE	CODE	C	E	d	R	O	P	m	t	K	F	G	D1	D2	N1	N2	L	L1	L2	L3	L4	p	s	M	J	B	T
90A	6081	Rc2	Rc2	82	100	175	150	15	20	14	80	72	206	172	125	20	419	382	347	260	80	59	70	156	18	60.5	15
100A	6082	Rc2 1/2	Rc2 1/2	98	120	190	160	20	20	19	95	90	236	202	140	20	483	437	392	290	85	75	80	169	18	76.3	16

- Non-electrolysis Nickel plated on Rotor (steel)
- Non-electrolysis Nickel plated on Head (cast iron)
- Sealed with carbon and ceramic
- Contact us for further information

TYPE & SIZE: Example for placing order

Type → Size

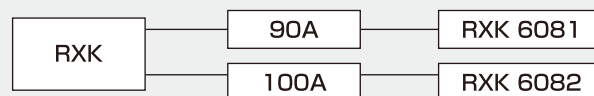

- \* The flange connection type is supplied with a copper gasket (to be attached on the shaft end) , along with a stud bolt, nut and washer set.
- \* When you place an order for the flange connection type, it is not necessary to specify the direction of the thread.
- \* Since RXK Type has a split ring on the flange, be sure to use a gasket at the end of the shaft.
- \* Please prepare the internal pipe by yourself. If you should place an order for the internal pipe with us, please be sure to specify the dimensions.