

# RXE5000 RXH5000 (Duplex, Rotational Internal Pipe: Thread Connection)

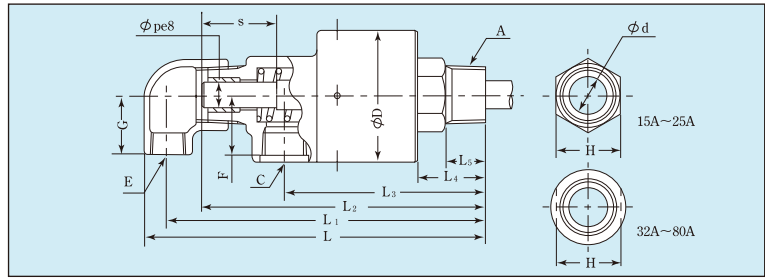
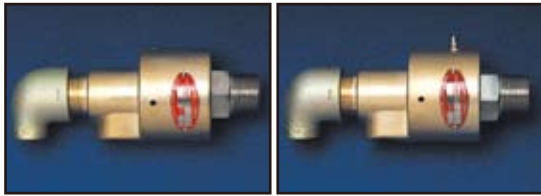

NOMINAL SIZE	CODE	A	C	E	F	G	D	L	L1	L2	L3	L4	L5	d	H	INTERNAL PIPE	
																P	S
15A	5015	R1/2	Rc1/2	Rc3/8	24	25	53	153	141	128	91	28	18	12.5	22	10	30
	5115	G1/2	Rc1/2	Rc3/8	24	25	53	155	143	130	93	30	18	12.5	27	10	30
	5215	M22×1.5	Rc1/2	Rc3/8	24	25	53	155	143	130	93	30	18	12.5	27	10	30
	5615	NPT1/2	NPT1/2	NPT3/8	24	25	53	153	141	128	91	28	18	12.5	22	10	30
	5715	3/4-16UNF	NPT1/2	NPT3/8	24	25	53	155	143	130	93	30	18	12.5	27	10	30
20A	5020	R3/4	Rc1/2	Rc3/8	29	28	65	165	153	138	98	32	19	18	32	13	30
	5120	G3/4	Rc1/2	Rc3/8	29	28	65	165	153	138	98	32	17	18	32	13	30
	5220	M26×1.5	Rc1/2	Rc3/8	29	28	65	165	153	138	98	32	17	18	32	13	30
	5620	NPT3/4	NPT1/2	NPT3/8	29	28	65	165	153	138	98	32	19	18	32	13	30
	5720	1-14UNS	NPT1/2	NPT3/8	29	28	65	165	153	138	98	32	17	18	32	13	30
25A	5025	R1	Rc3/4	Rc1/2	33	33	72	187	174	157	110	37	22	22	36	16	35
	5125	G1	Rc3/4	Rc1/2	33	33	72	183	170	154	106	33	18	22	36	16	35
	5225	M35×1.5	Rc3/4	Rc1/2	33	33	72	184	171	154	107	34	16	22	41	16	35
	5625	NPT1	NPT3/4	NPT1/2	33	33	72	187	174	157	110	37	22	22	36	16	35
	5725	1 1/2-12UNF	NPT3/4	NPT1/2	33	33	72	191	178	160	114	41	23	22	41	16	35
32A	5032	R1 1/4	Rc1	Rc3/4	36	40	83	219	202	182	132	45	25	30	41	20	40
	5132	G1 1/4	Rc1	Rc3/4	36	40	83	220	203	182	133	46	25	30	41	20	40
	5232	M42×1.5	Rc1	Rc3/4	36	40	83	220	203	182	133	46	25	30	41	20	40
	5632	NPT1 1/4	NPT1	NPT3/4	36	40	83	219	202	182	132	45	25	30	41	20	40
	5732	1 3/4-12UN	NPT1	NPT3/4	36	40	83	220	203	182	133	46	25	30	41	20	40
40A	5040	R1 1/2	Rc1	Rc3/4	39	43	89	226	209	189	137	47	25	35	46	26	40
	5140	G1 1/2	Rc1	Rc3/4	39	43	89	227	210	189	138	48	25	35	46	26	40
	5240	M50×1.5	Rc1	Rc3/4	39	43	89	227	210	189	138	48	25	35	46	26	40
	5640	NPT1 1/2	NPT1	NPT3/4	39	43	89	226	209	189	137	47	25	35	46	26	40
	5740	2-12UN	NPT1	NPT3/4	39	43	89	227	210	189	138	48	25	35	46	26	40
50A	5050	R2	Rc1 1/2	Rc1	50	51	115	268	247	224	164	56	30	48	60	32	45
	5650	NPT2	NPT1 1/2	NPT1	50	51	115	268	247	224	164	56	30	48	60	32	45
65A	5065	R2 1/2	Rc2	Rc1 1/2	68	62	123	345	315	283	206	75	40	58	65	40	55
	5665	NPT2 1/2	NPT2	NPT1 1/2	68	62	123	345	315	283	206	75	40	58	65	40	55
80A	5080	R3	Rc2	Rc1 1/2	72	62	138	353	323	290	212	75	40	68	75	48	60
	5680	NPT3	NPT2	NPT1 1/2	72	62	138	353	323	290	212	75	40	68	75	48	60

- \* A rotor with a parallel screw is supplied with the copper plate gasket.
- \* Please prepare the internal pipe by yourself. If you should place an order for the internal pipe with us, please be sure to specify the dimensions.

RXC & RXM are the same as RXE & RXH respectively but Casing and Elbow (connection for hose) threads are NPT.  
**RXC:** Suitable for cooling service. Lubrication free due to pre-greased ball bearings  
**RXM:** Available for high temperature operation with high grade seal materials and providing grease nipple for lubrication  
 Code No.56\*\* & 57\*\* are not available for RXC & RXM.