

## 平凸レンズ:S51

ホルダチョイス



P.3-029, 097~

RoHS 納期  
問合せ  
ください



BK7製の平凸レンズです。  
曲面側より、無限遠光線がくるように使用します。  
反射防止膜付はありません。  
紫外域の透過率の高い合成石英レンズ(S61)もあ  
ります。▶P.3-049

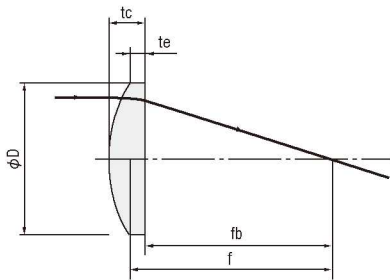

| SPEC       |        |         |        |         |         |         |      |
|------------|--------|---------|--------|---------|---------|---------|------|
| 型式         | 価格     | φD (mm) | f (mm) | fb (mm) | tc (mm) | te (mm) |      |
| S51-10-30  | ¥2,100 | 10      | 30     | 28.40   | 2.5     | 1.73    |      |
| S51-10-40  | ¥2,100 |         | 40     | 38.40   | 2.5     | 1.93    |      |
| S51-10-50  | ¥2,100 |         | 50     | 48.80   | 1.9     | 1.45    |      |
| S51-10-60  | ¥2,100 |         | 60     | 58.70   | 1.9     | 1.52    |      |
| S51-10-70  | ¥2,100 |         | 70     | 68.90   | 1.8     | 1.48    |      |
| S51-10-80  | ¥2,100 |         | 80     | 78.80   | 1.8     | 1.52    |      |
| S51-10-100 | ¥2,100 |         | 100    | 98.80   | 1.8     | 1.57    |      |
| S51-20-30  | ¥2,500 |         | 20     | 30      | 26.30   | 5.7     | 2.21 |
| S51-20-40  | ¥2,450 |         |        | 40      | 37.00   | 4.6     | 2.13 |
| S51-20-50  | ¥2,300 |         |        | 50      | 47.40   | 4.0     | 2.07 |
| S51-20-60  | ¥2,300 | 60      |        | 57.50   | 3.7     | 2.11    |      |
| S51-20-80  | ¥2,300 | 80      |        | 77.80   | 3.3     | 2.12    |      |
| S51-20-100 | ¥2,300 | 100     |        | 98.10   | 3.0     | 2.06    |      |
| S51-20-150 | ¥2,300 | 150     |        | 148.10  | 3.0     | 2.37    |      |
| S51-20-200 | ¥2,450 | 200     |        | 198.40  | 2.5     | 2.03    |      |
| S51-20-300 | ¥2,450 | 300     |        | 298.40  | 2.5     | 2.19    |      |
| S51-30-40  | ¥3,100 | 30      |        | 40      | 34.50   | 8.5     | 2.27 |
| S51-30-50  | ¥3,000 |         | 50     | 45.70   | 7.0     | 2.34    |      |
| S51-30-60  | ¥2,900 |         | 60     | 56.00   | 6.0     | 2.23    |      |
| S51-30-70  | ¥2,800 |         | 70     | 66.40   | 5.5     | 2.33    |      |
| S51-30-80  | ¥2,800 |         | 80     | 76.70   | 5.0     | 2.26    |      |
| S51-30-90  | ¥2,800 |         | 90     | 87.10   | 4.5     | 2.03    |      |
| S51-30-100 | ¥2,900 |         | 100    | 96.70   | 5.0     | 2.83    |      |
| S51-30-150 | ¥2,900 |         | 150    | 147.80  | 3.5     | 2.07    |      |
| S51-30-200 | ¥2,900 |         | 200    | 198.10  | 3.0     | 1.93    |      |
| S51-30-300 | ¥2,900 |         | 300    | 297.60  | 3.5     | 2.70    |      |
| S51-50-60  | ¥5,000 | 50      | 60     | 49.60   | 15.8    | 3.53    |      |
| S51-50-70  | ¥5,000 |         | 70     | 61.30   | 13.2    | 3.46    |      |
| S51-50-80  | ¥5,000 |         | 80     | 72.30   | 11.7    | 3.51    |      |
| S51-50-90  | ¥4,800 |         | 90     | 83.00   | 10.6    | 3.47    |      |
| S51-50-100 | ¥4,300 |         | 100    | 93.50   | 9.8     | 3.51    |      |
| S51-50-150 | ¥4,300 |         | 150    | 145.20  | 7.5     | 3.46    |      |
| S51-50-200 | ¥4,300 |         | 200    | 195.70  | 6.5     | 3.50    |      |
| S51-50-300 | ¥4,300 |         | 300    | 296.40  | 5.4     | 3.42    |      |

## 両凸レンズ:S52

ホルダチョイス



P.3-029, 097~

RoHS 納期  
問合せ  
ください

BK7製の両凸レンズです。  
平凸レンズよりも焦点距離を短くすることができます。  
有限距離の物点を結像する場合に用いられます。  
反射防止膜付はありません。  
紫外域の透過率の高い合成石英レンズ(S62)もあり  
ます。▶P.3-049

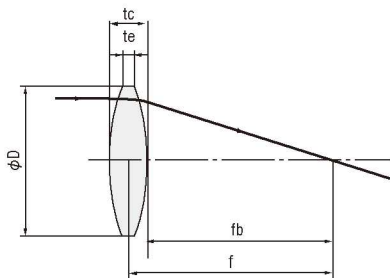

| SPEC       |        |         |        |         |         |         |      |
|------------|--------|---------|--------|---------|---------|---------|------|
| 型式         | 価格     | φD (mm) | f (mm) | fb (mm) | tc (mm) | te (mm) |      |
| S52-10-10  | ¥2,700 | 10      | 10     | 8.70    | 4.0     | 1.25    |      |
| S52-10-15  | ¥2,500 |         | 15     | 13.40   | 3.0     | 1.31    |      |
| S52-10-20  | ¥2,500 |         | 20     | 19.20   | 2.5     | 1.27    |      |
| S52-10-30  | ¥2,500 |         | 30     | 29.20   | 2.5     | 1.69    |      |
| S52-10-40  | ¥2,500 |         | 40     | 39.20   | 2.5     | 1.90    |      |
| S52-10-50  | ¥2,500 |         | 50     | 49.17   | 2.5     | 2.02    |      |
| S52-10-60  | ¥2,500 |         | 60     | 59.19   | 2.5     | 2.10    |      |
| S52-10-80  | ¥2,500 |         | 80     | 79.24   | 2.3     | 1.96    |      |
| S52-10-100 | ¥2,500 |         | 100    | 99.27   | 2.3     | 2.06    |      |
| S52-20-20  | ¥3,100 |         | 20     | 20      | 17.50   | 7.0     | 1.68 |
| S52-20-30  | ¥2,700 | 30      |        | 28.40   | 5.0     | 1.72    |      |
| S52-20-40  | ¥2,700 | 40      |        | 33.67   | 4.0     | 1.60    |      |
| S52-20-50  | ¥3,000 | 50      |        | 48.67   | 4.0     | 2.09    |      |
| S52-20-60  | ¥3,000 | 60      |        | 58.68   | 4.0     | 2.42    |      |
| S52-20-80  | ¥3,000 | 80      |        | 78.80   | 3.6     | 2.42    |      |
| S52-20-100 | ¥2,900 | 100     |        | 98.37   | 3.4     | 2.46    |      |
| S52-30-30  | ¥4,000 | 30      |        | 30      | 26.35   | 10.4    | 2.31 |
| S52-30-40  | ¥4,000 |         |        | 40      | 37.35   | 7.9     | 2.22 |
| S52-30-50  | ¥3,000 |         |        | 50      | 47.74   | 6.6     | 2.16 |
| S52-30-60  | ¥3,500 |         | 60     | 58.04   | 5.8     | 2.15    |      |
| S52-30-70  | ¥3,400 |         | 70     | 68.25   | 5.2     | 2.10    |      |
| S52-30-80  | ¥3,200 |         | 80     | 78.43   | 4.8     | 2.10    |      |
| S52-30-90  | ¥3,200 |         | 90     | 88.50   | 4.5     | 2.11    |      |
| S52-30-100 | ¥3,000 |         | 100    | 98.64   | 4.3     | 2.15    |      |
| S52-30-150 | ¥3,000 |         | 150    | 148.89  | 3.5     | 2.07    |      |
| S52-30-200 | ¥3,000 |         | 200    | 198.98  | 3.1     | 2.03    |      |
| S52-50-50  | ¥4,500 | 50      | 50     | 44.10   | 16.9    | 3.30    |      |
| S52-50-60  | ¥4,500 |         | 60     | 55.55   | 13.0    | 2.21    |      |
| S52-50-70  | ¥4,500 |         | 70     | 65.82   | 12.3    | 3.24    |      |
| S52-50-80  | ¥4,500 |         | 80     | 76.30   | 11.0    | 3.19    |      |
| S52-50-90  | ¥4,500 |         | 90     | 86.65   | 10.0    | 3.13    |      |
| S52-50-100 | ¥3,800 |         | 100    | 96.93   | 9.3     | 3.16    |      |
| S52-50-150 | ¥4,500 |         | 150    | 147.65  | 7.1     | 3.07    |      |
| S52-50-200 | ¥3,800 |         | 200    | 198.00  | 6.1     | 3.09    |      |
| S52-50-300 | ¥4,400 |         | 300    | 298.32  | 5.1     | 3.10    |      |

### ■共通仕様(S51、S52)

|            |                   |
|------------|-------------------|
| 材質         | BK7※              |
| 外径公差(直径)φD | +0<br>-0.1mm      |
| 中心厚公差tc    | ±0.2mm            |
| 焦点距離公差f    | ±2%               |
| 偏芯         | 3分以内              |
| 設計波長       | 587.6nm           |
| 屈折率        | 1.5168(λ=587.6nm) |

※透過率特性 ▶P.3-069 S02, S04