

C10 Series Parts & Functions

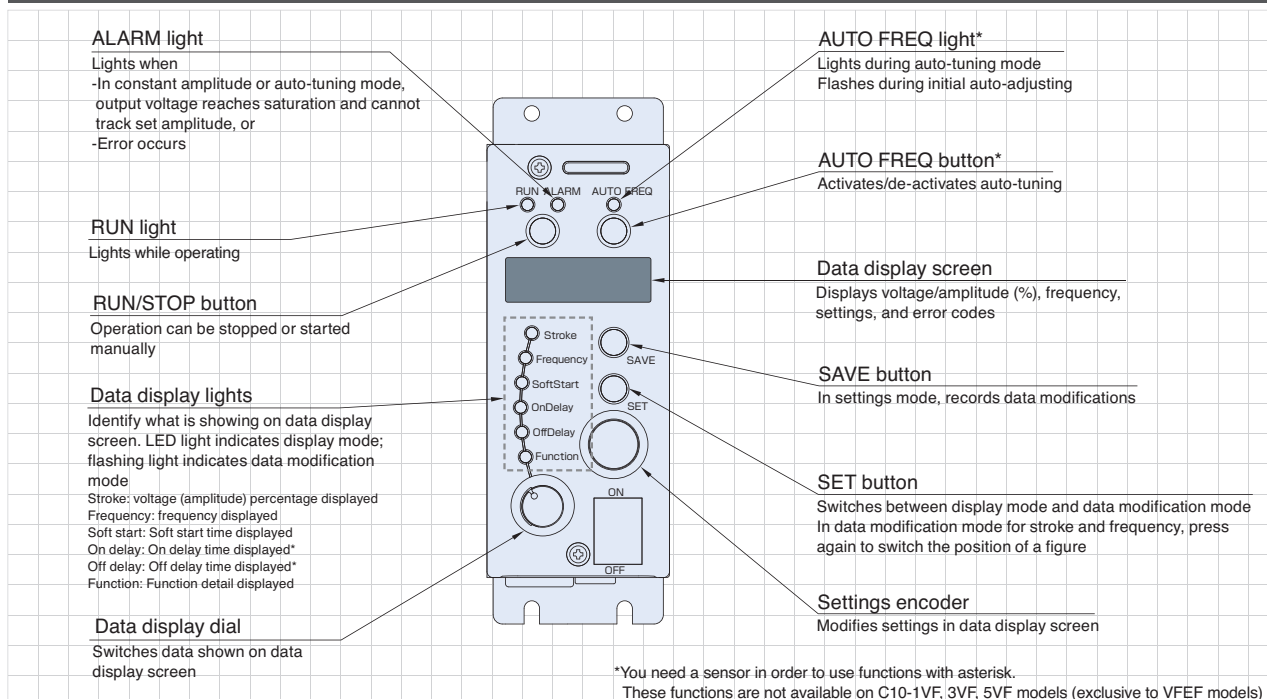

Specifications

Model	C10-5VF	C10-3VF	C10-1VF	C10-5VFEF	C10-3VFEF	C10-1VFEF	
Input power source	AC100~120V ± 10%, AC200~230V ± 10%, 50/60Hz						
Output	Control system	PWM system					
	Voltage	0~190V (for AC 200V input) 0~95V (for AC 100V input) Optional unit C10-TR allows output voltage in 0~190V range (Except C10-5VF(EF)) even with AC100V input					
	Vibration frequency	Half wave: 45~90Hz, Full wave: 90~180Hz Intermediate wave: 65~120Hz, High frequency: 180~360Hz					
	Max. current	5A	3A	1A	5A	3A	1A
	Operating modes	Constant voltage mode: Frequency, output voltage set manually Constant amplitude mode: Constant amplitude control at set frequency Auto-tuning mode: — With frequency auto-tuning, constant amplitude control requires no amplitude setting					
Additional features	Speed selector	Selection of up to 4 amplitude settings by means of external signal					
	Start/stop control	Start/Stop control by external signal					
	Output signal	Output signal synchronized to parts feeder operation					
	Soft start	Start-up time 0.2~4.0 secs					
	On/Off delay	—			Delay 0.2~60secs		
Synchronized power output	Sensor power source	— For DC 12V, max. 80mA 3P power plug					
	Function	— Power output synchronized to parts feeder operation (RUN)					
	Control system	— On/Off control					
	Output voltage	— As power source input to controller					
Others	Max. current	— 2A					
	Noise tolerant voltage	Above 1000V					
	Ambient temperature	0~40°C					
	Ambient humidity	10~90% (no condensation)					
	Weight	1.5kg	0.9kg	0.8kg	1.6kg	1.0kg	0.9kg
Compatible equipment	Case color U75-70D (Japan Paint Industry Association)						
	ER-55B,65B,75B	ER-30B,38B,45B EA-25,30,38,45 LF-30,40	ER-25B EA-15,20 LFBR-350B,450B,600B LFB-300,400,550 LFG-600,750,900 ME-08C,14C HME-08C,14 LFB-02,04 HLFB-02,04C LF-02,04 MF-04C,15C HSE-14	ER-55B,65B,75B	ER-30B,38B,45B EA-25,30,38,45 LF-30,40	ER-25B EA-15,20 LFBR-350B,450B,600B LFB-300,400,550 LFG-600,750,900 ME-08C,14C HME-08C,14 LFB-02,04 HLFB-02,04C LF-02,04 MF-04C,15C HSE-14	

Note: Specifications above are applied for later than ver.4.