

Internal Grooving

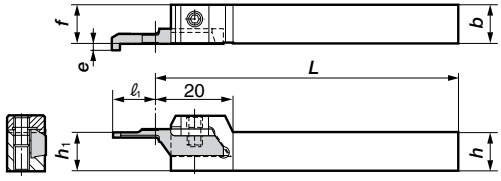
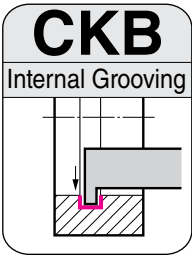

Please refer to the insert table below for dimensions of e and l_1 .

■ Holders

Cat. No.	Stock	Dimensions (mm)					Clamp	Double Screw	Spanner
		h	b	L	f	h_1			
CKB R1010-16	●	10	10	100	10	10	CKBW16	WB4-8	LH020
CKB R1212-16	●	12	12	125	12	12			
CKB R1616-16	●	16	16	125	16	16			
CKB R2020-16	●	20	20	125	20	20			
CKB R2525-16	●	25	25	150	25	25			

■ Spare Parts



■ Inserts

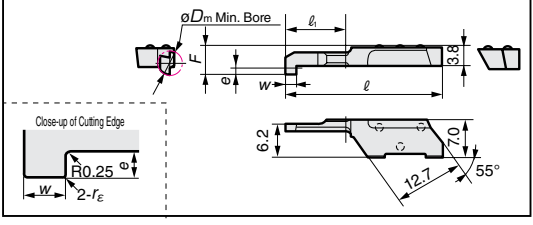

Cat. No.	Coated Carbide	Min. Bore	Grooving Width (mm)	Dimensions (mm)					
	ACZ310			ϕD_m	w	F	e	r_E	l
KBMG R0411-05	●	4.0	1.00	4.90	1.1	0.05	28.5	11	
KBMG R0411-10	●	4.0	2.00	4.90	1.1	0.10	28.5	11	
KBMG R0511-05	●	5.0	1.00	5.10	1.3	0.05	28.5	11	
KBMG R0511-10	●	5.0	2.00	5.10	1.3	0.10	28.5	11	

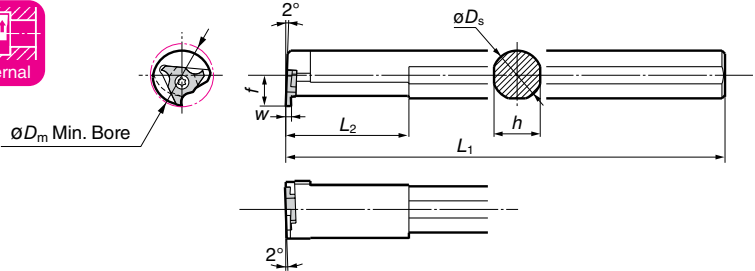
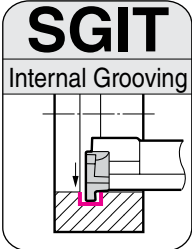

■ Spare Parts

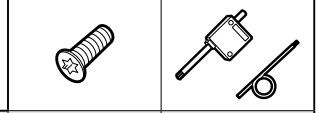

■ Holders

Cat. No.	Stock	Dimensions (mm)					Min. Bore (mm)	Grooving Width (mm)	Max. Grooving Depth (mm)	Applicable Insert	Screw	Spanner
		ϕD_s	h	L_1	f	L_2						
SGIT R08	●	8	7.0	125	5.0	20	10.0	0.50 to 2.00	0.8*	GITL3000	BFTX02506NS	RT08
SGIT R10	●	10	9.0	150	6.0	25	12.0	0.8*				
SGIT R12	●	12	11.0	180	7.0	30	14.0	1.00 to 2.00	1.8	GITL5000	BFTX0307NS	RT10
SGIT R14	●	14	13.0	180	8.0	35	16.0	1.8				
SGIT R16	●	16	15.0	200	10.0	40	20.0	1.50 to 2.00	2.8			
SGIT R20	●	20	19.0	200	12.0	40	25.0	2.8	2.8	GITL6000		

*Maximum grooving depth is 0.5mm when GITL3050 is set.

■ Inserts

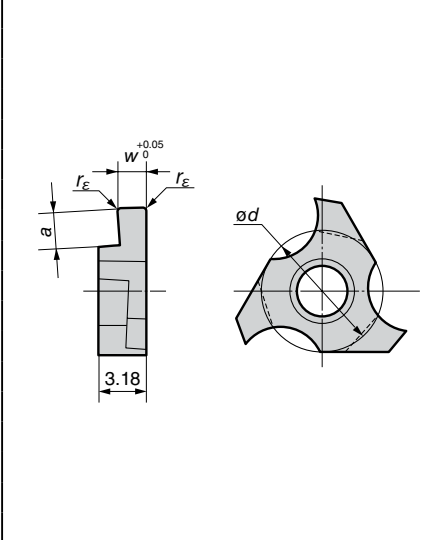

Cat. No.	Coated Carbide	Dimensions (mm)				Applicable Holder
	ACZ150	w	a	r_E	ϕd	
GIT L3050	●	0.50	1.2	0.05	5.56	SGIT R08 SGIT R10
GIT L3065	●	0.65	1.2	0.05	5.56	
GIT L3075	●	0.75	1.2	0.05	5.56	
GIT L3100	●	1.00	1.2	0.05	5.56	
GIT L3125	●	1.25	1.2	0.20	5.56	
GIT L3145	●	1.45	1.2	0.20	5.56	
GIT L3150	●	1.50	1.2	0.05	5.56	
GIT L3200	●	2.00	1.2	0.10	5.56	
GIT L5100	●	1.00	2.2	0.05	7.94	SGIT R12 SGIT R14
GIT L5145	●	1.45	2.2	0.20	7.94	
GIT L5150	●	1.50	2.2	0.05	7.94	
GIT L5175	●	1.75	2.2	0.20	7.94	
GIT L5200	●	2.00	2.2	0.10	7.94	
GIT L6150	●	1.50	3.2	0.20	9.525	SGIT R16 SGIT R20
GIT L6175	●	1.75	3.2	0.20	9.525	
GIT L6200	●	2.00	3.2	0.20	9.525	