

GNDL/GNDLS Type

External Deep Grooving & Cut-Off

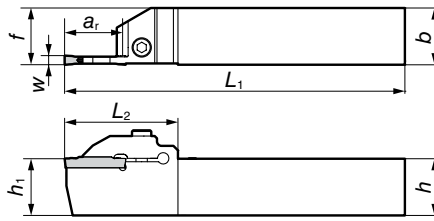
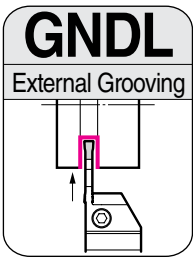

Above figures show right hand tools

■ Holders

Cat. No.	Stock		Dimensions (mm)						Grooving Width (mm)	Max. Grooving Depth (mm)	Applicable Insert	Cap Screw	Recommended Tightening Torque (N·m)	Spanner
	R	L	h	b	L ₁	f	h ₁	L ₂	w	a _r				
GNDL R/L2020K-220	●	●	20	20	125	20	20	44.5	2.0	20	GCM □2000-□□	BX0520	5.0	LH040
GNDL R/L2020K-320	●	●	20	20	125	20	20	44.5	3.0	20(18)	GCM □3000-□□			
GNDL R/L2020K-425	●	●	20	20	125	20	20	50.0	4.0	25(23)	GCM □4000-□□			
GNDL R/L2020K-525	●	●	20	20	125	20	20	50.0	5.0	25(23)	GCM N5000-□□			
GNDL R/L2020K-625	●	●	20	20	125	20	20	50.0	6.0	25(23)	GCM N6000-□□			
GNDL R/L2525M-220	●	●	25	25	150	25	25	44.5	2.0	20	GCM □2000-□□			
GNDL R/L2525M-320	●	●	25	25	150	25	25	44.5	3.0	20(18)	GCM □3000-□□			
GNDL R/L2525M-425	●	●	25	25	150	25	25	50.0	4.0	25(23)	GCM □4000-□□			
GNDL R/L2525M-525	●	●	25	25	150	25	25	50.0	5.0	25(23)	GCM N5000-□□			
GNDL R/L2525M-625	●	●	25	25	150	25	25	50.0	6.0	25(23)	GCM N6000-□□			
GNDL R/L3225P-320			32	25	170	25	32	44.5	3.0	20(18)	GCM □3000-□□	BX0620	6.0	LH050
GNDL R/L3225P-425			32	25	170	25	32	50.0	4.0	25(23)	GCM □4000-□□			
GNDL R/L3225P-525			32	25	170	25	32	50.0	5.0	25(23)	GCM N5000-□□			
GNDL R/L3225P-625			32	25	170	25	32	50.0	6.0	25(23)	GCM N6000-□□			
GNDL R/L3225P-725			32	25	170	25	32	50.0	7.0	25(23)	GCM N7000-□□			
GNDL R/L3225P-825			32	25	170	25	32	50.0	8.0	25(23)	GCM N8000-□□			
GNDL R/L3232P-320	●	●	32	32	170	32	32	44.5	3.0	20(18)	GCM □3000-□□	BX0620	6.0	LH050
GNDL R/L3232P-425	●	●	32	32	170	32	32	50.0	4.0	25(23)	GCM □4000-□□			
GNDL R/L3232P-525	●	●	32	32	170	32	32	50.0	5.0	25(23)	GCM N5000-□□			
GNDL R/L3232P-625	●	●	32	32	170	32	32	50.0	6.0	25(23)	GCM N6000-□□			
GNDL R/L3232P-725	●	●	32	32	170	32	32	50.0	7.0	25(23)	GCM N7000-□□			
GNDL R/L3232P-825	●	●	32	32	170	32	32	50.0	8.0	25(23)	GCM N8000-□□			

Select holders and inserts with the same grooving widths (w). Dimensions in parentheses under maximum grooving depth are for applications that use copying inserts (RG Type Breakers). Refer to F23 for applicable inserts.

■ Spare Parts



External L-Styled (Side Cut) Grooving

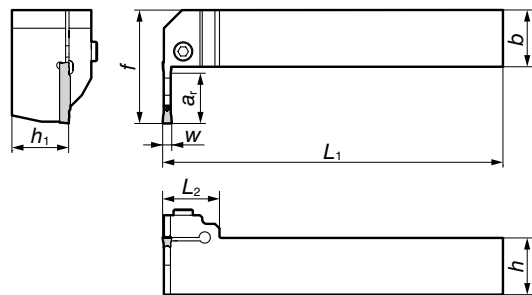
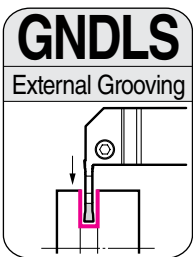

Above figures show right hand tools

■ Holders

Cat. No.	Stock		Dimensions (mm)						Grooving Width (mm)	Max. Grooving Depth (mm)	Applicable Insert	Cap Screw	Recommended Tightening Torque (N·m)	Spanner
	R	L	h	b	L ₁	f	h ₁	L ₂	w	a _r				
GNDLS R/L2020K-216	●	●	20	20	125	38	20	25	2.0	16	GCM □2000-□□	BX0520	5.0	LH040
GNDLS R/L2020K-316	●	●	20	20	125	38	20	25	3.0	16	GCM □3000-□□			
GNDLS R/L2525M-218	●	●	25	25	150	45	25	25	2.0	18	GCM □2000-□□			
GNDLS R/L2525M-318	●	●	25	25	150	45	25	25	3.0	18	GCM □3000-□□			
GNDLS R/L2525M-423	●	●	25	25	150	50	25	25	4.0	23	GCM □4000-□□			
GNDLS R/L2525M-523	●	●	25	25	150	50	25	25	5.0	23	GCM N5000-□□			
GNDLS R/L2525M-623	●	●	25	25	150	50	25	25	6.0	23	GCM N6000-□□			

Select holders and inserts with the same grooving widths (w). Refer to F23 for applicable inserts.

■ Spare Parts

