

SEC-Boring Bars S-SVZB/B-SVZB/C-SVZB Type

Internal Copying

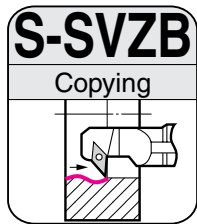

Steel

New

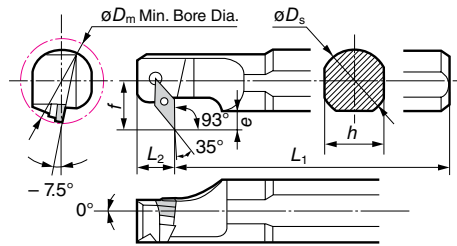

Spare Parts

Pin	Bolt	Shim	Screw	Wrench (For Torx Holes)	Screw Spanner (For Hexagonal Holes)
VC □□1103□□	—	—	BFTX02508NV	1.5	TRX08
VC □□1604□□	VP32B VP40B	BH03504 SVP32	BFTX03508	2.0	TRX10 LH020

■ Holder Right handed toolholders are applicable with **right handed** or neutral inserts.
Left handed toolholders are applicable with **left handed** or neutral inserts. Above figures show right hand tools.

Shank	Cat. No.	Stock		Dimensions (mm)						Applicable Insert	
		R	L	ϕD_m	ϕD_s	h	L_1	L_2	f		e
Steel	S20R-SVZB R/L1103-25	●	●	25	20	18	200	15	14.5	5.5	VC □□1103□□
	S25S-SVZB R/L1103-32	●	●	32	25	23	250	15	19.0	7.5	VC □□1103□□
	S25S-SVZB R/L1604-34	●	●	34	25	23	250	20	20.5	9.0	VC □□1604□□
	S32T-SVZB R/L1604-40	●	●	40	32	30	300	20	22.0	9.0	VC □□1604□□
	S40T-SVZB R/L1604-50	●	●	50	40	37	300	20	27.0	10.0	VC □□1604□□

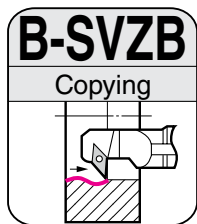

Anti-vibration

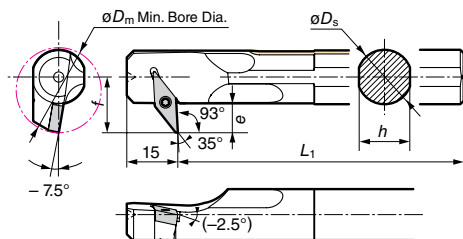

SumiTurn

Sumi Small

■ Holder Right handed toolholders are applicable with **right handed** or neutral inserts.
Left handed toolholders are applicable with **left handed** or neutral inserts. Above figures show right hand tools.

Shank	Cat. No.	Stock		Dimensions (mm)						Applicable Insert	Screw	Recommended Tightening Torque (N·m)	Wrench
		R	L	ϕD_m	ϕD_s	h	L_1	f	e				
Anti-vibration	B12M-SVZB R/L1103-20 B16R-SVZB R/L1103-25	●	●	20 25	12 16	11 15	150 200	13.5 16.5	8 9	VB □□1103□□	BFTX02508NV*	1.5	TRX08

* Changed from those in the 2013-2014 General Catalog.

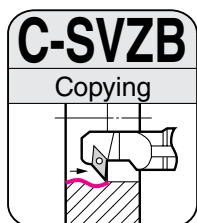

Carbide

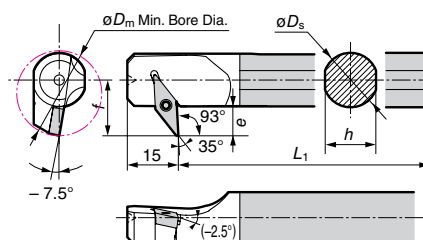

Sumi Small

■ Holder Right handed toolholders are applicable with **right handed** or neutral inserts.
Left handed toolholders are applicable with **left handed** or neutral inserts. Above figures show right hand tools.

Shank	Cat. No.	Stock		Dimensions (mm)						Applicable Insert	Screw	Recommended Tightening Torque (N·m)	Wrench
		R	L	ϕD_m	ϕD_s	h	L_1	f	e				
Carbide	C12M-SVZB R/L1103-20 C16R-SVZB R/L1103-25	●	●	20 25	12 16	11 15	150 200	13.5 16.5	8 9	VB □□1103□□	BFTX02508NV*	1.5	TRX08

* Changed from those in the 2013-2014 General Catalog.

Boring Bars