

SEC-Boring Bars S-SCLP/B-SCLP/D-SCLP Type

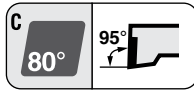

Finish-Medium Cut

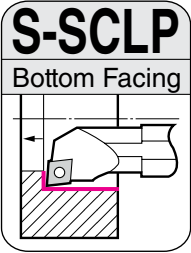

Steel

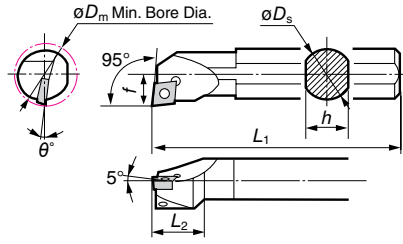

Sumi Small

■ Holder Right handed toolholders are applicable with left handed or neutral inserts.
Left handed toolholders are applicable with right handed or neutral inserts.

Above figures show right hand tools.

■ Spare Parts

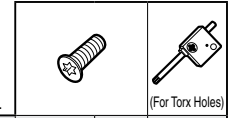

Shank	Cat. No.	Conventional Cat. No.	Stock		Dimensions (mm)							Applicable Insert	Screw	Recommended Tightening Torque (N·m)	Wrench	
			R	L	Min. Bore Dia. ϕD_m	ϕD_s	h	L_1	f	L_2	θ°					
Steel	S10K-SCLP R/L0802-12	BBPC-010 R/L	●	●	12	10	9	125	6.0	12.0	-5	CP □□0802□□	BFTX0305A	2.0	TRX10	
	S12M-SCLP R/L0802-14	BBPC-012 R/L14	●	●	14	12	11	150	7.0	10.6	-5					
	S12M-SCLP R/L0802-16	BBPC-012 R/L	▲	▲	16	12	11	150	8.0	15.0	-3					
	S12M-SCLP R/L0903-16	—	—	●	●	16	12	11	150	8.0	23.0	-6	CP □□0903□□	BFTX0407A	3.4	TRX15
	S16R-SCLP R/L0903-18	BBPC-316 R/L18	●	●	18	16	15	200	9.0	18.0	-4					
	S16R-SCLP R/L0903-20	BBPC-316 R/L	▲	▲	20	16	15	200	10.0	18.0	-3					
	S20S-SCLP R/L0903-22	BBPC-320 R/L22	●	●	22	20	18	250	11.0	18.0	-2					
	S20S-SCLP R/L0903-25	BBPC-320 R/L	▲	▲	25	20	18	250	12.5	18.0	0					
	S25T-SCLP R/L0903-27	—	—	●	●	27	25	22	300	13.5	18.0	-2				
	S25T-SCLP R/L0903-28	BBPC-325 R/L	▲	▲	28	25	22	300	14.0	35.0	-2					
S25T-SCLP R/L1204-28	BBPC-425 R/L	▲	▲	28	25	22	300	14.0	17.4	-2	CP □□1204□□	BFTX0509A	5.0	TRX20		

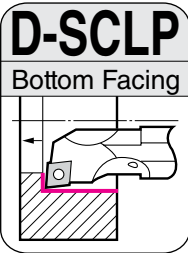
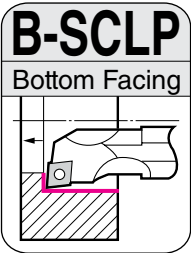

Anti-vibration

Anti-vibration with oil hole

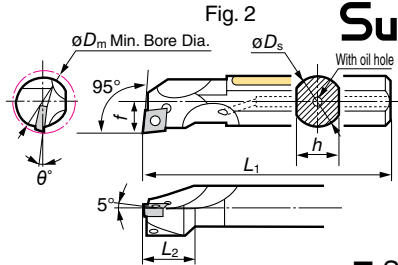
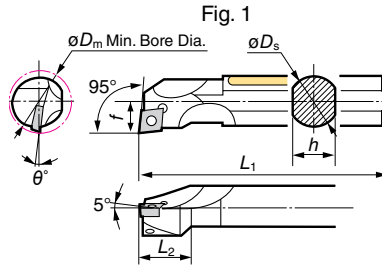

SumiTurn ^{COOL} Bar

Sumi Small

■ Holder Right handed toolholders are applicable with left handed or neutral inserts.
Left handed toolholders are applicable with right handed or neutral inserts.

Above figures show right hand tools.

■ Spare Parts

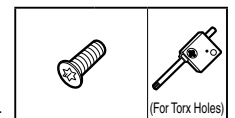

Shank	Cat. No.	Conventional Cat. No.	Stock		Dimensions (mm)							Fig.	Applicable Insert	Screw	Recommended Tightening Torque (N·m)	Wrench
			R	L	Min. Bore Dia. ϕD_m	ϕD_s	h	L_1	f	L_2	θ°					
Anti-vibration	B12M-SCLP R/L0802-14	XBPC-012 R/L14	●	●	14	12	11	150	7	10.6	-5	1	CP □□0802□□	BFTX0305A	2.0	TRX10
	B16R-SCLP R/L0903-18	XBPC-316 R/L18	●	●	18	16	15	200	9	18.0	-4	1	CP □□0903□□	BFTX0407A	3.4	TRX15
	B20S-SCLP R/L0903-22	XBPC-320 R/L22	●	●	22	20	18	250	11	18.0	-2					
Anti-vibration with oil hole	D12M-SCLP R/L0802-14	XBPC-012 R/L H14	●	●	14	12	11	150	7	10.6	-5	2	CP □□0802□□	BFTX0305A	2.0	TRX10
	D16R-SCLP R/L0903-18	XBPC-316 R/L H18	●	●	18	16	15	200	9	18.0	-4	2	CP □□0903□□	BFTX0407A	3.4	TRX15
	D20S-SCLP R/L0903-22	XBPC-320 R/L H22	●	●	22	20	18	250	11	18.0	-2					